



City of Westminster

# Licensing Sub-Committee Report

Item No:

Date:

7 December 2023

Licensing Ref No:

23/05401/LIPN - New Premises Licence

Title of Report:

9-11 Kingly Street  
London  
W1B 5PH

Report of:

Director of Public Protection and Licensing

Wards involved:

West End

Policy context:

City of Westminster Statement of Licensing Policy

Financial summary:

None

Report Author:

Ms Jessica Donovan  
Senior Licensing Officer

Contact details

Telephone: 020 7641 6500  
Email: [Jdonovan@westminster.gov.uk](mailto:Jdonovan@westminster.gov.uk)

## 1. Application

1-A Applicant and premises			
<b>Application Type:</b>	New Premises Licence, Licensing Act 2003		
<b>Application received date:</b>	15 August 2023		
<b>Applicant:</b>	Little Door & Co Limited & Shaftesbury AV Limited		
<b>Premises:</b>	N/A		
<b>Premises address:</b>	9-11 Kingly Street London W1B 5PH	<b>Ward:</b>	West End
		<b>Cumulative Impact Area:</b>	West End
		<b>Special Consideration Zone:</b>	None
<b>Premises description:</b>	The premises intends to operate as a bar.		
<b>Premises licence history:</b>	The premises has had the benefit of a premises licence since 2005. The current premises licence (22/09921/LIPT) can be viewed at <b>Appendix 3</b> of this report along with the premises licence history at <b>Appendix 4</b> .		
<b>Applicant submissions:</b>	<p>On the application form, the applicant has provided the following submissions:</p> <p>The existing premises licence (ref 22/09921/LIPT) is subject, inter alia, to conditions 20 and 21 in relation to membership and a capacity of 150. The current hours for the provision of licensable activities are 03:00 Monday to Friday, midnight Saturday and 22:30 Sunday.</p> <p>The application follows pre-application advice 22/10842/PREAPM and proposes a new premises licence to replace the existing licence ref 22/09921/LIPT, which is proposed to be surrendered.</p> <p>The new premises licence would differ from the current licence by:</p> <ol style="list-style-type: none"> <li>Reducing the hours of licensable activities on the mornings following Monday to Friday to 01:00 and increasing to 01:00 only on the morning following Saturday (with Sunday left unchanged);</li> <li>Removing conditions 10 - 12 (Rules of Management), 20 &amp; 21 (membership), and 13 -17 and 22 (various), and replacing them with a suite of modern and appropriate model conditions</li> <li>Increasing the capacity to no more than 180, with minimum seating provision for at least 90;</li> <li>Updating the layout of the premises in accordance with the enclosed plans, including changes to fixed seating and an increase in WC provision.</li> </ol> <p>Both the existing and proposed use fall within policy PB1 of the Statement of Licensing Policy. The substantial decrease in hours, together with the removal and amendment of the conditions therefore provides exceptional circumstances and promotes the licensing objectives.</p>		



	The applicant has also provided the following submissions which can be found at <b>Appendix 2</b> :  <ol style="list-style-type: none"> <li>1. Summary of proposals</li> <li>2. Little Door brand document</li> <li>3. Little Door overview</li> <li>4. Dispersal policy</li> <li>5. Leveche expert report</li> </ol>
<b>Applicant amendments:</b>	None

<b>1-B Proposed licensable activities and hours</b>							
<b>Live Music:</b>				<b>Indoors, outdoors or both</b>			<b>Indoors</b>
<b>Day:</b>	<b>Mon</b>	<b>Tues</b>	<b>Wed</b>	<b>Thur</b>	<b>Fri</b>	<b>Sat</b>	<b>Sun</b>
<b>Start:</b>	09:00	09:00	09:00	09:00	09:00	09:00	N/A
<b>End:</b>	01:00	01:00	01:00	01:00	01:00	01:00	N/A
<b>Seasonal variations/ Non-standard timings:</b>		From the end of permitted hours on New Year's Eve until the start of permitted hours on New Year's Day.					

<b>Recorded Music:</b>				<b>Indoors, outdoors or both</b>			<b>Indoors</b>
<b>Day:</b>	<b>Mon</b>	<b>Tues</b>	<b>Wed</b>	<b>Thur</b>	<b>Fri</b>	<b>Sat</b>	<b>Sun</b>
<b>Start:</b>	09:00	09:00	09:00	09:00	09:00	09:00	N/A
<b>End:</b>	01:00	01:00	01:00	01:00	01:00	01:00	N/A
<b>Seasonal variations/ Non-standard timings:</b>		From the end of permitted hours on New Year's Eve until the start of permitted hours on New Year's Day.					

<b>Performance of Dance:</b>				<b>Indoors, outdoors or both</b>			<b>Indoors</b>
<b>Day:</b>	<b>Mon</b>	<b>Tues</b>	<b>Wed</b>	<b>Thur</b>	<b>Fri</b>	<b>Sat</b>	<b>Sun</b>
<b>Start:</b>	09:00	09:00	09:00	09:00	09:00	09:00	N/A
<b>End:</b>	01:00	01:00	01:00	01:00	01:00	01:00	N/A
<b>Seasonal variations/ Non-standard timings:</b>		From the end of permitted hours on New Year's Eve until the start of permitted hours on New Year's Day.					

<b>Anything of a similar description to that falling within Live Music, Recorded Music and Performance of Dance:</b>				<b>Indoors, outdoors or both</b>			<b>Indoors</b>
<b>Day:</b>	<b>Mon</b>	<b>Tues</b>	<b>Wed</b>	<b>Thur</b>	<b>Fri</b>	<b>Sat</b>	<b>Sun</b>
<b>Start:</b>	09:00	09:00	09:00	09:00	09:00	09:00	N/A
<b>End:</b>	01:00	01:00	01:00	01:00	01:00	01:00	N/A
<b>Seasonal variations/ Non-standard timings:</b>		From the end of permitted hours on New Year's Eve until the start of permitted hours on New Year's Day.					



<b>Late Night Refreshment:</b>				<b>Indoors, outdoors or both</b>			Indoors
<b>Day:</b>	<b>Mon</b>	<b>Tues</b>	<b>Wed</b>	<b>Thur</b>	<b>Fri</b>	<b>Sat</b>	<b>Sun</b>
<b>Start:</b>	23:00	23:00	23:00	23:00	23:00	23:00	N/A
<b>End:</b>	01:00	01:00	01:00	01:00	01:00	01:00	N/A
<b>Seasonal variations/ Non-standard timings:</b>		From the end of permitted hours on New Year's Eve until the start of permitted hours on New Year's Day.					

<b>Sale by retail of alcohol</b>				<b>On or off sales or both:</b>			Both
<b>Day:</b>	<b>Mon</b>	<b>Tues</b>	<b>Wed</b>	<b>Thur</b>	<b>Fri</b>	<b>Sat</b>	<b>Sun</b>
<b>Start:</b>	10:00	10:00	10:00	10:00	10:00	10:00	12:00
<b>End:</b>	01:00	01:00	01:00	01:00	01:00	01:00	22:30
<b>Seasonal variations/ Non-standard timings:</b>		From the end of permitted hours on New Year's Eve until the start of permitted hours on New Year's Day.					

<b>Hours premises are open to the public</b>							
<b>Day:</b>	<b>Mon</b>	<b>Tues</b>	<b>Wed</b>	<b>Thur</b>	<b>Fri</b>	<b>Sat</b>	<b>Sun</b>
<b>Start:</b>	09:00	09:00	09:00	09:00	09:00	09:00	12:00
<b>End:</b>	01:30	01:30	01:30	01:30	01:30	01:30	23:00
<b>Seasonal variations/ Non-standard timings:</b>		From the end of permitted hours on New Year's Eve until the start of permitted hours on New Year's Day.					

## 2. Representations

<b>2-A Responsible Authorities</b>	
<b>Responsible Authority:</b>	The Licensing Authority
<b>Representative:</b>	Kevin Jackaman
<b>Received:</b>	27 September 2023
<p>I write in relation to the application submitted for a variation of the premises licence for 9 Kingly Street, London, W1B 5PH</p> <p>As a responsible authority under section 13 (4) of the Licensing Act 2003 as amended under the Police and Social Responsibility Act 2011, the Licensing Authority have considered your application in full. The Licensing Authority has concerns in relation to this application and how the premises would promote the four Licensing Objectives:</p> <ul style="list-style-type: none"> <li>• Public Nuisance</li> <li>• Prevention of Crime &amp; Disorder</li> <li>• Public Safety</li> <li>• Protection of children from harm</li> </ul> <p>The application seeks the following:</p> <ul style="list-style-type: none"> <li>• <b>Live music, recorded music, performance of dance and anything of a similar description</b> Monday to Saturday 09:00 to 01:00</li> </ul>	



Non-Standard Timings: From the end of permitted hours on New Year's Eve until the start of permitted hours on New Year's Day

- Late Night Refreshment  
Monday to Saturday 23:00 to 01:00

Non-Standard Timings: From the end of permitted hours on New Year's Eve until the start of permitted hours on New Year's Day

- Supply of Alcohol On and Off the Premises  
Monday to Saturday 10:00 to 01:00  
Sunday 12:00 to 22:30

Non-Standard Timings: From the end of permitted hours on New Year's Eve until the start of permitted hours on New Year's Day

- **Opening Hours to Public**  
Monday to Saturday 09:00 to 01:30  
Sunday 12:00 to 23:00

Non-Standard Timings: From the end of permitted hours on New Year's Eve until the start of permitted hours on New Year's Day

The premises is located within the West End Cumulative Impact Zone and as such various policy points must be considered namely PB1, CIP1 and HRS1.

The Licensing Authority has thoroughly assessed this application and have noted that the premises intend to trade as a "Bar". Therefore, the application must be assessed under Westminster's PB1 Policy.

Westminster's PB1(B) Policy states: "It is the Licensing Authority's policy to **refuse applications** within the West End Cumulative Impact Zone other than:

1. Applications to vary the existing licence hours within the council's Core Hours Policy HRS1.
2. Applications that seek to vary the existing licence so as to reduce the overall capacity of the premises."

Policy CIP1 states: "A. It is the Licensing Authority's policy to refuse applications within the West End Cumulative Impact Zone for: pubs and bars, fast food premises, and music and dancing and similar entertainment, other than applications to:

1. Vary the hours within Core Hours under Policy HRS1, and/or
2. Vary the licence to reduce the overall capacity of the premises"

It is noted that there is an existing premises licence in respect of the premises (Licence number 22/09921/LIPT) and the applicant is proposing that this would be surrendered in the event that this application is granted. It is also noted that the current application would reduce the hours at the premises from 03:00 to 01:00 Monday to Friday however would increase the hours on a Saturday from 00:00 to 01:00. The proposed hours are in excess of Westminster's core hours for Pubs and Bars and therefore contrary to policy.

The Core hours for music and dance venues are:

Monday to Thursday: 10am to 11.30pm.

Friday and Saturday: 10am to Midnight.

Sunday: Midday to 10.30pm.

Sundays immediately prior to a bank holiday: Midday to Midnight.

It is noted that the capacity at the premises will increase from 150 to 180 which will result in an additional 30 people within the cumulative impact zone.

It is also noted that the applicant is removing the condition requiring alcohol is only supplied to members and their bona fide guests, opening the premises to general members of the public. It

is also noted that the applicant is seeking to remove the condition requiring that the supply of alcohol after 23:00 shall only be to those persons seated at a table, increasing the potential for a large number of vertical drinkers. Given the location of the premises, the removal of these conditions is a concern to the Licensing Authority.

Given that the hours applied for are in excess of core hours, the Licensing Authority require the applicant to provide submissions as to how the operation of the premises will not add to cumulative impact in the West End cumulative impact zone, in accordance with policy CIP1.

The Licensing Authority looks forward to receiving further submissions from the applicant in due course.

Please accept this as a formal representation.

<b>Responsible Authority:</b>	Environmental Health Service
-------------------------------	------------------------------

<b>Representative:</b>	Maxwell Koduah
------------------------	----------------

<b>Received:</b>	05 September 2023
------------------	-------------------

I refer to the application for a new Premises Licence number for the above-mentioned premises. The premises is located within the West End Cumulative Impact Area. I have considered the information that you have provided within and accompanying this application. I have also considered the application in line with the relevant policies within the Councils Statement of Licensing Policy dated October 2021.

The applicant is seeking the following licensable activities:

1. Performance of live music indoors at the following times
  - Monday – Saturday 09:00 – 01:00 hours
  - From the end of permitted hours on New Year's Eve until the start of permitted hours on New Year's Day
2. Playing of recorded music indoors at the following times
  - Monday – Saturday 09:00 – 01:00 hours
  - From the end of permitted hours on New Year's Eve until the start of permitted hours on New Year's Day
3. Performance of dance indoors at the following times
  - Monday – Saturday 09:00 – 01:00 hours
  - From the end of permitted hours on New Year's Eve until the start of permitted hours on New Year's Day
4. Provision of regulated entertainment indoors at the following times
  - Monday – Saturday 09:00 – 01:00 hours
  - From the end of permitted hours on New Year's Eve until the start of permitted hours on New Year's Day
5. Provision of late-night refreshment indoors at the following times
  - Monday – Saturday 23:00 – 01:00 hours
  - From the end of permitted hours on New Year's Eve until the start of permitted hours on New Year's Day
6. Supply of alcohol for consumption on & off the premises at the following times
  - Monday – Saturday 10:00 – 01:00 hours
  - Sunday 12:00 – 22:30 hours
  - From the end of permitted hours on New Year's Eve until the start of permitted hours on New



**Following consideration of the application and how it may affect the Licensing Objectives and meeting the requirements of the Council's Statement of Licensing Policy I wish to make the following representations:**

1. The hours requested to perform live music may have the likely effect of causing an increase in Public Nuisance within the Cumulative Impact area
2. The hours play recorded music may have the likely effect of causing an increase in Public Nuisance within the Cumulative Impact area
3. The hours requested to perform dance may have the likely effect of causing an increase in Public Nuisance within the Cumulative Impact area
4. The hours requested to provide regulated entertainment may have the likely effect of causing an increase in Public Nuisance within the Cumulative Impact area
5. The hours requested to provide late-night refreshment may have the likely effect of causing an increase in Public Nuisance and may affect Public Safety within the Cumulative Impact area
6. The supply of alcohol and the hours requested may have the likely effect of causing an increase in Public Nuisance and may affect Public Safety within the Cumulative Impact area.

As presented, the application would have the likely effect of causing an increase in Public Nuisance and may affect Public Safety within the Cumulative Impact area.

The granting of the application as presented would have the likely effect of causing an increase in Public Nuisance and may impact on Public Safety within the area.

Please contact me if you have any questions regarding the above.

<b>Responsible Authority:</b>	Metropolitan Police Service
<b>Representative:</b>	Andy Elliott
<b>Received:</b>	29 September 2023

### **The Application**

1. To remove conditions 10 - 12 (Rules of Management), 20 & 21 (membership), and 13 -17 and 22 (various), and replace them with a suite of modern and appropriate model conditions.
2. To increase the capacity to 220 (From 150).
3. To increase the permitted hours on Saturdays to 01:00 and add licensable activities on Sundays until 23:00; and
4. To update the layout of the premises in accordance with the enclosed plans, including changes to fixed seating, increase in WC provision and addition of secondary means of escape.
5. Should the application as above be granted in accordance with this Operating Schedule and Part A, the hours of licensable activities on a Monday to Friday would be reduced to 01:00.

### **The Representation**

1. The Premises are located both within the West End Ward and West End CIZ. There is a policy presumption to refuse the application unless the Personal Licence Holder can demonstrate an exception to policy. As a Responsible Authority The Metropolitan Police Service believes that this application although amended from the recent Application [23/01201/LIPV] and final ruling of this sub committee 11/05/2023 will still fail to promote

the Licensable Objective of Preventing Crime & Disorder and increase cumulative impact in the West End Cumulative Impact Zone.

2. While as a responsible Authority the Metropolitan Police Service acknowledges the reduction in capacity asked for in this Application down from 220 patrons [23/01201/LIPV] to 180 patrons an increase in capacity of 46.67% of which a minimum of 90 patrons propose to be seated this still implies 90 patrons and upwards would be vertically drinking. Dependent on the nature of the seating which has been described as fixed it is unclear from this Application whether the licensable area equally has removable seating that can reorganised on an ad hoc basis.
3. As a Responsible Authority the Metropolitan Police Service has concerns over the removal of Condition 22 from Current Licence 22/09921/LIPT namely 'After 23:00 hours, the Supply of Alcohol at the premises shall only be to a person at a table'. This suggests the vertical drinking nature of the operation and historically patrons who are seated have far less propensity to become involved in Crime and Disorder than their vertically drinking counterparts.
4. As a Responsible Authority the Metropolitan Police Service while acknowledging that the reduction in hours offered may mitigate an element of risk the crime figures for Friday and Saturday nights are historically high. Equally with nearby competitors operating until 03:00 am organised street gangs intent on committing alcohol related assaults, sexual assaults and high value watch robberies will potentially be drawn to the premises earlier bolstered by additional capacity risking egressing patrons becoming the victims of crime the highest incidence of which being between 00:00 hours through till 04:00 hours Friday to Saturday .
5. Finally as a Responsible Body the Metropolitan Police Service being guided by Public Houses Bar Policy (PB1) believes that this is instrumental operationally in reducing significant levels of crime, disorder, and anti-social behaviour within the West End Ward & West End CIZ and do not believe that this Application provides sufficient mitigation in support of the Licensable Objectives namely the Prevention of Crime & Disorder irrespective of this incremental increase in capacity which contributes to a much larger policing landscape.

Stated within Public Houses and Bar Policy (PB1) Section F96 states: "The Licensing Authority does not consider a case to be exceptional because the capacity of the premises, or any proposed increase in capacity is small. The high number of premises within the West End Cumulative Impact Zone means that a small increase in capacity in each premises would lead to a significant increase overall within that area. It has been commonly argued that customers will be drawn from other premises and there will be no increase in people within the area. The experience of the Licensing Authority is that this is not the case. The massive increase in capacities in the past and, the continuing number of further applications and the observable night-time occupancy levels of premises serve to discredit the argument. Each incremental increase in capacity contributes in part to increasing the attraction of the area as a "honey pot" destination for night-life and to the cumulative problems created by such a high concentration of activity in the area".



<b>2-B Other Persons</b>			
<b>Name:</b>		[REDACTED]	
<b>Address and/or Residents Association:</b>		[REDACTED] [REDACTED] [REDACTED] [REDACTED]	
<b>Status:</b>	Valid	<b>In support or opposed:</b>	In support
<b>Received:</b>	26 September 2023		
<p>I have been to several venues run by the Little Door &amp; Co corporation, including their new venue on Greek Street. I can honestly say I have not had a better experience in London. From the venues themselves, to the staff, to their food and drink options, everything is provided with the highest quality. I can not support and recommend them enough. A brand new venue run by Little Door &amp; Co on Kingly Street will add further class and prestige to an area known for their high-end bars and clubs. All I can say is, thank you Little Door &amp; Co for the excellent service you provide.</p>			
<b>Name:</b>		[REDACTED]	
<b>Address and/or Residents Association:</b>		[REDACTED] [REDACTED] [REDACTED]	
<b>Status:</b>	Valid	<b>In support or opposed:</b>	In support
<b>Received:</b>	22 September 2023		
<p>I have known their other venues, including the Little Scarlet Door on Greek Street, for many years and they have a unique vibe which will be perfect for the area. It is a good place to go for a calm drink and something to eat where I have never experienced any trouble. My girlfriend often goes with her friends and always feels safe at Little Doors - the staff and the crowd are great, and the atmosphere is really relaxed with lots of seats. Little Door is a place I can go alone, or take my friends, or a date - and always feel safe and welcome. They always attract a friendly crowd. Being able to go for a drink or have a bite to eat in the same place, without having to travel around to different venues, is really great.</p>			
<b>Name:</b>		[REDACTED]	
<b>Address and/or Residents Association:</b>		[REDACTED] [REDACTED] [REDACTED] [REDACTED]	
<b>Status:</b>	Valid	<b>In support or opposed:</b>	In support
<b>Received:</b>	22 September 2023		
<p>I am a huge fan of the Little Door venues; I think I have visited them all over the years. I suspect their success comes down to being not just another bar/ restaurant with a bit of dancing but a warm, friendly conversational place, where people introduce themselves, chat away and enjoy the homely atmosphere.</p> <p>[REDACTED] but being in Mayfair the restaurants / bars and places to dance are very upmarket / flash and the clientele are not always warm and open to chat to others outside their immediate group. It is therefore often off-putting to good eggs and well rounded folk.</p> <p>The Little door venues have high standards but it's a welcoming, relaxed, safe place. You can easily while away an evening with friends, meet new people or just pop in for a quick drink. It's</p>			



not rowdy or over the top and it's a place of respect. It's exactly what I am keen to encourage and I would urge Westminster to support this licensing application - you won't be disappointed, as I believe the management of the Little Doors will do their utmost to promote the licensing objectives and I truly believe it will be an asset to the neighbourhood.

<b>Name:</b>		[REDACTED]	
<b>Address and/or Residents Association</b>		[REDACTED]	
<b>Status:</b>	Valid	<b>In support or opposed:</b>	In support
<b>Received:</b>	27 September 2023		

[REDACTED] write to pledge my support for the licensing application of Little Door Co at 9-11 Kingly Street.

The other venues in the group (Orange, Blue and Scarlet which is in Soho) are brilliant restaurants which add to their respective areas. It will be perfect for the Kingly area. Little Door venues are always my first choice when I want a relaxed, chilled evening with likeminded people who won't cause any trouble. Without doubt, you find a friendly, easy-going crowd at each of their venues. My girlfriend loves going to Scarlet Door in particular, with friends of hers - she says she always feels at ease and knows she won't have any unwanted attention from men. Being able to enjoy great cocktails as well as great food in one venue is exactly what so many of us look for when planning evenings in Soho.

Having been to Little Door's other venues, I am confident that they will follow the licensing objectives, as well as attract the right sort of crowd for Kingly. It would be wonderful for this disused building to be brought back to life. We should all be supporting businesses such as Little Door, who focus on well-managed venues and ensuring there is a brilliant, friendly crowd filling their sites.

Granting this application is a wonderful way to support businesses which operate in the right, proper way.

<b>Name:</b>		[REDACTED]	
<b>Address and/or Residents Association:</b>		[REDACTED]	
<b>Status:</b>	Valid	<b>In support or opposed:</b>	In support
<b>Received:</b>	22 September 2023		

I strongly support granting a license to The Little Door, a small bar and restaurant, on Kingly Street. The Little Door group has consistently demonstrated their exceptional operational skills and a deep commitment to the local community. Their reputation for responsible management and community involvement makes them an ideal candidate for this area.

Having personally experienced the quality of their establishments at their other branches, I can vouch for their commitment to excellence. Their presence on Kingly Street would undoubtedly be a seamless and beneficial addition, aligning perfectly with the neighbourhood's character and enhancing the area's appeal.



<b>Name:</b>	[REDACTED]		
<b>Address and/or Residents Association</b>	[REDACTED] [REDACTED] [REDACTED]		
<b>Status:</b>	Valid	<b>In support of opposed:</b>	In support
<b>Received:</b>	22 September 2023		
<p>I know their other venues, including the Little Scarlet Door on Greek Street, and they have a unique vibe and a really welcoming atmosphere which will be perfect for the area. It has a lounge vibe with lots of seats and a laid-back atmosphere. And Little Door is a place I can go alone, or take my friends, or a date - and always feel safe and welcome. They always attract a friendly crowd.</p>			
<b>Name:</b>	[REDACTED]		
<b>Address and/or Residents Association</b>	[REDACTED] [REDACTED] [REDACTED] [REDACTED] [REDACTED]		
<b>Status:</b>	Valid	<b>In support or opposed:</b>	In support
<b>Received:</b>	25 September 2023		
<p>Throughout the years I have celebrated my (and my friends') birthdays, promotions, and various life events at the Doors, starting from the very first one - The Little Yellow Door pop-up in Notting Hill Gate and at all other Doors.</p> <p>Despite the ever-growing number of bars in London, very few are here to stay. The Doors network, on the other hand, is only growing. It is not because of luck, but because of all the hard work that is being put into the venues by the management daily - from unique and exciting interior design, skilled, helpful and welcoming staff, delicious cocktails and food to a safe environment, relaxed ambience and friendly like-minded crowd.</p> <p>I also appreciate the fact that I don't need to book numerous places for a night out and run across London from one place to another, because at the Doors I can enjoy excellent dinner and drinks, have a little dance if I want to or just chill with friends.</p> <p>In my opinion, Central London is lacking good quality, beautifully designed, laid-back bars that are not pretentious or rowdy. Therefore, I was very glad when the Little Scarlett Door was opened in Soho. It brought special vibes and good crowd to the area. As all other Doors did in their respective areas.</p> <p>All their venues are clearly run professionally, I have never seen any issues or problems. Another very important point to mention, especially nowadays, is that all the Doors offer a safe environment for the female clients. My girlfriends and I always felt safe and looked after by the staff and never had any unwanted attention from the fellow customers.</p> <p>I have no doubt a new Door will achieve all their licensing objectives and be an excellent addition to the existing bar scene, bringing in unique atmosphere and cool clientele.</p>			



<b>Name:</b>		[REDACTED]	
<b>Address and/or Residents Association:</b>		[REDACTED] [REDACTED] [REDACTED]	
<b>Status:</b>	Valid	<b>In support or opposed:</b>	In support
<b>Received:</b>	22 September 2023		
[REDACTED] it is good to see investment in and expansion of our night time economy. Access to well run venues is important and good for patrons as well as the borough as a whole.			
<b>Name:</b>		[REDACTED]	
<b>Address and/or Residents Association</b>		[REDACTED] [REDACTED] [REDACTED] [REDACTED]	
<b>Status:</b>	Valid	<b>In support of opposed:</b>	In support
<b>Received:</b>	28 September 2023		
I have visited The little Scarlet door on Greek Street and love the atmosphere, we have spent quite a few evenings through summer just sitting watching the world go by. [REDACTED] and felt safe and comfortable also welcome which also makes a huge difference, another Scarlet door would be a welcome addition to the area (I think). we need more safe and comfortable venues in Soho where you can go and enjoy a drink and food with friends			
<b>Name:</b>		[REDACTED]	
<b>Address and/or Residents Association</b>		[REDACTED] [REDACTED] [REDACTED] [REDACTED]	
<b>Status:</b>	Valid	<b>In support or opposed:</b>	In support
<b>Received:</b>	02 October 2023		
Representation in support of premises licence application for 9-11 Kingly Street (reference 23/05401/LIPN).			
<b>Name:</b>		[REDACTED]	
<b>Address and/or Residents Association:</b>		[REDACTED] [REDACTED] [REDACTED] [REDACTED]	
<b>Status:</b>	Valid	<b>In support or opposed:</b>	In support
<b>Received:</b>	28 September 2023		
I've been to other Little Door venues, and I love them. They're an asset to their neighborhoods, and it would be great to have another one [REDACTED]! They are such relaxed, comfortable, happy places. I've never seen any rowdiness at a Little Door, or even any uncontained loud noise - in contrast to some of the existing bars on Kingly Street! They're just great places to go for a casual drink and chat with friends, and the staff are lovely too. I am in full support of this application.			



<b>Name:</b>	[REDACTED]		
<b>Address and/or Residents Association</b>	[REDACTED] [REDACTED] [REDACTED]		
<b>Status:</b>	Valid	<b>In support of opposed:</b>	In support
<b>Received:</b>	28 September 2023		

[REDACTED] I was excited to hear about the application for the Little Doors to open a new venue in Soho. Having spent time in all of them over the years, I hope my experience may help in your assessment.

Now in my mid-thirties, I increasingly value the welcoming and relaxed atmosphere the Little Doors provide. It's difficult to find somewhere you can spend your whole evening surrounded by people who want everyone to have a good time. Something that feels quite different from places that cater to a younger crowd.

Later on in the evening, it's rare to find somewhere that doesn't feel crowded, even on the dance floor. I believe this significantly contributes to the creation of a friendly atmosphere, where people are naturally looking out for each other.

Moreover, the staff have consistently gone out of their way to help, whether it's just getting a glass of water or looking for a lost phone for someone.

I firmly believe the addition of another Little Door would make our neighbourhood a more enjoyable place to live.

<b>Name:</b>	[REDACTED]		
<b>Address and/or Residents Association</b>	[REDACTED] [REDACTED] [REDACTED] [REDACTED]		
<b>Status:</b>	Valid	<b>In support or opposed:</b>	In support
<b>Received:</b>	28 September 2023		

[REDACTED] & I hold no objections to this application. In fact I quite welcome the uniqueness of this type of project in the area.

<b>Name:</b>	[REDACTED]		
<b>Address and/or Residents Association:</b>	[REDACTED] [REDACTED] [REDACTED]		
<b>Status:</b>	Valid	<b>In support or opposed:</b>	In support
<b>Received:</b>	02 October 2023		

I know their other venues, including the Little Scarlet Door on Greek Street, and they have a unique vibe and a really welcoming atmosphere which will be perfect for the area.

- I am confident Little Door will promote the licensing objectives.

It is not the kind of venue or crowd that will add to public nuisance or disorder, like some other venues in Soho do.

- I think it would be great for Little Door to bring their concept to Kingly Street, and bring this disused building back to life.

- They will really add to the character of the area.

- It is the kind of venue that will make Soho a better place to live in and to visit. I'm sure it will be well managed and attract a friendly crowd.



- Venues like this attract a better balance of people out at night, who behave responsibly and do not drink too much.
- I think adding another Little Door venue will help make Soho safer and more welcoming. We should be supporting businesses like this.
- Businesses should be given some flexibility to operate in a way that works for them, to be financially viable and provide a good service for the area.
- Blocking new applications from good operators like this will just deter new investment, and ensure that nothing changes for the better. Granting this application will promote the licensing objectives.

<b>Name:</b>		[REDACTED]	
<b>Address and/or Residents Association</b>		[REDACTED] [REDACTED] [REDACTED]	
<b>Status:</b>	Valid	<b>In support or opposed:</b>	In support
<b>Received:</b>	28 September 2023		

[REDACTED] and would very much be in support of Little Door opening for the following reasons:

- 1) I have visited their other venues, including the Little Scarlet Door on Greek Street and believe this would be another welcome addition to the Westminster area. I think it would be great for Little Door to bring their concept to Kingly Street, and bring this disused building back to life, adding more character of the area.
- 2) As a woman, I have always felt safe at Little Door venues and found the atmosphere to be very welcoming and relaxed. People have always behaved responsibly and is always a venue I recommend to friends.
- 3) Venue attracts a friendly crowd and is certainly not the type of institution that will add to public nuisance or disorder, like some other venues in Soho do. We should be supporting more businesses like this.

Overall, another Little Door venue opening would be a real asset to the local area. I just hope they open another one closer to [REDACTED] next time.

<b>Name:</b>		[REDACTED]	
<b>Address and/or Residents Association:</b>		[REDACTED] [REDACTED] [REDACTED]	
<b>Status:</b>	Valid	<b>In support or opposed:</b>	In support
<b>Received:</b>	27 September 2023		

I have witnessed the operation. Of Little Door venues for many years. I have visited more than one of their venues in the past few years. It has always been a pleasant, respectful experience with all the staff and patrons. I believe they run respectful businesses and would not hesitate to support more venues.



<b>Name:</b>	[REDACTED]		
<b>Address and/or Residents Association</b>	[REDACTED] [REDACTED] [REDACTED]		
<b>Status:</b>	Valid	<b>In support of opposed:</b>	In support
<b>Received:</b>	27 September 2023		

The little doors add a wonderful warm feeling to every location that I've been to. I feel like I can go there safely alone, and as a woman that is quite rare. The staff at all the venues are especially kind. The concept reminds me of a sort of a non exclusive clubhouse that anyone is welcome to. The fact that they are started by two young friends is so unusual these days in a city bombarded with international chains of cold and lackluster venues. Let's keep London alive by letting these sorts of projects flourish.

<b>Name:</b>	[REDACTED]		
<b>Address and/or Residents Association</b>	[REDACTED] [REDACTED] [REDACTED]		
<b>Status:</b>	Valid	<b>In support or opposed:</b>	In support
<b>Received:</b>	29 September 2023		

[REDACTED]  
[REDACTED] I can vouch for their commitment to promoting the licensing objectives and ensuring their relationship with their community is paramount. In order to become successful they understand the need to keep the local residents on side and have always made every effort to keep the peace and spirit of the community as it should be. There are never any issues at any of their premises and I have always felt their ethos is a welcome change to the usual themed bars. A quiet, at home experience gives many the opportunity to avoid rowdy crowds and the little door company excel at this experience. I have found as [REDACTED] a patron to their establishments, they are always respectful to the laws and the conditions of their licenses. I am happy to go midweek or on weekends knowing the atmosphere will always be relaxing and enjoyable. Kingly Street will certainly benefit from their presence, as will the rest of Soho. Sometimes it is nice to temper the extravagant with a little calm.

<b>Name:</b>	[REDACTED]		
<b>Address and/or Residents Association:</b>	[REDACTED] [REDACTED] [REDACTED] [REDACTED]		
<b>Status:</b>	Valid	<b>In support or opposed:</b>	In support
<b>Received:</b>	27 September 2023		

I am writing in support of license application 23/05401/LIPN for 9-11 Kingly Street.

[REDACTED]  
[REDACTED]

[REDACTED] I in part survived by making my living working as a member of staff at a (now deceased) bar on Kingly street. The lessons I learnt during that time did much to set me up for life today and as such I am always grateful for the break London's nighttime economy gave me.

My friends drew my attention to the application by Little Door to bring back to life a disused



building on Kingly street. This concept sounds unique, and perfect for the area, which whilst full of clubs and pubs lacks something that is more of a chilled late night bar vibe (something very easy to find in every other major European capital and which attracts a quieter, no fuss type of customer base) which is something I would really like to see in London.

Businesses should be given some flexibility to operate in a way that works for them, to be financially viable and provide a good service for the area. One of my biggest worries as a resident is that having chosen to live in central London for the buzz, the fun and the chance to be social, we are increasingly living in a world that treats central London like a Cotswolds village, which does not suit the majority of residents, our desire to pull workers back to central London or indeed our status as a major tourist attraction.

Blocking new applications from good operators like this will just deter new investment, and ensure that nothing changes for the better. Granting this application will promote the licensing objectives.

Thank you for taking the time to consider my thoughts and I sincerely hope that the feedback is useful.

<b>Name:</b>	[REDACTED]		
<b>Address and/or Residents Association</b>	[REDACTED] [REDACTED] [REDACTED]		
<b>Status:</b>	Valid	<b>In support of opposed:</b>	In support
<b>Received:</b>	26 September 2023		

I am writing in support of premises licence application for 9-11 Kingly Street (reference 23/05401/LIPN).

Having been to all four of the venues, including the Little Scarlet Door on Greek Street, I can attest to their relaxing, safe and homely atmosphere.

They have always stuck me as venues where I can go with friends and not have to worry about rowdy groups or drunk people causing a scene. The Little Scarlet Door has even been a place that my mother and her friends have been wanting to try (all in their 50's).

Being able to have food and drinks out in central London, at somewhere that feels like a home, is a really unique proposition and something I believe there should be more of! They are the kind of places that attract a better balance of people out at night, unlike other venues in Soho, and genuinely make Soho a nicer place to go out. We should absolutely be supporting businesses like this!

Blocking new applications from good operators like this will just deter new investment, and ensure that nothing changes for the better. Granting this application will promote the licensing objectives.

<b>Name:</b>	[REDACTED]		
<b>Address and/or Residents Association</b>	[REDACTED] [REDACTED] [REDACTED]		
<b>Status:</b>	Valid	<b>In support or opposed:</b>	In support
<b>Received:</b>	27 September 2023		

Representation in support of premises licence application for 9-11 Kingly Street (reference 23/05401/LIPN)

I want to express my support for this application. I know the other venues that are run by the



Little Door & Co, and I have held brilliant events with them. They have a very special quality to them. The clientele is respectful and relaxed, and the management are impeccably professional.

I'm very excited to try this new Kingly Street venture. It's exactly what Westminster needs - a buzzy, successful, and well-run venue which will add to the fabric of the area.

Standing in the way of great companies like Little Door & Co doesn't promote licensing objectives. It pushes growth, investment, and business away from Soho - and gives space for the wrong sort of operators to move in and cause trouble.

<b>Name:</b>	[REDACTED]		
<b>Address and/or Residents Association:</b>	[REDACTED] [REDACTED] [REDACTED]		
<b>Status:</b>	Valid	<b>In support or opposed:</b>	In support
<b>Received:</b>	27 September 2023		

I want to offer my full support for the new Little Door venue on Kingly Street [REDACTED] [REDACTED] as a fan of their venues. I've also know the team behind them for a long time and find that they have been wonderful hosts and very professional operators.

Their venues always have a great and well behaved crowd, with a friendly and laid back vibe which is so hard to find. I think this would be a welcome new type of venue for the area and something which is in short supply. I give them my full support and look forward to the new venue.

<b>Name:</b>	[REDACTED]		
<b>Address and/or Residents Association</b>	[REDACTED] [REDACTED] [REDACTED] [REDACTED]		
<b>Status:</b>	Valid	<b>In support of opposed:</b>	In support
<b>Received:</b>	22 September 2023		

[REDACTED] the Scarlet door for the pass two years, I can't praise the venue enough, from the staff to the food and drinks. It's a great spot for all occasions and one of our favourite local independent bars, there needs to be more of these venues in sea of soulless chains. It brings character and a great vibe to the area. APPROVE!!!

<b>Name:</b>	[REDACTED]		
<b>Address and/or Residents Association</b>	[REDACTED] [REDACTED] [REDACTED]		
<b>Status:</b>	Valid	<b>In support or opposed:</b>	In support
<b>Received:</b>	26 September 2023		

I am writing to you in regards to the premises concerning the Little Doors brand. There seems to be an objection to their new venue by [REDACTED] who are concerned of their respectable space turning boisterous and more so rambunctious with this new addition. However I can guarantee you that these venues are anything but of this sort. Little Scarlett Door which is a relatively new venue that has opened on Greek street still remains perhaps the most docile and polished venue in the surrounding area. If anything these venue have brought a more sophisticated and different vibe to soho than any venue that has previously been there.

Moreover the crowds that frequent the Little Door brands are a different sort of people who are



merely there to enjoy their time out with their friends and colleagues rather than be involved in any sort of malicious actions. I urge you to grant their license as if anything this venue has the fortitude to perhaps even clean up the sometimes gritty soho atmosphere. These venues have never attracted the trouble making demographic nor have they ever had any negative sort of negative feedback from the public. It is also not a noisy affair; they have a laid back atmosphere with cocktails and a lots of seating for their patrons.

Me and everyone I know have always felt more than safe at their venues. The Little Doors are venues that I can go alone, with my close family and take dates as I have never felt safer and more off guard at any other London venue. I firmly believe that this venue will add another flavor of culture and perhaps even gentrify the sometimes volatile Soho environment. I thank you for taking the time to read through and consider my words.

<b>Name:</b>	[REDACTED]		
<b>Address and/or Residents Association:</b>	[REDACTED] [REDACTED] [REDACTED]		
<b>Status:</b>	Valid	<b>In support or opposed:</b>	In support
<b>Received:</b>	28 September 2023		

The establishment being proposed would attract some good people to the area. I've attended one of their chains and it is not rowdy but a rather classier affair. Fully support.

<b>Name:</b>	[REDACTED]		
<b>Address and/or Residents Association</b>			
<b>Status:</b>	Valid	<b>In support of opposed:</b>	Opposed
<b>Received:</b>	01 October 2023		

Having experienced the welcoming atmosphere at Little Scarlet Door on Greek Street, I can personally attest to the unique vibe and safe environment their venues provide. It's crucial to have such places in Soho, where people can relax and enjoy their evenings without concerns.

<b>Name:</b>	[REDACTED]		
<b>Address and/or Residents Association</b>	[REDACTED] [REDACTED] [REDACTED]		
<b>Status:</b>	Valid	<b>In support or opposed:</b>	In support
<b>Received:</b>	26 September 2023		

I am writing in support of premises licence application for 9-11 Kingly Street (reference 23/05401/LIPN).

I have been to the Little Scarlet Door on Greek Street and thought it was a lovely place to have a few cocktails and a bite of food without the raucous crowds one usually finds in the middle of Soho. The staff were incredibly friendly and I felt right at home, as per the concept.

Soho needs more places one can spend their evening in a relaxed atmosphere, without any trouble and venues like this attract a better balance of people who behave responsibly and do not drink too much. In addition, having attractive venues that aren't members clubs provide access for all, and these are few and far between in Soho.

[REDACTED] I believe that businesses should be given some flexibility to operate in a way that works for them to be financially viable. Given how much hospitality has suffered, and its importance to our culture, I think it would be a shame to hold back one of the few that adds a



little class to the streets of Soho.			
<b>Name:</b>		[REDACTED]	
<b>Address and/or Residents Association:</b>		[REDACTED] [REDACTED] [REDACTED] [REDACTED]	
<b>Status:</b>	Valid	<b>In support or opposed:</b>	In support
<b>Received:</b>	25 September 2023		
<p>I am confident Little Door will promote the licensing objectives.</p> <p>It is not the kind of venue or crowd that will add to public nuisance or disorder, like some other venues in Soho do.</p> <p>I think it would be great for Little Door to bring their concept to Kingly Street, and bring this disused building back to life.</p> <p>They will really add to the character of the area.</p> <p>It is the kind of venue that will make Soho a better place to live in and to visit. I'm sure it will be well managed and attract a friendly crowd.</p> <p>Venues like this attract a better balance of people out at night, who behave responsibly and do not drink too much.</p> <p>I think adding another Little Door venue will help make Soho safer and more welcoming. We should be supporting businesses like this.</p> <p>I know their other venues, including the Little Scarlet Door on Greek Street, and they have a unique vibe and a really welcoming atmosphere which will be perfect for the area.</p>			
<b>Name:</b>		[REDACTED]	
<b>Address and/or Residents Association</b>		[REDACTED] [REDACTED] [REDACTED]	
<b>Status:</b>	Valid	<b>In support or opposed:</b>	In support
<b>Received:</b>	02 October 2023		
<p>It is a chilled place where there is no trouble and you can spend the whole night, without having to worry about people bothering you. [REDACTED] the venue is clean and vibrant, the staff are friendly and plentiful so it feels safe and their noise level is always respectful towards the community.</p>			
<b>Name:</b>		[REDACTED]	
<b>Address and/or Residents Association</b>		[REDACTED] [REDACTED] [REDACTED]	
<b>Status:</b>	Valid	<b>In support or opposed:</b>	In support
<b>Received:</b>	28 September 2023		
<p>[REDACTED] I support the proposed application from the Little Door Co. Having known the brand since inception, and being a frequent visitor of the Little Scarlett Door on Greek Street, I know that they will be a good addition to the area, providing a welcoming and friendly space for socialising and dancing. I have never seen any trouble at any of their venues, and security staff have always been polite; and firm when needed. I have no doubt that they will</p>			



meet their licensing objectives and ensure that the highest standards across their team are met.

Given the reduction of nightlife venues, in order to continue to be a vibrant area of London, it is important that we attract and support good venues who are willing to invest. It is important to ensure that the character of Kingly Street/Carnaby Street is maintained as a must-visit area and the addition of a new Little Door can only be a plus. Further, it will fit in well with the other restaurants and bars while having a unique offering.

<b>Name:</b>	[REDACTED]		
<b>Address and/or Residents Association:</b>	[REDACTED] [REDACTED] [REDACTED]		
<b>Status:</b>	Valid	<b>In support or opposed:</b>	In support
<b>Received:</b>	27 September 2023		

[REDACTED], I think it would be great for Little Door to bring their concept to Kingly Street, and bring this disused building back to life.

<b>Name:</b>	[REDACTED]		
<b>Address and/or Residents Association:</b>	[REDACTED] [REDACTED] [REDACTED]		
<b>Status:</b>	Valid	<b>In support or opposed:</b>	In support
<b>Received:</b>	27 September 2023		

I am writing in support of premises licence application for 9-11 Kingly Street (reference 23/05401/LIPN).

The Little Door's concept sounds unique, and perfect for Soho. A casual venue where one can eat and drink, in a relaxing space, is exactly the kind of place that we ought to be promoting across London; not just in Soho. I strongly believe it is not the kind of venue or clientele that would add to or create public nuisance or disorder.

I also believe that it would be wonderful for a thriving, reliable business to bring this disused building back to life. In times like these where many businesses are struggling, we should be giving innovative businesses such as The Little Door's the opportunity to flourish, add value to our economy and provide a useful service to the area. The application has my full support!

<b>Name:</b>	[REDACTED]		
<b>Address and/or Residents Association:</b>	[REDACTED]		
<b>Status:</b>	Valid	<b>In support or opposed:</b>	In support
<b>Received:</b>	01 October 2023		

Having experienced the welcoming atmosphere at Little Scarlet Door on Greek Street, I can personally attest to the unique vibe and safe environment their venues provide. It's crucial to have such places in Soho, where people can relax and enjoy their evenings without concerns.



<b>Name:</b>		[REDACTED]	
<b>Address and/or Residents Association:</b>		[REDACTED] [REDACTED] [REDACTED]	
<b>Status:</b>	Valid	<b>In support or opposed:</b>	In support
<b>Received:</b>	23 September 2023		
It's important to have a good night life in London, These guys know how to it right. Been to all their venues around London and they've all been really good.			
<b>Name:</b>		[REDACTED]	
<b>Address and/or Residents Association</b>		[REDACTED] [REDACTED] [REDACTED] [REDACTED]	
<b>Status:</b>	Valid	<b>In support of opposed:</b>	In support
<b>Received:</b>	22 September 2023		
It looks like they will be much more welcoming and relaxed than some other venues in Soho, which can sometimes be intimidating, especially as a woman. Venues like this attract a better balance of people out at night, who behave responsibly and do not drink too much. Ultimately, I have always had a great time there with great people. [REDACTED] [REDACTED] I have never had any problems with noise or disturbances when walking home.			
<b>Name:</b>		[REDACTED]	
<b>Address and/or Residents Association</b>		[REDACTED] [REDACTED] [REDACTED]	
<b>Status:</b>	Valid	<b>In support or opposed:</b>	In support
<b>Received:</b>	26 September 2023		
I am writing in support of premises licence application for 9-11 Kingly Street (reference 23/05401/LIPN).  I have heard a lot about the Little Door venues and it sounds exactly the kind of place we need more of in Soho. I think it will add to the character of the area, as well as attracting the right kind of visitors. Adding another Little Door venue will help make Soho safer and more welcoming. We should be supporting businesses like this, not holding them back.			
<b>Name:</b>		[REDACTED]	
<b>Address and/or Residents Association:</b>		[REDACTED] [REDACTED] [REDACTED] [REDACTED]	
<b>Status:</b>	Valid	<b>In support or opposed:</b>	In support
<b>Received:</b>	25 September 2023		
[REDACTED] [REDACTED] In all this time I have enjoyed the Little Door venues on the Fulham Road (blue door), on All Saints Road in Notting Hill [REDACTED] as well as the Little Scarlet Door on Greek street. They are truly unique and welcoming places that make patrons really feel at home. I enjoy being able to have dinner followed by drinks in the same place and love the relaxed atmosphere.			



Further - I have always experienced the venue to be most professionally run, from the barkeepers to the friendly and professional door and security staff that kept the place running smoothly at all times.

In a nutshell - I have no doubt that their new venue on Kingly Street will add fantastically to the neighbourhood and cannot wait to visit it! Kindly take this letter as my strong endorsement for their application!

<b>Name:</b>	[REDACTED]		
<b>Address and/or Residents Association</b>	[REDACTED] [REDACTED] [REDACTED] [REDACTED]		
<b>Status:</b>	Valid	<b>In support of opposed:</b>	In support
<b>Received:</b>	26 September 2023		

I'm writing to lodge my support for this license application.

I know the people behind this venue, and I can wholeheartedly stand for their professionalism and the quality of their operations. I have no doubt they will promote the licensing objectives and be a credit to the neighbourhood.

They run the kind of business which is well managed and attracts a friendly and responsible crowd - not something which can be said about all venues in the area! Another Little Door venue will only contribute positively towards Soho - both in terms of the business and the safety of the surrounding streets.

[REDACTED] I'm in favour of supporting the right sorts of young businesses and ensuring the centre of our city stays vibrant. Backing the right operators and giving them the flexibility to operate to their best encourages growth and investment into the borough. There is nothing positive to be gained by blocking this application.

<b>Name:</b>	[REDACTED]		
<b>Address and/or Residents Association</b>	[REDACTED] [REDACTED] [REDACTED] [REDACTED] [REDACTED]		
<b>Status:</b>	Valid	<b>In support or opposed:</b>	In support
<b>Received:</b>	28 September 2023		

I believe the proposed Kingly Soho license will promote the licensing objective. I have been to the Little Scarlet Door many times and love the atmosphere there. [REDACTED] and one of the few places in Soho I know has good drinks, good food, a great atmosphere and is safe. It's nice to have a chilled place to go out and be during the day as well for a bite to eat or a coffee. Every time I have gone, the hospitality has been incredible, the staff go out of their way to make you feel comfortable and welcome. Once I even lost a jacket there and they went to lengths to help me find it. It would be great to have another location opened by this reputable brand.



<b>Name:</b>		[REDACTED]	
<b>Address and/or Residents Association:</b>		[REDACTED] [REDACTED] [REDACTED]	
<b>Status:</b>	Valid	<b>In support or opposed:</b>	In support
<b>Received:</b>	28 September 2023		

I am writing to express my wholehearted support for the proposed Little Door venue on Kingly Street. I am convinced that Little Door's unique concept and welcoming atmosphere would be an excellent addition to the area.

Little Door stands out as a place where patrons can enjoy a relaxed evening without any worries about disturbances. I believe that the addition of a Little Door venue will enhance the character of Soho and contribute to a safer and more welcoming community.

I firmly believe that granting this application will promote the licensing objectives and help make Soho an even better place to live and visit.

<b>Name:</b>		[REDACTED]	
<b>Address and/or Residents Association</b>		[REDACTED] [REDACTED] [REDACTED] [REDACTED]	
<b>Status:</b>	Valid	<b>In support or opposed:</b>	In support
<b>Received:</b>	25 September 2023		

I am in full support of the new premises license in Kingly Street.

[REDACTED] an existing Little Door bar. I also love to go to Little Scarlet Door with my friends for cocktails. I've never had any issues with noise [REDACTED] and the type of crowd the bar attracts are always civil and respectful. It's always well managed and I've never seen any trouble.

One of the main reasons [REDACTED] is to be in such close proximity to outstanding independent restaurants and nightlife. I believe this will be a great addition to Soho and is just the vibe we need.

I think their new venue will greatly promote the licensing objectives.

<b>Name:</b>		[REDACTED]	
<b>Address and/or Residents Association</b>		[REDACTED] [REDACTED] [REDACTED]	
<b>Status:</b>	Valid	<b>In support or opposed:</b>	In support
<b>Received:</b>	26 September 2023		

[REDACTED] I would like to give my support to the application for licence of the Little Door venue on 9-11 Kingly Street application number 23/05401/LIPN.

I am a customer of their other venues, particularly the Little Scarlet Door on Greek Street, their venues are very well run and managed, and they have an atmosphere and customer profile which will be perfect for the area. I have visited many times and have never seen anything but great service and atmosphere there. It is clear to me that the company is completely committed to upholding the licencing objectives. It is a venue that I can take friends to or go alone and I



always find it to have a safe, comfortable, friendly atmosphere.

Being able to pop into their venues and have a drink and a bite to eat together is always a benefit as it saves me from having to go to a number of places. Soho needs more safe well run venues like the one proposed on Kingly Street.

I think it would be great for Little Door to bring their concept to Kingly Street, and bring this disused building back to life, there are surprisingly few venues in the Carnaby area who really look after people like me. I also feel that they are the perfect operators to take over and use this empty venue.

Soho needs more diverse well-run places to go to in the evenings. Venues like this one attract a more balanced and mature discerning customer. This can only be good for the area. [REDACTED]

[REDACTED] and I feel that sometimes their policy of blocking new applications from good operators like this just deters new investment, and ensures that nothing changes for the better. I have no doubt that granting this application will promote the licensing objectives.

Thank you for considering my letter of support.

<b>Name:</b>	[REDACTED]		
<b>Address and/or Residents Association:</b>	[REDACTED] [REDACTED] [REDACTED]		
<b>Status:</b>	Valid	<b>In support or opposed:</b>	In support
<b>Received:</b>	25 September 2023		

[REDACTED] The Little Yellow Door. I go there often because it's safe for females, has good security, no disturbances outside, and is very clean.

Also since it has food and drinks and lots of seating, it's a place I can spend the whole evening without having to move locations.

The owners and staff are responsible and friendly.

<b>Name:</b>	[REDACTED]		
<b>Address and/or Residents Association:</b>	[REDACTED] [REDACTED] [REDACTED]		
<b>Status:</b>	Valid	<b>In support or opposed:</b>	In support
<b>Received:</b>	22 September 2023		

I have been to all the Little Door venues in London, and am a frequent visitor at the Little Yellow and Scarlet doors. I love the atmosphere they create, which is unique and incredibly friendly. The crowd there is always nice and super well behaved (unlike many other establishments in Soho!) They are such a great addition to any neighbourhood, and especially Soho, which definitely needs more places where everyone can feel welcome, safe and have fun!



<b>Name:</b>		[REDACTED]	
<b>Address and/or Residents Association</b>		[REDACTED] [REDACTED] [REDACTED] [REDACTED]	
<b>Status:</b>	Valid	<b>In support or opposed:</b>	In support
<b>Received:</b>	28 September 2023		
I would like to support the application. i have been to the other Little Door Venues over the years and they are all run extremely well. I have always found the crowd to be a friendly one and I believe it will be a positive addition to the area.			
<b>Name:</b>		[REDACTED]	
<b>Address and/or Residents Association:</b>		[REDACTED] [REDACTED] [REDACTED] [REDACTED]	
<b>Status:</b>	Valid	<b>In support or opposed:</b>	In support
<b>Received:</b>	02 October 2023		
I would like to express my support for the opening of a new Scarlet Door venue in Soho. Having experienced the existing Scarlet Door venue in Soho, I believe it to be a really valuable addition to the neighbourhood, as it is a really inclusive space that supports the spirit of community. I would be thrilled to have more venues where I can connect with others in a safe, inclusive and accessible space.			
<b>Name:</b>		[REDACTED]	
<b>Address and/or Residents Association</b>		[REDACTED] [REDACTED] [REDACTED] [REDACTED]	
<b>Status:</b>	Valid	<b>In support or opposed:</b>	In support
<b>Received:</b>	28 September 2023		
I would like to support this project. The little doors are great venues, the staff and guests are very friendly and respectful and as a woman I've always felt very safe there, just because they've managed to create a very nice, respectful atmosphere. These are the reasons why I would like to help them open another venue as I think London would benefit from having more party places like these!			
<b>Name:</b>		[REDACTED]	
<b>Address and/or Residents Association</b>		[REDACTED] [REDACTED] [REDACTED] [REDACTED]	
<b>Status:</b>	Valid	<b>In support or opposed:</b>	In support
<b>Received:</b>	21 September 2023		
[REDACTED]			
I'm writing in regards to the Little Door group, of whose venues I've frequented regularly over the last 5 years. It's a lovely relaxed spot which in my mind is always reminiscent of someone's ideal living room - laid back and spacious.			
[REDACTED] who doesn't have a large living room (or indeed much room at all) its filled a wonderful role historically, and indeed has played host to 4 of my last birthday parties with			



friends.

The idea for a new venue in Kingly Street sounds like a wonderful idea as we need more safe, relaxed and charming venues in the area - I'm confident little doors will promote the licensing objectives set and generally produce a great product as per prior wonderful venues.

On a personal note it would be great to have one [REDACTED]

<b>Name:</b>	[REDACTED]		
<b>Address and/or Residents Association:</b>	[REDACTED] [REDACTED] [REDACTED] [REDACTED]		
<b>Status:</b>	Valid	<b>In support or opposed:</b>	In support
<b>Received:</b>	25 September 2023		

I would like to pledge my support for [REDACTED], Managing Director of Little Door & Co. I have personally known [REDACTED] for over 15 years and he has proven to be both a loyal friend and an upstanding citizen who has grown his Little Doors into something truly unique and highly valued by the London communities in which they are based.

Since the first Little Yellow Door opened in Notting Hill, I have had the privilege of attending his community-building events and creative locations. Each Little Door has been individually decorated to give the feeling of being in the comfort of a friend's home and its this relaxed atmosphere that tends to make its patrons connect more deeply than other less personal establishments.

I believe that a Little Door based in Kingly Street would be an asset to Soho and a valued establishment for residents to feel at home and connect socially with their neighbours.

<b>Name:</b>	[REDACTED]		
<b>Address and/or Residents Association:</b>	[REDACTED] [REDACTED] [REDACTED]		
<b>Status:</b>	Valid	<b>In support or opposed:</b>	In support
<b>Received:</b>	27 September 2023		

The little doors add a wonderful warm feeling to every location that I've been to. I feel like I can go there safely alone, and as a woman that is quite rare. The staff at all the venues are especially kind. The concept reminds me of a sort of a non exclusive clubhouse that anyone is welcome to. The fact that they are started by two young friends is so unusual these days in a city bombarded with international chains of cold and lackluster venues. Let's keep London alive by letting these sorts of projects flourish.

<b>Name:</b>	[REDACTED]		
<b>Address and/or Residents Association:</b>	[REDACTED] [REDACTED] [REDACTED]		
<b>Status:</b>	Valid	<b>In support or opposed:</b>	In support
<b>Received:</b>	29 September 2023		

[REDACTED]

I can say without a doubt that the little doors bars/clubs have been the most incredible and transformative.



Having reviewed the "Inclusion in the Evening and Night Time Economy Task Group Report" published in 2019, I can say without a doubt that the little doors are exemplary in their consideration for all guests' requirements. They host a diverse crowd and everyone absolutely adores the atmosphere and diversity yet somehow they make it affordable and inclusive.

In conclusion, I could not recommend the little doors proposed next venue highly enough.

<b>Name:</b>	[REDACTED]		
<b>Address and/or Residents Association:</b>	[REDACTED] [REDACTED] [REDACTED]		
<b>Status:</b>	Valid	<b>In support or opposed:</b>	In support
<b>Received:</b>	26 September 2023		

I am writing in support of premises licence application for 9-11 Kingly Street (reference 23/05401/LIPN).

I have heard a lot about the Little Door venues and am a member. I am excited to try their new one, it sounds exactly the kind of place we need more of in Soho! The idea of a relaxed bar where you can also get something to eat is really appealing and I think it will add significantly positively to the character of the area, as well as attracting the right kind of visitors.

Adding another Little Door venue will help make Soho safer and more welcoming. We should be supporting businesses like this, not holding them back.

<b>Name:</b>	[REDACTED]		
<b>Address and/or Residents Association:</b>	[REDACTED] [REDACTED] [REDACTED]		
<b>Status:</b>	Valid	<b>In support or opposed:</b>	In support
<b>Received:</b>	28 September 2023		

[REDACTED] I am writing in support of the Little Door group who are intending to open a new bar in Soho.

[REDACTED] who has also frequented the other Little Door bars, particularly, Little Scarlet Door on Greek Street, I think their new bar would be a perfect addition to the borough.

The bars are welcoming, feel unique with their laid back living room style. They're a great place to meet friends for a drink, or some food before or after visiting one of the area's theatres, cinemas etc. or just spend the whole evening at with a date. The new bar would fit seamlessly into and enhance the Soho ecosystem.

Finally, as a woman, I think there is a great importance in knowing that there are safe bars that are open late in Soho. And I have always felt safe and welcomed when visiting a Little Doors bar. And I believe we need more places that feel safe in soho for everyone where you can relax with a drink for an evening and not experience any trouble.

I hope you consider my points and allow Little Door to open this new exciting site.



<b>Name:</b>		█	
<b>Address and/or Residents Association</b>		█	
<b>Status:</b>	Valid	<b>In support or opposed:</b>	In support
<b>Received:</b>	28 September 2023		
<p>█ would be grateful for the Licensing Authority's consideration of this representation in support of the above premises licence application, based upon the promotion of all four licensing objectives.</p> <p>█ provides a unified voice for all businesses in Soho, with the aim of protecting and growing the economic diversity of the area in which we do business, through engaging with each other, our residents, other amenity groups and Westminster City Council. We currently represent almost 100 businesses in the Soho area, with hospitality, retail and property being our current focus.</p> <p>Formed in 2020, initially as a forum to help each other face the unprecedented challenges of the Covid-19 pandemic, we are now focussed on partnership working through the Covid-19 recovery period and beyond. We are all committed to safeguarding Soho's iconic status as a world class destination for independent retail, cutting edge food, live entertainment and Soho's very special culture that defines our community and its unique heritage.</p> <p><b>The Application</b></p> <p>The Little Door are a member of the █ and a crucial one at that as they provide a unique individuality with their food and beverage offering. A majority of their customers are female and we understand from their customers that it is considered 'a safe place' where women in particular can go and relax. We should be welcoming first-rate operators like Little Door into Soho with open arms. Their concept is uniquely warm, inviting and homely.</p> <p>Little Door are not asking for a new licence per se. They are simply proposing to tweak an existing licence to make it fit their operating model, so that it is viable for them – in a manner that involves giving up a huge amount of late-night drinking capacity in the week, and introducing a new list of modernised conditions. These changes undoubtedly promote the licensing objectives and make things better and safer in Soho. █ believes that having a night-time economy made up of operators like Little Door improves Soho and having a late offering, to an extent, means that patrons are more likely to finish their night there, without being tempted to continue elsewhere.</p> <p>We have to permit some flexibility to new businesses to come in and do things differently. The alternative is that Soho regresses, while the innovative entrepreneurs looking to invest in London are driven to flourish elsewhere - in other boroughs – and Soho becomes a stagnant pond of non-independent business who have little interest in making Soho a better place.</p> <p>Thank you for considering the █ views.</p>			
<b>Name:</b>		█	
<b>Address and/or Residents Association</b>		█	
<b>Status:</b>	Valid	<b>In support or opposed:</b>	Opposed
<b>Received:</b>	12 September 2023		



## Representation

We request Councillors on the panel to consider our concerns about this application for a new bar in the West End Cumulative Impact Zone. As the Committee are aware the onus is on the applicant to demonstrate they will not increase cumulative impact and will promote the licensing objectives. We will present evidence on the impact of the huge number of licensed premises is having on the lives of residents and how the high level of crime has made the area very unsafe for people on a night out. Any licensed premises which increases the number of people on the streets at night will have a negative impact on residents and will increase the level of crime in the area. (Appendix 1 Crime and Disorder). As background the Committee may be aware of a similar application (23/01201/LIPV) in February 2023, we objected to this application and at the Licensing Sub Committee hearing on 11 May the application was refused on the following grounds; *'The Sub-Committee's number one focus was on the additional numbers (in this case an increase to 70 people) entering the West End CIZ if the application were granted with the proposed increase in hours and the effect those numbers would have on the CIA overall. This was the true crux of the matter.'* The Licensing Sub Committee were also concerned with crime peaking between 1am and 3am and patrons becoming victims of crime. This new application is for a 1am bar with a capacity of 180, it proposes an exception to policy under PB1(c), stating, *'the substantial decrease in hours, together with the removal and amendment of the conditions therefore provides exceptional circumstances and promotes the licensing objectives.'* We disagree with this statement and say the application fails the tests under PB1 (B); ***B. It is the Licensing Authority's policy to refuse applications within the West End Cumulative Impact Zone other than:*** 1. *Applications to vary the existing licence hours within the council's Core Hours Policy HRS1.* 2. *Applications that seek to vary the existence licence so as to reduce the overall capacity of the premises. (our emphasis)* We note on Saturdays the current hours fall within the Core Hours Policy of midnight whereas this proposal aims to increase the terminal hour to 1.30am. For information there have been two previous applications to extend the Saturday licensable activities of midnight by reducing and transferring the terminal hours on Monday, the application in 2018 (18/03731/LIPV) was refused and the application in 2022 (22/08338/LIPV) was withdrawn. We do not consider the reduction of hours from 3am to 1am on Mondays and Tuesdays to be true reductions in hours, these being the quietest nights of the week whereas Saturday being the busiest. This application also aims to change the operation from a private members club to a public access bar/music and dance venue and with an increase in capacity. The Cumulative Impact Policy CIP1 makes reference to increases in capacity, *'Neither will the licensing authority consider the case to be exceptional merely because the capacity of the premises, or any proposed increase in capacity is small. The high number of premises within the West End Cumulative Impact Zone means that a small increase in capacity in each premises would lead to a significant increase overall within that area.'* (D14) (our emphasis) In relation to cumulative impact we make the following observations. Although the number of 'alcohol hours' are proposed to be reduced overall this does not take into account that capacity will increase and especially on a Saturday. It is not the hours that should be counted but the numbers of people who have access to alcohol in those hours. Not only will the numbers increase but also the way alcohol will be consumed, there will be 90 vertical drinkers after 23:00hrs, this being a significant change from the current licence offered for surrender as condition (22) states, *'After 23:00hrs the supply of alcohol at the premises shall only be to a person seated at a table.'* The Cumulative Impact Policy CIP1 acknowledges the importance of the concentration of drink-led premises and the number of people in the area at night, its states, *'The West End Cumulative Impact Zone has been identify because of the cumulative effect of the concentration of late night drink led premises and /or night cafés has led to serious problems of disorder and/or public nuisance affecting residents, visitors and other businesses. The extent of crime and disorder and public nuisance in the West End Cumulative Impact Zone arises from the number people there late at night: a considerable number of them being intoxicated.'* (D4) (our emphasis) For more information see Appendix 2 Cumulative Impact. The applicant proposes a set of conditions, some of which raise concerns in particular the provision of SIAs will be risk assessed on an ongoing basis and substantial food shall be available, we ask the applicant to confirm the food offer as kitchen facilities are absent from the plans. We are concerned that granting any licences in this area will

have an impact on the licensing objectives, Soho has the highest concentration of licensed premises in Westminster, 487 with a large proportion (25%) being late night licences. There are 121 licensed premises between the hours of 1am - 6am, with a capacity of over 22,827. The area is densely populated at night with people creating loud levels of noise causing disturbance, alongside an increase in crime, disorder and anti-social behaviour. Residents already suffer from high levels of noise and disturbance during the evening and late into the night from the huge numbers of intoxicated people on the street. They are disturbed as people walk by either shouting, screaming or arguing, noise from pedicabs, car doors slamming, horns honking, they are also subjected to anti-social behaviour with people vomiting and urinating in the street or in their doorways. [REDACTED] are already disturbed by patrons as they leave other late night premises in the area who are usually highly intoxicated, making a noise as they pass by to continue their night out or while they wait to be picked up by taxis, the addition of more people later at night will create even more disturbance. We note a dispersal policy will be available upon request and the provisions of SIAs will be risked assessed on an ongoing basis, however, these management systems and the 24/7 security team cannot prevent residents from being disturbed at night, they have repeatedly failed to prevent noise nuisance as evidenced by the experience of [REDACTED]. We do not believe SIAs and security measures in the area can mitigate against the impact of 180 intoxicated people being discharged onto the streets at 1.30am, they can't control their dispersal routes and can't stop people from carrying on their night out in Soho making a noise and disturbing residents along the way. With all of the above it is unsurprising residents experience sleep disturbance, a survey conducted by [REDACTED] confirms that residents are disturbed by noise at night and this is having a negative impact on their lives. 87 people responded of which 78 are Soho residents with ages spread fairly evenly from 22 to 80, 59% having lived in Soho for more than 10 years. When asked about disturbed sleep; 24% of respondents have their sleep disturbed 7 nights a week, 16% 5 or 6 nights a week and 19% 3 or 4 nights a week. Furthermore, 64% of respondents agreed that noise nuisance from increased commercial activity at night is the most serious problem impacting Soho residents quality of life. 62% of respondents agreed that the council should not grant any extensions of hours for premises in Soho. 60% of respondents agreed that noise nuisance and sleep deprivation is adversely impacting my health and the health of the people they live with. 46% of respondents agreed that noise nuisance is so bad that they have considered moving away from Soho. The full survey can be found in Appendix 3. In summary, the policy clearly states the extent of crime and disorder and public nuisance in the West End Cumulative Impact Zone arises from the number of intoxicated people in the area at night, it is therefore without doubt this application will fail to promote the licensing objectives and increase cumulative impact. We find no reason to go against the decision of the Licensing Sub Committee decision on 11 May and respectfully request this application be refused. Yours faithfully, Licensing Committee [REDACTED]

Appendix 1: Crime and Disorder Appendix 2: Cumulative Impact Appendix 3: [REDACTED] Sleep Survey Results Appendix 4: The Application Appendix 5: The Soho Society Appendix 1 : Crime and Disorder **The Cumulative Impact Assessment 2020 presents overwhelming evidence of the year on year increase in cumulative impact in the West End Zone 1, it highlights the rate of crime as 10 - 13 times higher between 6pm - 6am compared to the borough average. The level of crime, disorder and anti social behaviour continues to be a huge problem in Soho, the crime figures are high and rising. The recent police crime reports for April /May shows current levels of alcohol related assaults, sexual assaults and robberies within the West End area are now higher than at pre-COVID levels. The peak times for crime being between 10pm - 2am. In Soho the majority of robberies take place at night, people are targeted as they leave venues. Alongside the robberies and assaults drug dealing is a huge problem with groups of dealers congregating to sell drugs to people as they leave premises or as they pass by. There are more dealers in the area at night than during the day, this is directly linked to the large number of venues and people which creates the drugs market. Pickpockets also operate in the area, they are a part of a well organised criminal group who arrive in a van at night and disperse into Soho before returning to be driven away. It is well known that intoxicated people become victims of crime, their vulnerability being exploited by gangs or individuals who are in Soho explicitly to target them. We believe patrons leaving this cafe at night will be at high risk of becoming victims of crime.**

Appendix 2: Cumulative Impact This area has been identified by the Westminster City Council



as under stress because the cumulative effect of the concentration of late night and drink led premises and night cafes has led to serious problems of disorder and/or public nuisance affecting residents, visitors and other businesses. The evidence presented in the Cumulative Impact Assessment 2020 is overwhelming, it describes the high level of cumulative impact in the West End Zone between 2017-2019. It concludes that, *'After consideration of the cumulative impact assessment it is the Licensing Authority's view that the number of premises licences in the West End, are such that it is likely granting further types of licences or varying existing licences would be inconsistent with the authority's duty to promote the licensing objectives. The granting of licences for certain types of operation that are likely to add to Cumulative Impact within these areas would not be consistent with the Licensing Authority's duty under the Licensing Act 2003.'* (p. 19) **(our emphasis)** In any applications for an alcohol licence in the Cumulative Impact Zone, the applicant is required to demonstrate that the application will not increase the Cumulative Impact. The analysis in the Cumulative Impact Assessment 2020 showed a very strong correlation between the number of licences and the extent to crime, violence and anti-social behaviour generally. This data means that impact is increased by any additional drinkers. It states for every additional licence premises the analysis will continue to show that reported incidents are likely to increase by something between 6% and 17% and crimes to increase by over 10%. The policies in relation to the cumulative impact zone are directed at the global and cumulative effects of licences on the area as a whole (D16. of the policy). D23. *'The proximity of residential accommodation is a general consideration with regard to the prevention of public nuisance. It goes on, 'The nature of cumulative impact is that it is cumulative and affects not only the immediate vicinity of the premises, but the wider area; thus the number of people visiting the premises, the nature of licensable activities and the lateness of operations have an impact on an area as a whole, irrespective of whether or not there is residential accommodation in proximity to the premises.'* **(our emphasis)** It is important to note the policy relates to the global effects of alcohol licences in the whole impact zone and not just a part of it. Appendix 3 : [REDACTED] Sleep Survey Results - 31st October 2022 This survey conducted by [REDACTED] confirms that residents are disturbed by noise at night and this is having a negative impact on their lives. 87 people responded of which 78 are Soho residents with ages spread fairly evenly from 22 to 80. 59% have lived in Soho more than 10 years 26% between 3 and 10 years 6% between 1 and 3 years and 9% have lived here less than a year 42% own their homes 20% are Soho Housing Association and the rest tenants with other landlords 10 respondents have children living at home with them 58% have double glazing 37% single glazing 5% have triple glazing 24% of respondents have their sleep disturbed 7 nights a week 16% of respondents have their sleep disturbed 5 or 6 nights a week 19% of respondents have their sleep disturbed 3 or 4 nights a week 19% of respondents have their sleep disturbed once or twice a week 20% do not have a problem with environmental noise pollution Topping the list in September was people drinking in the street with 54 mentions, then pedicabs with 51, waste collections at 48, construction noise 36 and car horns 33 and deliveries at 25. Other noise sources identified were air conditioning, motorbikes revving, building alarms and music from licensed venues. The most common identified problem at 42% of respondents was people drinking and shouting in the street. 64% of respondents agreed that noise nuisance from increased commercial activity at night is the most serious problem impacting Soho residents quality of life 46% of respondents agreed that noise nuisance is so bad that they have considered moving away from Soho 60% of respondents agreed that noise nuisance and sleep deprivation is adversely impacting my health and the health of the people they live with. 67% of respondents agreed that the council should base its noise policy on the World Health Organisation guidelines 64% of respondents agreed that our ward councillors should make this their priority during the next four years 69% of respondents agreed that during the time I have lived in Soho noise pollution has got significantly worse 73% of respondents agreed that if noise limits are being exceeded the council should consider reviewing existing alcohol licences 72% of respondents agreed that the council should install electronic noise monitoring in Soho 56% of respondents agreed that the council should not grant additional premises licence for the sale of alcohol in Soho. 62% of respondents agreed that the council should not grant any extensions of hours for premises in Soho 68% of respondents agreed that the council should renew its noise strategy as a matter of urgency Many respondents made additional comments:- [REDACTED] the

noise & air pollution finally broke me. Like the frog in the pan of water with the heat gradually turned up, it took me a while to realise that it wasn't me going soft, it was the significant degradation of the environment around me. [REDACTED] several other tenants have moved in & swiftly out again citing sleep disruption & excessive night noise as their reason for leaving. The flat is now used as an office rather than as residential. I am disappointed that another restaurant unit is going to be let on Hopkins Street by Shaftesbury when the residents already have an enormous amount of noise from the existing restaurants. No doubt they will also want an alcohol licence, which will increase the noise and disturb residents even more. [REDACTED] I find it extremely exhausting not able to have rest at night, screams and noise of drunk people every night, [REDACTED] does not want to change the windows to a double glazing nor allow tenants to pay privately for windows to be upgraded. Noise at home, lack of sleep, and concentration in the day time. I have a hand held noise monitor, I recorded noise levels of 97db outside the pub at the corner of [REDACTED]. More consideration needs to be given to residents from councillors, people visiting the area and local businesses in particular those who serve alcohol and have late night licences. Decisions such as granting planning and licence applications should not be made by people who do not live in the area and are therefore not impacted by the decision making. Very difficult to get the local authority to understand and take complaints seriously. Officers often helpful but then the case goes to committee and they always seem to rule in favour of the commercial premises rather than residents. There is supposed to be a presumption to refuse new licences but in practice the council still lets new things through until after midnight, which is far too late and has made a nonsense of the policy. There should be a quiet window of 11pm to 8am every day. 7am deliveries are far too early for a lot of people if they are noisy or use cages or refrigeration. [REDACTED] Regularly now (most nights) there are traffic jams in the street at 3am in the morning with cars picking up people leaving clubs. The cars frequently are using their horns. Last night they had their door open with music blaring. we have 2 motorbike stands close together. 1 in [REDACTED] and 1 in [REDACTED]. There is always at least one bike revving up at either 3am or really early like 530am. This noise has changed and increased over the past 3-4 years. I am woken up most nights at about 3am. And I have double glazing and am on [a high] floor. Businesses take no responsibility for their customers drinking/eating and mainly shouting out-side, including when they are queuing, and particularly when they are leaving. Post al fresco, there is a new attitude that anything goes on the streets and that includes contempt for the community who live here. The Council need to rethink this and put some major resource into enforcement. [REDACTED]

[REDACTED] It's never been this noisy! Early hours waste collections (including bottle smashing) also includes the food & beverage businesses putting their waste in the street and bottle bins at anti-social hours ahead of collection times. Our local restaurants are not supposed to put bottles out between the hours of 23:00 and 07:00 but they frequently do. Frequently delivery trucks some with noisy refrigeration units are also delivering early hours. Also deliveries & pedicabs. Unfortunately my lack of sleep due to noise has caused serious health issues and I now cannot work and suffer anxiety and depression. I'm woken up on average 5 times per night and have considered suicide. Why I'm being denied sleep between the hours of 11pm and 7am astonishes me. The freeholders Shaftesbury Carnaby show a total disrespect to the effects that noise has on the residents of Soho.

Appendix 4: The Application **New premises licence. Bar. The existing premises licence (ref 22/09921/LIPT) subject, inter alia, to conditions 20 and 21 in relation to membership and a capacity of 150. The current hours for the provision of licensable activities are 03:00 Monday to Friday, midnight Saturday and 22:30 Sunday. They application follows pre-application advice 22/10842/PREAPM and prospers a new premises licence to replace the existing licence ref 22/09921/LIPT, which is proposed to be surrendered. The new premises licence would differ from the current licence by:**

- A. Reducing the hours of licensable activities on the mornings following Monday to Friday 01:00 and increasing to 01:00 on the morning following Saturday (with Sunday left unchanged);
- B. Removing conditions 10 -12 (Rules of Management), 20 and 21 (membership), and 13 -17 and 22 (various), and replace them with a suite of modern and appropriate model conditions;
- C. Increasing the capacity to no more than 180, with minimum seating provision for at least 90;
- D. Updating the layout of the premises in accordance with the



enclosed plans, including changes to fixed seating and an increase in WC provision. Both the existing and proposed use fall within PB1 of the Statement of Licensing Policy. The substantial decrease in hours, together with the removal and amendment of the conditions therefore provides exceptional circumstances and promotes the licensing objectives. Alcohol : Monday to Saturday 10:00 - 01:00. Sunday: 12:00 - 22:30 Late Night Refreshment : Monday to Saturday, 23:00 - 01:00 Live Music/Recorded Music/Performance of Dance/Anything Similar Monday to Saturday, 09:00 - 01:00 Opening Hours: Monday - Saturday: 09:00 - 01.30. Sunday: 12:00 - 23:00 Capacity: 180 Appendix 5 : ██████████ ██████████ is a charitable company limited by guarantee established in 1972. ██████████ is a recognised amenity group and was formed to make Soho a better place to live, work or visit by preserving and enhancing the area's existing diversity of character and uses, and by improving its facilities, amenities and environment.

### 3. Policy & Guidance

The following policies within the City Of Westminster Statement of Licensing Policy apply:	
<b>Policy CIP1 applies</b>	<p>A. It is the Licensing Authority's policy to refuse applications within the West End Cumulative Impact Zone for: pubs and bars, fast food premises, and music and dancing and similar entertainment, other than applications to:</p> <ol style="list-style-type: none"> <li>1. Vary the hours within Core Hours under Policy HRS1, and/or</li> <li>2. Vary the licence to reduce the overall capacity of the premises.</li> </ol> <p>C. Applications for other premises types within the West End Cumulative Impact Zones will be subject to other policies within this statement and must demonstrate that they will not add to cumulative impact.</p> <p>D. For the purposes of this policy the premises types referred to in Clause A are defined within the relevant premises use policies within this statement.</p>
<b>Policy HRS1 applies</b>	<p>A. Applications within the core hours set out below in this policy will generally be granted for the relevant premises uses, subject to not being contrary to other policies in the Statement of Licensing Policy.</p> <p>B. Applications for hours outside the core hours set out in Clause C will be considered on their merits, subject to other relevant policies, and with particular regard to the following:</p> <ol style="list-style-type: none"> <li>1. The demonstration of compliance in the requirements of policies CD1, PS1, PN1 and CH1 associated with the likelihood of the effect of the grant of a licence for later or earlier hours on crime and disorder, public safety, public nuisance and the protection of children from harm.</li> <li>2. If the application is located within a Special Consideration Zone they have demonstrated that they have taken account of the issues identified in that area and provided adequate mitigation.</li> <li>3. Whether there is residential accommodation in the proximity of the premises that would likely be adversely affected by premises being open or carrying out operations at the hours proposed.</li> <li>4. The proposed hours of the licensable activities and when customers will be permitted to remain on the premises.</li> <li>5. The proposed hours when any music, including incidental music, will be played.</li> <li>6. The hours when customers will be allowed to take food or drink outside the premises or be within open areas which form part of the premises.</li> <li>7. The existing hours of licensable activities and the past operation of the premises (if any) and hours of licensable premises in the vicinity.</li> <li>8. Whether customers and staff have adequate access to public transport when arriving at and leaving the premises, especially at night.</li> <li>9. The capacity of the premises.</li> <li>10. The type of use, recognising that some venues are more likely to impact the licensing objectives than others; for example, pubs and bars are higher risk than theatres, cinemas and other cultural and sporting venues due to the nature of the operation.</li> </ol>



11. The Licensing Authority will take into account the active measures proposed for a 'winding down' period including arrangements for people to be collected from the premises to travel home safely.
12. Conditions on hours may be attached that require that the supply of alcohol for consumption on the premises ceases a suitable period of time before customers are required to leave the premises.
13. The council, acting as the Licensing Authority, may reduce hours if, after review, it is necessary to impose conditions specifying shorter hours in order to promote the licensing objectives.
14. Specific days for non-standard hours should be identified and justified as part of the application to allow responsible authorities and interested parties to evaluate the impact that these licensable activities may have, and to plan accordingly. The consideration of applications for later hours for Bank Holiday Mondays will take into account that later hours are generally granted for preceding Sundays and that the next day is a working day. Non-specific days are expected to be covered by Temporary Event Notices or variation applications.

C. For the purpose of Clauses A and B above, the Core Hours for applications for each premises use type as defined within this policy are:

1. **Casinos:** Up to 24 hours a day whilst casino gaming is permitted by a premises licence under the Gambling Act 2005.
2. **Cinemas, Cultural Venues and Live Sporting Premises:**  
Monday to Sunday: 9am to 12am
3. **Hotels:** Monday to Thursday: 9am to 11.30pm. Friday and Saturday: 9am to 12am. Sunday: 9am to 10.30pm. Sundays immediately prior to a bank holiday: 9am to 12am. For the sale of alcohol to guests for consumption in hotel/guest rooms only:  
Anytime up to 24 hours.
4. **Off licences:** Monday to Saturday: 8am to 11pm. Sunday: 9am to 10.30pm.
5. **Outdoor Spaces:** Monday to Thursday: 9am to 11.30pm. Friday and Saturday: 9am to 12am. Sunday: 9am to 10.30pm. Sundays immediately prior to a bank holiday: 9am to 12am.
6. **Pubs and bars, Fast Food and Music and Dance venues:**  
Monday to Thursday: 10am to 11.30pm. Friday and Saturday: 10am to 12am. Sunday: 9am to 10.30pm. Sundays immediately prior to a bank holiday: 12pm to 12am.
7. **Qualifying Clubs:** Monday to Thursday: 9am to 12am.. Friday and Saturday: 9am to 12am. Sunday: 9am to 10.30pm. Sundays immediately prior to a bank holiday: 9am to 12am.
8. **Restaurants:** Monday to Thursday: 9am to 11.30pm. Friday and Saturday: 9am to 12am. Sunday: 9am to 10.30pm. Sundays immediately prior to a bank holiday: 9am to 12am.
9. **Sexual Entertainment Venues and Sex Cinemas:** Monday to Thursday: 9am to 11.30pm. Friday and Saturday: 9am to 12am. Sunday: 9am to 10.30pm. Sundays immediately prior to a bank holiday: 9am to 12am.

D. Core hours are when customers are permitted to be on the premises and therefore the maximum opening hours permitted will be to the same start and terminal hours for each of the days where licensable activity is permitted.

E. For the purposes of this policy, 'premises uses' are defined within

	the relevant premises use policies within this statement.
<b>Policy PB1 applies</b>	<p>A. Applications outside the West End Cumulative Zone will generally be granted subject to:</p> <ol style="list-style-type: none"> <li>1. The application meeting the requirements of policies CD1, PS1, PN1 and CH1.</li> <li>2. The hours for licensable activities being within the council's Core Hours Policy HRS1.</li> <li>3. The operation of any delivery services for alcohol and/or latenight refreshment meeting the council's Ancillary Delivery of Alcohol and/or Late-Night Refreshment Policy DEL1.</li> <li>4. The applicant has taken account of the Special Consideration Zones policy SCZ1 if the premises are located within a designated zone.</li> <li>5. The application and operation of the venue meet the definition of a Public House or Bar in Clause D.</li> </ol> <p>B. It is the Licensing Authority's policy to refuse applications within the West End Cumulative Impact Zone other than:</p> <ol style="list-style-type: none"> <li>1. Applications to vary the existing licence hours within the council's Core Hours Policy HRS1.</li> <li>2. Applications that seek to vary the existing licence so as to reduce the overall capacity of the premises.</li> </ol> <p>C. The applications referred to in Clause B1 and B2 will generally be granted subject to:</p> <ol style="list-style-type: none"> <li>1. The application meeting the requirements of policies CD1, PS1, PN1 and CH1, and/or,</li> <li>2. The operation of any delivery services for alcohol and/or latenight refreshment meeting the council's Ancillary Delivery of Alcohol and/or Late-Night Refreshment Policy DEL1.</li> <li>3. The application and operation of the venue continuing to meet the definition of a Public House or Bar in Clause D.</li> </ol> <p>D. For the purposes of this policy a Public House or Bar is defined as a premises, or part of a premises that's primary use is the sale or supply of alcohol for consumption on those premises and/or for consumption off the premises for consumption outside the venue.</p>

#### 4. Equality Implications

The Council in its capacity as Licensing Authority has a duty to have regard to its public sector equality duty under section 149 of the Equality Act 2010. In summary, section 149 provides that a Public Authority must, in the exercise of its functions, have due regard to the need to:

- (a) eliminate discrimination harassment, victimisation and any other conduct that is prohibited by or under this Act;
- (b) advance equality of opportunity between persons who share a relevant protected characteristic and persons who do not share it; and
- (c) foster good relations between persons who share a relevant protected characteristics and persons who do not share it.

Section 149 (7) of the Equality Act 2010 defines the relevant protected characteristics as age, disability, gender reassignment, marriage and civil partnership, pregnancy and maternity, race, religion or belief, sex, and sexual orientation.



## 5. Appendices

<b>Appendix 1</b>	Premises plans
<b>Appendix 2</b>	Applicant supporting documents
<b>Appendix 3</b>	Existing premises licence 22/09921/LIPT
<b>Appendix 4</b>	Premises history
<b>Appendix 5</b>	Proposed conditions
<b>Appendix 6</b>	Residential map and list of premises in the vicinity

<b>Report author:</b>	Ms Jessica Donovan Senior Licensing Officer
<b>Contact:</b>	Telephone: 020 7641 6500 Email: <a href="mailto:jdonovan@westminster.gov.uk">jdonovan@westminster.gov.uk</a>

**If you have any queries about this report or wish to inspect one of the background papers please contact the report author.**

### **Background Documents – Local Government (Access to Information) Act 1972**

<b>1</b>	Licensing Act 2003	N/A
<b>2</b>	City of Westminster Statement of Licensing Policy	01 October 2021
<b>3</b>	Amended Guidance issued under section 182 of the Licensing Act 2003	December 2022
<b>4</b>	The Licensing Authority representation	27 September 2023
<b>5</b>	Environmental Health Service representation	05 September 2023
<b>6</b>	Metropolitan Police Service representation	29 September 2023
<b>7</b>	Interested party representation (1)	26 September 2023
<b>8</b>	Interested party representation (2)	22 September 2023
<b>9</b>	Interested party representation (3)	22 September 2023
<b>10</b>	Interested party representation (4)	27 September 2023
<b>11</b>	Interested party representation (5)	22 September 2023
<b>12</b>	Interested party representation (6)	22 September 2023
<b>13</b>	Interested party representation (7)	25 September 2023
<b>14</b>	Interested party representation (8)	22 September 2023
<b>15</b>	Interested party representation (9)	28 September 2023
<b>16</b>	Interested party representation (10)	02 October 2023
<b>17</b>	Interested party representation (11)	28 September 2023
<b>18</b>	Interested party representation (12)	28 September 2023
<b>19</b>	Interested party representation (13)	28 September 2023
<b>20</b>	Interested party representation (14)	02 October 2023
<b>21</b>	Interested party representation (15)	28 September 2023
<b>22</b>	Interested party representation (16)	27 September 2023
<b>23</b>	Interested party representation (17)	27 September 2023
<b>24</b>	Interested party representation (18)	29 September 2023
<b>25</b>	Interested party representation (19)	27 September 2023
<b>26</b>	Interested party representation (20)	26 September 2023
<b>27</b>	Interested party representation (21)	27 September 2023



28	Interested party representation (22)	27 September 2023
29	Interested party representation (23)	22 September 2023
30	Interested party representation (24)	26 September 2023
31	Interested party representation (25)	28 September 2023
32	Interested party representation (26)	01 October 2023
33	Interested party representation (27)	26 September 2023
34	Interested party representation (28)	25 September 2023
35	Interested party representation (29)	02 October 2023
36	Interested party representation (30)	28 September 2023
37	Interested party representation (31)	27 September 2023
38	Interested party representation (32)	27 September 2023
39	Interested party representation (33)	01 October 2023
40	Interested party representation (34)	23 September 2023
41	Interested party representation (35)	22 September 2023
42	Interested party representation (36)	26 September 2023
43	Interested party representation (37)	25 September 2023
44	Interested party representation (38)	26 September 2023
45	Interested party representation (39)	28 September 2023
46	Interested party representation (40)	28 September 2023
47	Interested party representation (41)	25 September 2023
48	Interested party representation (42)	26 September 2023
49	Interested party representation (43)	25 September 2023
50	Interested party representation (44)	22 September 2023
51	Interested party representation (45)	28 September 2023
52	Interested party representation (46)	02 October 2023
53	Interested party representation (47)	28 September 2023
54	Interested party representation (48)	21 September 2023
55	Interested party representation (49)	25 September 2023
56	Interested party representation (50)	27 September 2023
57	Interested party representation (51)	29 September 2023
58	Interested party representation (52)	26 September 2023
59	Interested party representation (53)	28 September 2023
60	Interested party representation (54)	28 September 2023
61	Interested party representation (55)	12 September 2023



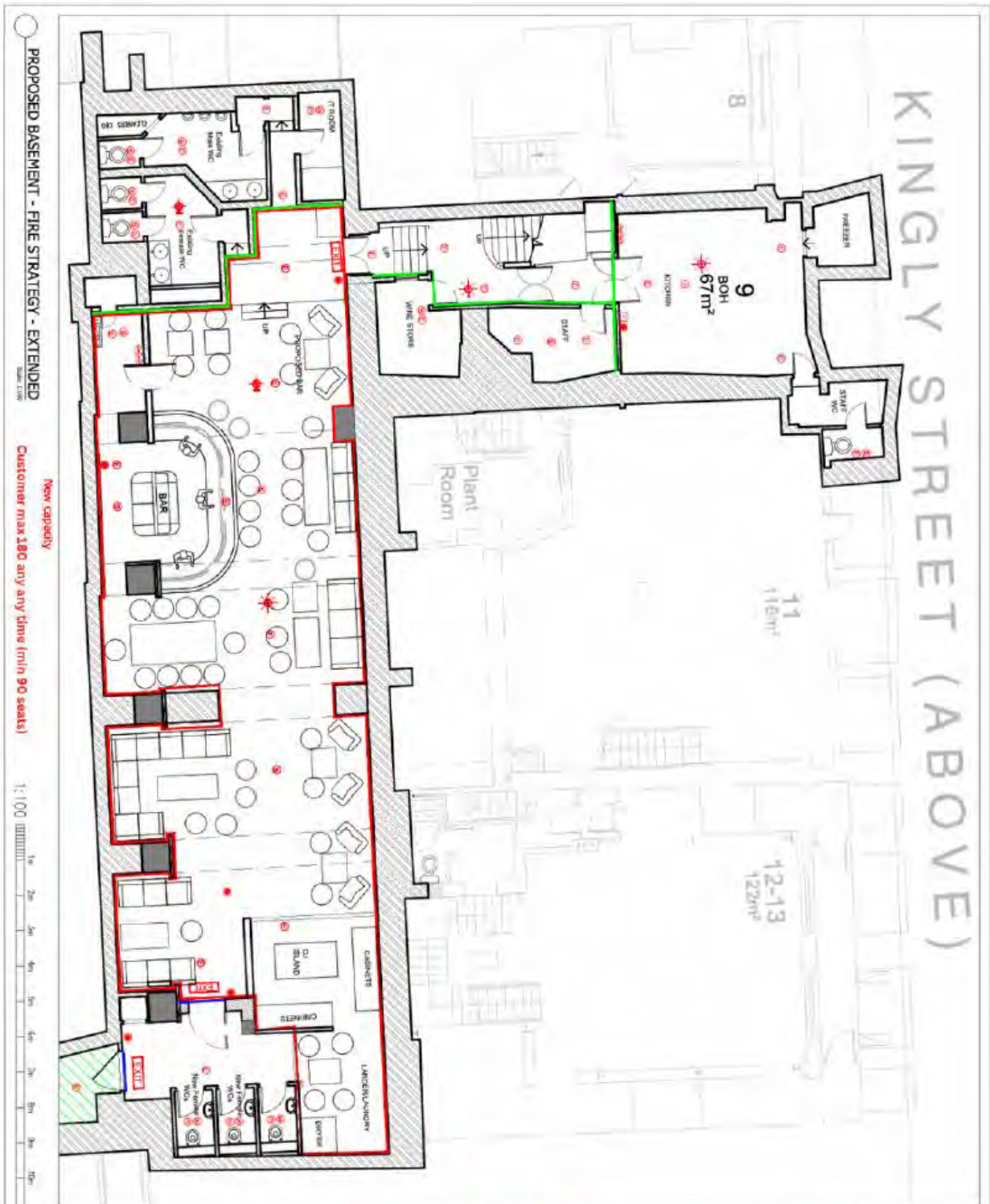

**PROPOSED BASEMENT - FIRE STRATEGY - EXTENDED**  
Scale 1:100

**Customer max 180 any any time (min 90 seats)**  
New capacity

1m 2m 3m 4m 5m 6m 7m 8m 9m 10m

**FIRE ALARM SCHEDULE**

- FIRE ALARM WALL INDICATED WITH BREAK
- BREAK WHEN 75mm TO GROUND SURFACE OF THE
- AUTOMATIC FIRE ALARM COMBINED SMOKE
- SMOKE DETECTOR
- HEAT DETECTOR
- EMERGENCY LIGHT
- FIRE ALARM INTERFACED UNIT/SIGNAL
- THE ALARM INDICATE INDICATOR

**FIRE COMPARTMENTATION**

- EXIT: ESCAPE ROUTE ALL IN ACCORDANCE WITH
- 60 MINUTES FIRE RESISTING CONSTRUCTION
- 30 MINUTES FIRE RESISTING CONSTRUCTION
- FIRE ESCAPE ROUTE

**GENERAL NOTES/LEGEND**

- NON FIXED FURNITURE AND FITS EQUIPMENT IS
- INDICATING AND SUBJECT TO CHANGE
- REAR DIVISION WALL
- WALL ON LEASABLE ACTIVITIES
- STAIRWAYS AREA

**CHAMP**  
4, 4-11 FLEET STREET, LONDON, NW1 2JX  
020 7420 0000  
www.champfire.com

DATE: 14/10/2022 SCALE: 1:100 DRAWN: OMO  
REV: 01 30/04/2023  
PROJECT: Proposed Basement Floor Plan  
Fire Strategy - Extended  
9 Kingly Street  
London W1

PROPOSED GROUND FLOOR - LAYOUT

DATE: 12.12

Scale: 1:100

**FIRE ALARM SCHEDULE**

- FIRE ALARM WALL MOUNTED WITH BEAM SENSITIVE TO MATCH EXISTING SYSTEM
- ☀ AUTOMATIC FIRE ALARM COMPANED SMOKE DETECTING COMPONENTS SENSITIVE TO MATCH EXISTING SYSTEM
- ⊗ AUTOMATIC FIRE ALARM COMPANED SMOKE DETECTING COMPONENTS TO MATCH EXISTING SYSTEM
- ⊕ SMOKE DETECTOR
- ⊖ HEAT DETECTOR
- ④ EMERGENCY LIGHT
- ⊚ FIRE ALARM DETECTOR CENTRAL
- ⊙ FIRE ALARM REPORT RECIPIENT

**FIRE COMPARTMENTATION**

- EXIT ESCAPE ROUTE ALL IN ACCORDANCE WITH ESCAPE TO 1999 AND THE APPROVED DOCUMENTS
- EXIT FIRE ESCAPE ROUTE
- EXIT FIRE ESCAPE ROUTE
- EXIT FIRE ESCAPE ROUTE
- EXIT FIRE ESCAPE ROUTE
- EXIT FIRE ESCAPE ROUTE

**GENERAL NOTES/LEGEND**

- EXIT NON FIRE RESISTANT AND FIRE EQUIPMENT IS PRESUMED AND SUBJECT TO CHANGE
- EXIT NEW OFFICE WALL
- EXIT AREA OF UNFINISHED WORKING
- EXIT UNFINISHED AREA

**PROPOSED BAR**

9 Kingsly Street  
London, W1

**GHMRP**  
Ground Floor Plan  
Fria Strategy

DATE: 12.12.2024  
SCALE: 1:100  
DRAWN BY: [REDACTED]  
CHECKED BY: [REDACTED]



Thomas & Thomas  
Partners LLP

9-11 Kingly Street  
London W1B 5PH

**SUMMARY OF PROPOSALS**

**THOMAS & THOMAS PARTNERS LLP**  
**38A MONMOUTH STREET**  
**LONDON**  
**WC2H 9EP**

**Reference: AT/SHA.30.101**

**Solicitors for the Applicant**

## Introduction

1. Shaftesbury AV Limited (“**Shaftesbury**”) is the freehold owner (and current licence holder) of the premises at 9 Kingly Street, which operated most recently as ‘The Court’, a bar albeit with a membership condition and a requirement for music and dancing. The premises has also previously operated as a late-night striptease venue. There is an existing premises licence, **with the sale alcohol authorised to 3am Monday to Friday**, midnight on Saturday and 10.30pm on Sunday, and opening hours to 3.30am Monday to Friday, 12.30am on Saturday and 11pm on Sunday
2. Shaftesbury have made this application for a new licence jointly with Little Door & Co Limited (“**Little Door**”). Once granted, the licence will be transferred into the sole name of Little Door and the existing licence surrendered.
3. The proposals are to open the premises as the second **Little Door** venue in Soho (and the fifth in London), with a substantial food offering, and with **earlier overall opening hours than the existing licence**. The application follows the grant of planning permission earlier this year (23/00990/FULL), and pre-application advice (22/10842/PREAPM).

## Little Door

4. A Little Door brand document and accompanying overview are enclosed for the Sub-Committee, to help give a sense of the Little Door business. Their concept is to create a welcoming “home” environment at their venues, centred around a fictional flat share. Their venues are fun, relaxed and heavily focused on customer safety and safeguarding, with a core demographic of professional women aged 25-35, but with customers of all ages. Dining is a key part of the concept, alongside drinks, and homely activities like board games and video games. They opened their first pilot venue in Notting Hill in 2014, and have gone from strength to strength since. They now have four venues across London – The Little Blue Door in Fulham, The Little Orange Door in Notting Hill, The Little Yellow Door in Clapham and (most recently) The Little Scarlet Door in Soho. All have late licences, and all have become much-loved institutions in their respective neighborhoods.
5. The Little Scarlet Door in particular has operated without problem until 3am at the weekends for the last 18 months, in a much more challenging area of Soho, on Greek Street. A report by the former police specialists at Leveche Associates is also enclosed for the Sub-Committee, recording covert observations of The Little Scarlet Door on a Saturday night, as well as the area around 9-11 Kingly Street itself. They found “*Little Scarlet Door to be well run and operating with no issues and without its customers contributing to any cumulative impact in the surrounding area.*”<sup>1</sup>

---

<sup>1</sup> Paragraph 17.



## The application

6. The new premises licence is requested to allow Little Door to operate a more balanced, open use throughout the week. It would **differ** from the current licence by:
- a) **reducing the hours of licensable activities Monday to Friday to 1am (from 3am)** and increasing to 1am (from midnight) only on Saturday, with Sunday left unchanged;
  - b) reducing the opening hours Monday to Friday to 1.30am (from 3.30am) and increasing to 1.30am (from 12.30am) only on Saturday, with Sunday left unchanged;
  - c) removing conditions 10 - 12 (Rules of Management), 20 & 21 (membership), and 13 -17 and 22 (various), and **replacing them with a suite of modern and appropriate model conditions**;
  - d) increasing the capacity to **no more than 180** (from 150) – the previous application was 220;
  - e) providing for a **minimum of 95 seats** at any time; and
  - f) updating the layout of the premises in accordance with the enclosed plans, including changes to fixed seating, the addition of model conditions and an increase in WC provision.
7. Shaftesbury applied to vary the existing licence earlier this year. At that stage, Shaftesbury was the sole applicant, as Little Door did not have a legal interest in the premises. In what was acknowledged to be a finely balanced decision, the Sub-Committee refused that application at a hearing on 11 May 2023. The application for a new licence this time is **on different terms**. In particular:
- a) The capacity **is only to be increased to 180**, rather than 220. This is only a **20% increase**, compared to the 46.67% increase applied for before and authorised by the planning permission.
  - b) There is to be no change to the hours or licensable activities on Sundays (last time an extension for alcohol service to 11pm was requested, alongside the addition of regulated entertainment).
  - c) Little Door will be the tenant and operator, and the nature of the proposed operation has changed significantly. The proposal is for a more relaxed use of the premises, with more of a focus on food, and less on music and dancing (both compared to the previous application, and the existing licence):
    - i. There will be **minimum seating provision of 95** at all times, secured by condition;
    - ii. The operation will have a **substantial food offering** throughout, again secured by condition. Page 15 of the brand document gives a flavour of Little Door's food concepts.

- iii. The Operational Management / Plan Dispersal policy is now also secured by condition, and has been updated and bolstered to reflect Little Door's operation – including their careful door management and customer safeguarding, and over 23s policy.

d) This has all resulted in there now being **overwhelming public support**.

8. Even though the capacity is much lower and Sunday is not being extended, the same significant reduction in hours is proposed, Monday to Friday. This means there is a much greater net reduction in late-night drinking capacity compared to the previous application, as we show below.

### Interested parties

9. The public response this time has been overwhelmingly and universally positive, with 54 representations in support, and not a single objection. This follows an extensive public consultation process by Shaftesbury about the amended proposals, following the Sub-Committee's decision in relation to the previous application.
10. The level of public support - and indeed the nature of the Little Door business and its customers - is perhaps best typified by the representation from [REDACTED] The Little Scarlett Door, which has a 3am licence. She says:

*[REDACTED] existing Little Door bar. I also love to go to Little Scarlet Door with my friends for cocktails. I've never had any issues with noise [REDACTED], and the type of crowd the bar attracts are always civil and respectful. It's always well managed and I've never seen any trouble.*

*One of the main reasons [REDACTED] to outstanding independent restaurants and nightlife. I believe this will be a great addition to Soho and is just the vibe we need.*

*I think their new venue will greatly promote the licensing objectives."*

11. And from [REDACTED]:

*"It looks like they will be much more welcoming and relaxed than some other venues in Soho, which can sometimes be intimidating, especially as a woman.*

*Venues like this attract a better balance of people out at night, who behave responsibly and do not drink too much. Ultimately, I have always had a great time there with great people. [REDACTED] I have never had any problems with noise or disturbances [REDACTED]."*

12. And from [REDACTED]:

*"It is a chilled place where there is no trouble and you can spend the whole night, without having to worry about people bothering you. [REDACTED], the venue is clean and vibrant, the staff are friendly and plentiful so it feels safe and their noise level [is] always respectful towards the community."*

13. And from [REDACTED]:



*"I have visited The little Scarlet door on Greek Street and love the atmosphere, we have spent quite a few evenings through summer just sitting watching the world go by. [REDACTED] and felt safe and comfortable also welcome which also makes a huge difference, another Scarlet door would be a welcome addition to the area (I think). we need more safe and comfortable venues in Soho where you can go and enjoy a drink and food with friends"*

14. And from [REDACTED]:

*"I have been to the Little Scarlet Door on Greek Street and thought it was a lovely place to have a few cocktails and a bite of food without the raucous crowds one usually finds in the middle of Soho. The staff were incredibly friendly and I felt right at home, as per the concept.*

*Soho needs more places one can spend their evening in a relaxed atmosphere, without any trouble and venues like this attract a better balance of people who behave responsibly and do not drink too much."*

15. And from [REDACTED]:

*[REDACTED] I go there often because it's safe for females, has good security, no disturbances outside, and is very clean.*

*Also since it has food and drinks and lots of seating, it's a place I can spend the whole evening without having [to] move locations.*

*The owners sand staff are responsible and friendly."*

16. In short, the representations convey the public view that Soho will be improved and made safer by the addition of a second Little Door venue at 9-11 Kingly Street, because of the experience they offer, the standards they maintain and the type of customer they attract. This chimes with the experience of the other Little Door venues in their respective communities.

### **Responsible authorities**

17. As an initial point, we should flag that the police refer to the terms of the previous variation application at the start of their representation (with an increase of capacity to 220 and extension of hours on Sunday), and then seemingly base some of their substantive comments on aspects of that application, rather than the new one. In paragraph two, they note their concerns about a 46.67% increase in capacity – but that was the increase previously applied for. Only a 20% increase in numbers is proposed in this application.

18. Moreover, while the police are correct that a straightforward increase in capacity would on its own prima facie be contrary to policy, here post-Core Hours drinking capacity weighted by hours will actually be decreasing very significantly, owing to the dramatic reduction in hours Monday to Friday. As shown in the table below, the new licence **will reduce drinking hours** in the West End after Core Hours by 1110 hours every week. That amounts to 57,720 hours less drinking capacity in the West End beyond Core Hours every year:

<u>Current licence</u>	Mon	Tues	Wed	Thur	Fri	Sat	Sun
a) Drink hours post Core Hours	3.5	3.5	3.5	3.5	3	0	0
b) Capacity	150	150	150	150	150	150	0
c) Drinking capacity weighted by hours (a x b)	525	525	525	525	450	0	0

Post-Core Hours drinking capacity weighted by hours	2550
---	------

<u>New licence</u>	Mon	Tues	Wed	Thur	Fri	Sat	Sun
a) Drink hours post Core Hours	1.5	1.5	1.5	1.5	1	1	0
b) Capacity	180	180	180	180	180	180	0
c) Drinking capacity weighted by hours (a x b)	270	270	270	270	180	180	0

Post-Core Hours drinking capacity weighted by hours	1440
---	------

<b>WEEKLY NET REDUCTION</b>	<b>1110</b>
-----------------------------	-------------

19. This net reduction is supported by policies CIP1.A.2, D18 and PB1.B and C, as we explain below. An alternative way of thinking about this is that the premises' drinking capacity is being reduced from 150 to zero after 1am, Monday to Friday, while only being increased by 30 before 1am.
20. The net reduction here is 63% greater than under the previous application (where it was 680 hours per week), because of the much smaller increase in capacity pre-1am that is now proposed, and the fact that no change to the hours is now proposed on Sunday.

### Policy

21. Policy CIP1 is only a rebuttable presumption that the Licensing Authority should refuse applications for certain types of premises in the West End Cumulative Impact Zone. The presumption does not apply to variations within Core Hours or (importantly, here) to reduce the overall capacity of the premises.
22. In addition to the exception in CIP1 regarding reductions in capacity (at paragraph A.2), Paragraph D18 also provides an exception:

*"The council will consider [...] whether offers to reduce capacities, actually do effectively address the underlying reasons for a policy on cumulative impact. There would have to be substantial reductions in relation to the capacity at which premises had actually been operating. Any proposals for later hours which offer reducing the capacity will have to be shown to lead to a reduction in cumulative impact and represent genuine reductions in the actual number of people using the premises at its peak times and late at night and not on days or at times when the premises are less busy. The later the hours sought, the more significant the reduction in capacity would have to be [emphasis added]"*.

23. The premises use policy for bars at PB1.B and C reinforces this further, making clear that applications to



reduce overall capacities within the West End CIZ will generally be granted. (It is worth noting that – notwithstanding the lax membership conditions, which are proposed to be removed – the premises here are already a bar under PB1, as a proprietary premises run for profit (see policy paragraph F106).)

24. The cumulative impact policy of course also rightly recognises it may be overridden in “*exceptional circumstances*”<sup>2</sup>, and it is not possible to give a “*definitive*” list of circumstances when such exception should be made.<sup>3</sup> Indeed, the Authority must “*always consider the individual circumstances of the application; even where an application is made for a proposal that is apparently contrary to policy*”.<sup>4</sup>
25. As to the “*underlying reasons*” for the cumulative impact policy: the policy explains that “*the cumulative impact of the concentration of late night and drink led premises and/or night cafés has led to problems of disorder and/or nuisance affecting residents, visitors and other businesses.*”<sup>5</sup>
26. The policy elaborates on this by explaining that: “*The extent of crime and disorder and public nuisance in the West End Cumulative Impact Zone arises from the number of people there late at night; a considerable number of them being intoxicated.*”<sup>6</sup>

#### **Applying the policy to this application**

27. Per paragraphs A.2 in CIP1, D18 and PB1.B and C, the significant net reduction in late-night drinking capacity here is alone sufficient to constitute an exception to policy – as it will mean “*genuine reductions in the actual number of people using the premises at its peak times and late at night*” (per the language in D18). This addresses the underlying reasons for the policy, as it will be reducing the number of “*intoxicated*” people “[in the West End CIZ] *late at night*” (per paragraph D4). As the Leveche report notes, “*customers will be able to drink for much fewer hours overall*”.<sup>7</sup>
28. The reductions apply throughout the week, including two hours at peak time on Friday – compared to just the single hour changed on Saturday - and the resulting 1110 hour net reduction in drinking capacity post-Core Hours every week is indubitably a “*substantial reduction*” (again, per the language in D18).
29. Indeed, the police acknowledge that “*the reduction in hours offered may mitigate an element of risk*”. They say as a counterpoint that “*the crime figure for Friday and Saturday nights are historically high*” – but that makes it all the more significant that the reduction in hours proposed on Friday is double the increase on

---

<sup>2</sup> As acknowledged by the policy at D11.

<sup>3</sup> At D15.

<sup>4</sup> See D11 and D12 in the policy, as well 14.44 in the revised guidance under section 182. As the High Court noted in *R (JD Wetherspoon) v Guildford Borough Council* [2006] EWHC 815 (Admin) (at 73): “*a reversed burden of proof does not preclude consideration of the merits of the application*”.

<sup>5</sup> At D4.

<sup>6</sup> At D4

<sup>7</sup> At paragraph 64.

Saturday.

**Further exceptional circumstances**

30. Beyond this reduction in late-night drinking capacity – which is sufficient on its own under the policy - there are further exceptional circumstances of the application supporting grant here:

1) A changed operation that will better promote the licensing objectives, secured by new conditions

31. The nature of the operation is being changed in a manner that will better promote the licensing objectives, and this is reflected in the modernised and bolstered set of conditions:

- a) The police express concern about the removal of condition 22, as they say vertical drinking is more of a risk than seated drinking. But this existing condition does not stop vertical drinking. All it does is require alcohol to be supplied by way of table service, with customers then free to roam (and dance) as they wish.

This application proposes a minimum seating provision of 95 at all times (not just at 11pm) and a requirement for substantial food availability throughout. The proposal is for a more relaxed use of the premises, with more of a focus on food, and less on music and dancing - but with the flexibility that people can be served at the bar, as well as via waiter service.

This more measured use will better promote the licensing objectives, as compared to an operation focused on serving high-margin bottles of spirits or champagne to groups at tables in a “high-octane”, dance-led environment until 3am five nights a week. To quote a resident from Old Compton Street again, describing The Little Scarlet Door in Soho:

*“It is a chilled place where there is no trouble and you can spend the whole night, without having to worry about people bothering you.”*

- b) Other new and extensive model conditions.

2) A changed operation where people are less likely to become victims of crime

32. The police also express a concern about customers becoming victims of crime when they disperse. But the more relaxed use, attracting more responsible customers, and at earlier hours overall will mean less late-night drinking and reduced levels of intoxication compared to the current licence, and therefore reduced vulnerability to crime. There is also no evidence that customers from the existing Scarlet Door have been victims of crime, despite it operating to later hours than proposed under this application, in a more challenging area of Soho.



33. The Little Door are the type of destination premises where people come to spend a relaxed, fun evening – not as a base for getting drunk, and “bar hopping” elsewhere. This is reflected throughout the public representations, and also the covert observations of Leveche, who note in relation to the customers of The Little Scarlett Door at 2.43am on Saturday evening/Sunday morning:<sup>8</sup>

*“Customers left in a controlled manner, quietly and with no signs of them being heavily intoxicated. I did not see any customers migrating to other premises and none of the customers appeared vulnerable to becoming victims of crime.”*

34. And supported by the easy and natural dispersal routes out of the western edge of Soho:<sup>9</sup>

*“The dispersal routes for the customers in the Kingly Street area tended to take them towards Regent Street, Great Marlborough Street and Beak Street where they had good access to the 24-hour transport network.”*

35. Little Door have exacting standards when it comes to operational management, particularly regarding its door policy and dispersal – and this is reflected in the new policy, secured by condition. Per paragraphs 5.7 to 5.9 in that policy, entry will generally be for those over 23 only, and safeguarding will be prioritised, with no tolerance for drunkenness.

3) A surrounding estate that is very different from other areas in the West End

36. Shaftesbury is a majority stakeholder in Carnaby, with a unique and bespoke policy of fostering and maintaining local culture, and the local economy. They closely curate and manage the Carnaby estate, to promote security and safeguarding for all of their tenants and their customers. This has been successful in keeping incident levels at a much lower level than other areas in the West End, as well as turning Kingly Court and Kingly Street into a destination for experiential, casual dining and leisure concepts, attracting a more responsible crowd.

37. Little Door have shown themselves more than capable of operating with a much later licence, in a much more problematic area of Soho (on Greek Street), without the layers of protection offered on Shaftesbury’s estate, and without adding to cumulative impact. Here, the environment will be much more benign. Shaftesbury’s ongoing controls include the following, all of which are assured in the dispersal policy:

- a) 24/7 estate security, comprising security patrols by CSAS qualified personnel and an extensive CCTV network;
- b) membership of the Safer West End Business Crime Reduction Partnership;
- c) a dedicated estate management team, with close and regular contact with principals and on-site staff;

---

<sup>8</sup> At paragraph 48.

<sup>9</sup> At paragraph 63.i. of the Leveche Report.

- d) tenant radio links to the police and estate security, together with organised lines of communication for notification of emergencies and to share information between tenants, managing agents, the responsible authorities and estate security; and
- e) promotion of safe places, to support those who may be vulnerable as a result of intoxication or other issues associated with the night-time economy.

## Conclusion

38. This application requests a new licence to allow Little Door to operate a more balanced use at the premises compared to the existing licence, and on very different terms to the previous proposals:

- a) The new licence will dramatically **reduce** late-night drinking in the West End overall, which is supported by policy.
- b) There has been a sea-change in circumstances since the last application.
- c) There will be a more relaxed use of the premises, with more of a focus on food, and less on music and dancing, with will better promote the licensing objectives, all secured by a modernised set of new conditions. The new operation is also less likely to result in people being vulnerable to crime than under the existing licence.
- d) There is overwhelming public support for the application and Little Door, from residents in Soho, Westminster and London more broadly – and no objections.
- e) And this is all in the context of an estate on the western edge of Soho which is carefully managed and safeguarded by Shaftesbury, in circumstances where Little Door have shown themselves more than capable of operating in a much more challenging environment and to later hours, without adding to cumulative impact.

**Thomas & Thomas Partners LLP**

**November 2023**





# Little & Door & Co.

BRAND DOCUMENT

2023



# LITTLE DOOR & CO.

We are a young, growing brand pioneering a new slant on the hospitality industry. Our aim is to create venues which feel like walking into a home by styling them around a fictional flat share. The result is a bar and restaurant concept which is welcoming, inviting and unpretentious. The concept is creative and quirky in its delivery without ever being forced or overly theatrical.

We ran a pilot site in Notting Hill with overwhelming success for over 2 years, having been voted by Zagat as one of the top 8 bars in London.

In May 2018, we opened The Little Blue Door on Fulham Road, a 220 capacity split-room site on a long lease, already achieving profitability and a mention on Tatler Magazine's "Best Bars in London" within 6 weeks of opening.

In April 2019, we re-opened The Little Yellow Door in a split level site off the iconic Portobello Road in Notting Hill. Stylised on our original pop-up, our second permanent site has become Notting Hill's favourite bar spot!

In July 2020, we then opened our third venue, The Little Orange Door, on Clapham Common. Despite opening in the midst of a pandemic, it's already a firm neighbourhood favourite.

And now in 2022, we opened our first ever central London venue with a capacity of 200 on buzzing Greek Street. Split across two floors, the venue is inspired by New York loft style apartments blended with British quintessential quirks. This has been our most ambitious opening to date.



“ Little Door & Co creates an authentic customer experience through a series of house parties & dinner parties in a fun & intimate environment, for those after a homely, neighbourhood style experience ”





# GROWTH PLANS

Over a two and a half year period, the pilot site, The Little Yellow Door had an overwhelmingly positive reception - from both the media and punters, far and wide. What's more, it proved an exciting, varied business model with strong financial results.

The vision is to have a range of different 'Little Doors' around London; "The Little Black Door", "The Little Neon Door", "The Little Striped Door". Each venue would keep the central brand concept of being a flat share, styled to resemble someone's house.

However, within these parameters, each coloured door would have its own identity which would reflect its location and target demographic.

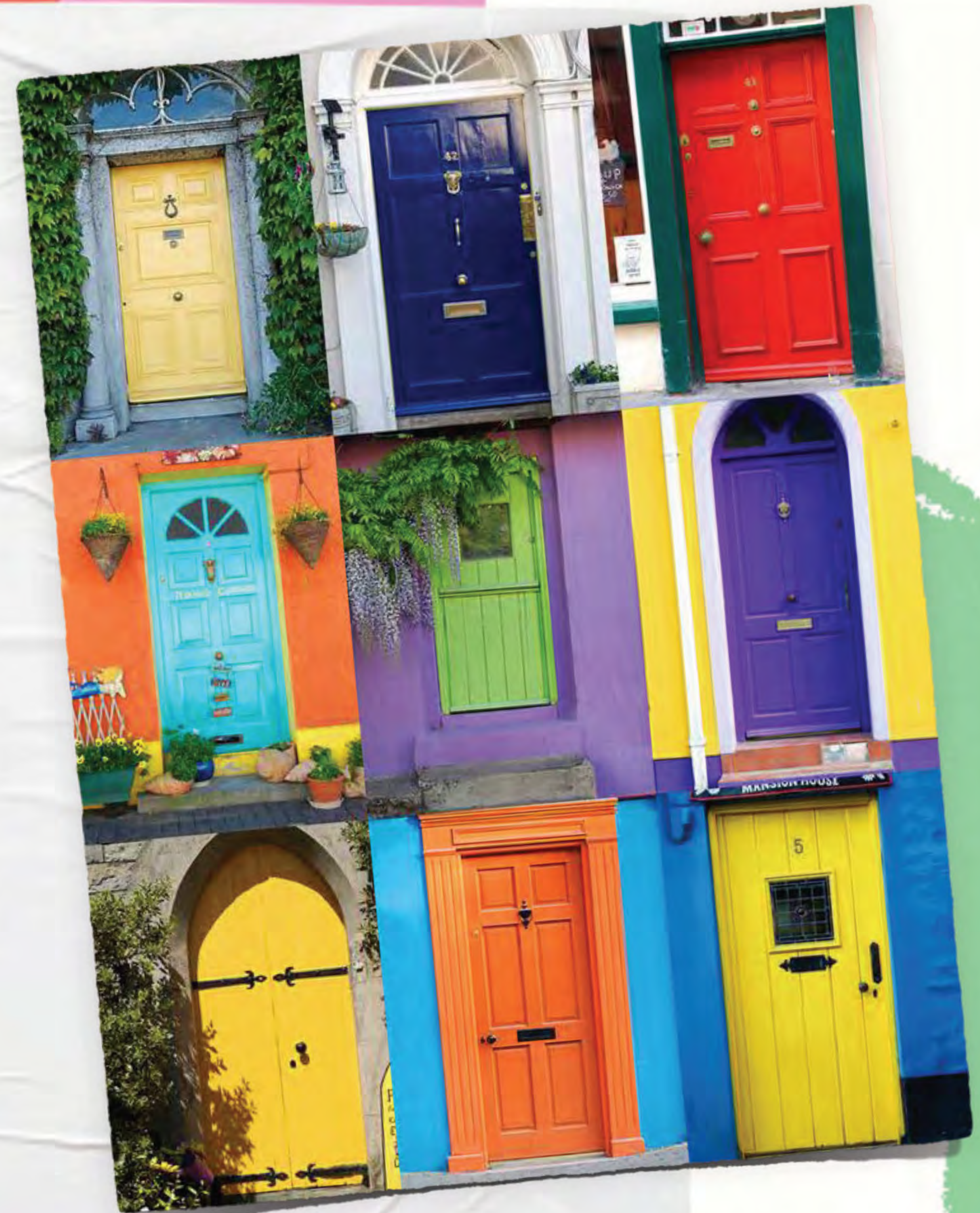



# THE PILOT SITE

The Little Yellow Door at No.68 was a concept venue in Notting Hill Gate which opened in October 2014.

It is based on a flat-share, where 4 fictional flatmates live together and invite their friends round for house parties & dinner parties.

It functioned as a bar and restaurant.

800 ft<sup>2</sup> of commercial space on the 1st floor with office, kitchen and flats on the 2nd & 3rd floor.

**Capacity:**

85 Operational

**Team Size:**

10

**License:**

1am Monday-Saturday.

12am Sunday





# THE LITTLE BLUE DOOR

The Little Blue Door is a continuation of the brand and Little Door and Co's first venue on a long term lease.

It opened in May 2018 and quickly achieved top press and is already established as a firm Fulham favourite.

Like our pilot site, it functions as a bar and restaurant with added weekend day trade and a multi-room offering.

200 m<sup>2</sup> of commercial space on the ground floor across multiple rooms, including an aesthetic kitchen, living room and private study.

## Capacity:

220 Operational

## Team Size:

20

## License:

1:00am Friday -Saturday.

12:00am Sunday-  
Thursday





# THE LITTLE BLUE DOOR LOOK & FEEL





# THE LITTLE YELLOW DOOR

The Little Yellow Door is Little Door & Co's second permanent opening in a split level venue off the iconic Portobello Road in Notting Hill.

It opened in April 2019, quickly drawing in top press as one of London's most hotly anticipated restaurant and bar openings.

160 m<sup>2</sup> of commercial space across 2 floors including an upstairs living room /aesthetic kitchen, and a downstairs den.

It is now firmly established as Notting Hill's favourite evening spot, with a large growing community of regulars and devotees.

**Capacity:**

180 Operational

**Team Size:**

20

**License:**

2:00am Friday -Saturday.

1:00am Sunday-Thursday





# THE LITTLE YELLOW DOOR UPSTAIRS LOOK AND FEEL





# THE LITTLE YELLOW DOOR DOWNSTAIRS LOOK AND FEEL





# THE LITTLE ORANGE DOOR

The Little Orange Door is the third permanent opening for Little Door & Co, housed in an entire building opposite Clapham Common.

It was set to open in April 2020 but the launch was postponed to July due to the lockdown. Despite opening under covid restrictions, it had a roaring start and has consistently gone from strength to strength. It is now a firm neighbourhood favourite in south west London.

There is 200m<sup>2</sup> of tradable space – split into many areas including a kitchen, sitting room, conservatory and games space. Upstairs contains the kitchen, back of house and large office housing our Head Office team.

**Capacity:**

190 Operational

**Team Size:**

25

**License:**

2.30am Thursday – Saturday

1am: Sunday – Wednesday





# THE LITTLE ORANGE DOOR LOOK AND FEEL





# THE LITTLE SCARLET DOOR

The Little Scarlet Door is our fourth permanent opening for Little Door & Co, situated in the melting pot of London's night life; Soho!

Its doors opened in late June 2022 in one of the most sought after streets in central London. It was a thrill to conceptualise a two storey venue unlike any of its other neighbourhood siblings.

Inspired by New York's loft apartments, this space contrasts the quintessential British quirks of our other Little Doors. Industrial finishes can be found on both floors of the venue, with the first floor's open plan living room and kitchen space being the ideal spot for cocktails and conversation on one of our gorgeous sofas or at the kitchen bar. Afterwards, head downstairs to the basement studio, where you'll find an array of curated pop-art, another long cocktail bar and plenty of spots to settle into for the evening.

We have quickly become well-established within the Soho community.

## Capacity:

220 Operational

## Team Size:

25

## License:

1am: Sunday – Thursday

3am: Friday – Sunday





# THE LITTLE SCARLET DOOR LOOK AND FEEL





# THE EXPERIENCE

- A night at one of our venues is going to be a bit different to what customers normally expect.
- Our private rooms are popular with groups and special occasions with each offering something different and little more fun than your usual corporate dining room.
- Our world famous "Emoji Menu" was made entirely out of smartphone emojis for our guests to decipher, before "whats-app"ing their order to one of our waiters!
- All our homes have various fun games and activities; pool tables, board games and even classic N64s. They are part of the furniture and riff on the competitive socialising trend.
- Our welcoming atmosphere encourages regulars, a select few have personalised mugs!
- Or you could just have a cocktail...







## OUR FOOD

- Every night's offering is different and changes according to how things work in a home - think "The Ultimate Dinner Party" on Thursday nights.
- Our food draws inspiration from our most popular home-style dishes from our favourite flatmates, past and present. Designed with sharing and bonding in mind, our menus are compiled of deliciously recognisable comfort food with a twist.
- Memorable dishes have been Smokin' Hot Thunder Thighs, home smoked chicken with garlic and tarragon aioli, the ultimate salt and pepper squid, our melted Toblerone caramel chocolate fondant and the infamous Cam'N'Bert, a melted cheese dish with pear and truffle honey.

“It's showing off, really confident, reassuringly complex cooking Mr Hyde ”



# OUR DRINKS

- The cocktails are inspired by our DVD collection.
- Past favourites have included "Crimes of Passion" with infused vodka, passion fruit and prosecco and our very own take on the Espresso Martini, "Coffee and Cigarettes".
- We have a great track record with our 5 main drinks sponsors, with featured cocktails frequently appearing on our menus across the board.





TOP PRESS ACHIEVED

ZAGAT®

marie claire

BAZAAR<sup>Harper's</sup>

VOGUE

London  
Evening  
Standard

BUSINESS  
INSIDER

SUITCASE

TRAVEL + FASHION

TimeOut





## *Jamie Hazeel*

Manages the Bars' Finances and Targets  
Directs F&B Content  
Co - Manages Business Development

Having run the business side of The Wandering Chef for the last 4 years as well as showing entrepreneurial appetite & business savviness since the age of 18, Jamie is well placed to lead the growth of this brand.

Delivered the much acclaimed HBO "Game of Thrones" dinner.

Ran his first highly successful restaurant in the Swiss Mountains at the age of 18.

Provided London's diners with over 100 of The Wandering Chef's critically acclaimed and imaginative food experiences



## *Kamran Dehdashti*

Manages Sales and Marketing  
Co - Manages Business Development

With strong hospitality experience in roles as Sales Director for Formula 1's official events company as well as the Ignite Group's portfolio of venues, he has great experience and networks to help grow the business.

1st Directorial position at the age of 29 for the official events arm of Formula 1

First entrepreneurial project, Roxx, has run over 200 events over the last 3 years.



# CONTACT DETAILS

KAMRAN DEHDASHTI

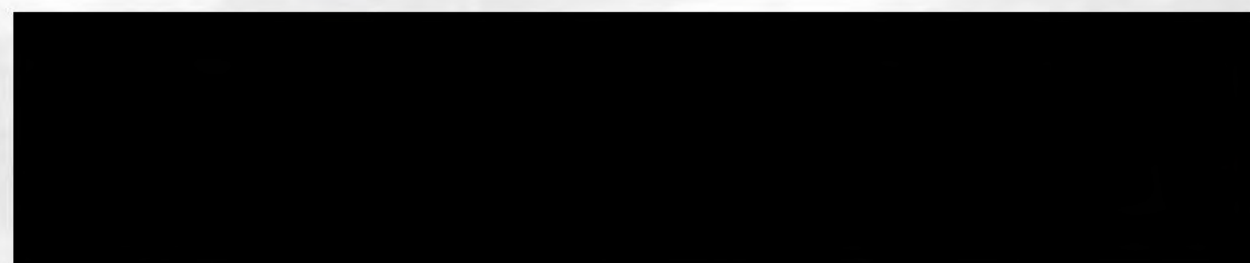

JAMIE HAZEEL

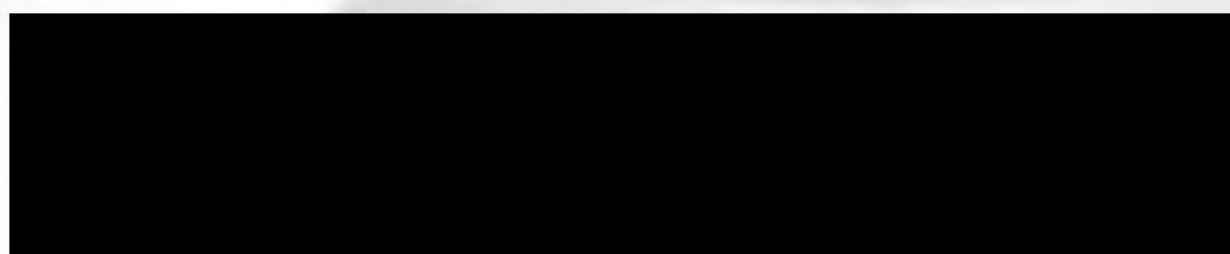

[www.thelittledoorandco.com](http://www.thelittledoorandco.com)







## 9-11 Kingly Street

### Licensing Hearing Info

#### Who We Are

- Little Door & Co is a London based Bar & Restaurant Group
- We create home style spaces based on fictional flat shares. It's a unique, friendly and welcoming concept. We're a cute brand, not a rowdy club or bar. We want people to feel at home.
- We're often referred to as a member's club without membership - because we create attractive, aspirational spaces which give people a feeling of belonging and homeliness.
- Food is a massive part of our offering, and a commitment to providing a genuine and rounded experience for our customers.

#### Where We Are and What We Are

- We have four much loved venues, which have all become part of the fabric of their local community:
  - The Little Blue Door, Fulham, opened in 2018
  - The Little Yellow Door, Notting Hill, opened in 2019
  - The Little Orange Door, Clapham, opened in 2020
  - The Little Scarlet Door, Soho, opened in 2022
- All our venues have late licenses. We pride ourselves on operating venues which feel and truly are safe. For us, it's not only an obvious necessity, it's part of our brand DNA.
- An absolutely crucial part of how we create a true feeling of home is by ensuring we are always providing a safe and secure environment - so our guest can feel as comfortable and welcomed with us as they would in someone's house.



- How we manage security, and our door, plays a massive part in that. If we aren't prioritizing safety above anything else, people will never feel at home. It's key to our concept.
- In that light, all our security & management teams are briefed to prioritize safeguarding the venue over everything else. This involves a zero-tolerance policy on drunkenness and never taking risks on letting in potential troublemakers.

### **The Little Scarlet Door: A Soho Case Study**

- The Little Scarlet Door is a flagship venue for us – and a large responsibility with a 3am license on one of London's busiest streets. We are so proud of what we've achieved there.
- Since opening we have had only strong and positive relationships with our neighbors, local authorities and nearby businesses.
- We have a core demographic of 25–35-year-old working professionals – with a much older demographic attending as well. Our min entry age is 23. We have been thrilled that such a broad spectrum of Soho's visitors have visited us – a true reflection of the area's social melting pot.
- Partially because of our emphasis on safety and security, our brand is loved by a female demographic - 80% of our Instagram followers are females between the ages of 23-35. This is particularly true at Scarlet Door.
- As a company - and particularly to ensure we are distinct on Greek Street - our priority is quality not quantity. We focus on product & experience over low prices, discounts, and high volume- things many of our competitor's push.
- For our brand to live and breathe, we're committed to creating a real community of regulars and forging strong links with local business and the communities we are in. We are so pleased with how fast and well we've achieved this objective in Soho.
- We've already attracted a high level of corporate collaborations including Universal Music, Warner Music, Ridley Scott and the Witcher Wrap party. This speaks to the quality and operational detail of the service we provide.

### **Kingly Street: A New Little Door**

- We love to design our spaces to respect the cultural and historical facets of that neighborhood - to be the perfect home away from home for that place.
- As such, we are very excited to imagine a new home rooted in the iconic district around Carnaby court and Kingly street – and to show the area some of our unique brand of hospitality.



- We are thrilled to be working with Shaftesbury Capital on this project. Their amazing reputation precedes them, and they've been fantastic partners to date. Shaftesbury's curation of Carnaby makes Kingly St a very safe place for our customers.
- What's more having a further premises in the West of Soho means our customers have more options and don't need to queue to get into our Greek St venue.





**9 Kingly Street  
London  
W1B 5PH**

## **Dispersal Policy**

**November 2023**



# 1 Introduction

- 1.1 This document is submitted by Shaftesbury AV Limited and Little Door & Co Limited in support of their Premises Licence application in respect of 9 Kingly Street, London W1B 5PH (“the Premises”).
- 1.2 Shaftesbury and Little Door are committed to ensuring a high standard of professional and responsible management. The management systems are designed to ensure that the Premises is ultimately operated successfully, sympathetically and without adversely affecting local residents or businesses.
- 1.3 The controls set out in this document will be subject to the conditions of the planning (where appropriate) and licensing regimes, placing emphasis on the promotion of the Licensing Objectives.
- 1.4 Specific conditions set out below form part of the Operating Schedule to the new licence application and are to be confirmed in relation the premises licence ultimately granted.
- 1.5 The standard operating hours for the Premises will be as follows:

	<b>Opening Hours</b>	<b>Sale of Alcohol</b>	<b>Regulated Entertainment</b>	<b>Late Night Refreshment</b>
	<b>Timings</b>	<b>Timings</b>	<b>Timings</b>	<b>Timings</b>
<b>Monday to Saturday</b>	09:00 – 01:30	10:00 – 01:00	09:00 - 01:00	23:00 – 01:00
<b>Sunday</b>	12:00 – 23:00	12:00 – 22:30	12:00 – 22:30	N/A



## 2 Planned Management Measures for Control of Noise

### Executive Summary

- 2.1 The proposed noise control measures are designed to minimise any potential nuisance to local residents or businesses.
- 2.2 The arrival and departure of customers from the Premises shall be managed in accordance with the Entry and Dispersal Policy at section 5 of this document. The management controls set out in the Entry and Dispersal Policy are designed to ensure a safe and relaxed environment inside the venue, and that all customers leave the area safely, and as quickly and as quietly as possible.
- 2.3 A Deliveries, Collections & Servicing Procedure seeks to ensure these activities have minimal, if any, impact on the local amenity. The relevant procedures are set out in section 7 of this document. The key objective of these procedures is to ensure residents and other businesses are not disturbed by noise from the Premises in accordance with the Licensing Objective: Prevention of Public Nuisance

### Prevention of Noise and Vibration

- 2.4 The objective of the management controls are to ensure residents are not disturbed by noise from the Premises in accordance with Policy PN1.
- 2.5 The Premises has historically been licensed for regulated entertainment: live and recorded music and the performance of dance.
- 2.6 Where deemed appropriate, suitably qualified SIA door staff will be employed at appropriate times, determined by a risk assessment, to provide security and uphold noise control measures.
- 2.7 The following conditions are offered as part of the Operating Schedule:
  - 2.7.1 *“The need for SIA licensed door supervisors must be risk assessed on an ongoing basis.”*
  - 2.7.2 *“Notices shall be prominently displayed at all exits requesting patrons to respect the needs of local residents and businesses and leave the area quietly.”*
  - 2.7.3 *“All windows and external doors shall be kept closed after 23:00 hours, or at any time when regulated entertainment takes place, except for the immediate access and egress of persons.”*
  - 2.7.4 *“No noise generated on the premises, or by its associated plant or equipment, shall emanate from the premises nor vibration be transmitted through the structure of the premises which gives rise to a nuisance.”*



- 2.7.5 *“Patrons permitted to temporarily leave and then re-enter the premises, e.g. to smoke or make a phone call, shall not be permitted to take glass containers with them.”*
- 2.7.6 *“Notices shall be prominently displayed at any area used for smoking requesting patrons to respect the needs of local residents and use the area quietly.”*



### **3 General Operational Controls**

3.1 The operator's management team will take their responsibilities as a neighbour very seriously. Management controls shall include:

3.1.1 Extensive employee induction and on-going refresher training, including:

3.1.1.1 Responsibilities in the local area and towards local residents.

3.1.1.2 Customer care and hospitality.

3.1.1.3 Complaint handling.

3.1.1.4 Food Safety.

3.1.1.5 Health and Safety.

3.1.1.6 Fire Safety.

3.1.1.7 Obligations under the Licensing Act 2003.

3.2 Operational procedures to mitigate nuisance in the local area, including:

3.2.1 Responsible management of customers in and outside the Premises.

3.2.2 Controlled management of the arrival of customers.

3.2.4 Controlling and supervising customer smoking (see section 4 below).

3.2.5 Sympathetic servicing of the Premises, see licence conditions for further details.

3.2.6 Internal CCTV coverage including full frontal imaging of anyone entering the Premises. At any given time, there will be at least one member of staff on duty who is fully trained to operate the CCTV system.



## **4 Smoking Policy**

- 4.1 The operator shall ensure that any patrons smoking outside the premises do so in an orderly manner and are properly supervised by staff so as to ensure that there is no public nuisance or obstruction of the public highway.



## **5 Entry and Dispersal Policy**

### **OBJECTIVE**

- 5.1 The objective of the Dispersal Policy is to ensure a quiet, controlled and swift dispersal of the Premises' customers.
- 5.2 By following this Dispersal Policy patrons will be managed professionally and responsibly to ensure they make their journey home without any adverse impact on our neighbours.
- 5.3 The Policy prevents public nuisance from the following risks:
  - 5.3.1 Noisy or anti-social behaviour by patrons leaving the Premises.
  - 5.3.2 Large numbers of people leaving the Premises at the same time.
- 5.4 The Policy also helps to ensure patrons make their journey home safely and do not become victims of crime. See further: "Safeguarding" below.

### **LOCATION**

- 5.5 The main entrance/exit of the Premises is located on Kingly Street. This entrance shall be monitored by reception staff inside the Premises during busy periods and late at night, where deemed necessary. Kingly Court (with no residential uses) is located to the rear of the Premises.
- 5.6 In the event of an emergency, a full fire evacuation plan will be in place.

### **ENTRY**

- 5.7 Entry is for those 23 and over only (subject to exceptions at the discretion of management, such as for a work social where certain employees are under 23). ID should be checked for anyone who looks under 25.
- 5.8 Guests will be carefully monitored for drunkenness, with those visibly drunk denied entry, together with the rest of their group. Anyone drinking in the queue will also be refused entry.
- 5.9 Maintaining a safe and relaxed environment inside the Premises is paramount. Chances should not be taken in letting in people whom the door staff suspect might be troublemakers or cause issues in the Premises. Staff should prioritise customer safeguarding at all times.

### **DEDICATED TELEPHONE NUMBER**

- 5.10 A dedicated telephone number for the designated premises supervisor or the duty manager will be maintained for use by any person who may wish to speak to an appropriate member of staff for any issues arising, including dispersal of patrons from the Premises at night, and this will be communicated at the outset to the local community.



## **DISPERSAL**

- 5.11 Customers are expected to depart the Premises in a gradual and controlled manner until close.
- 5.12 Towards closing time, the following measures are taken to ensure a gradual and quiet closure of the Premises. These may include:
  - 5.12.1 Raised lighting levels where appropriate.
  - 5.12.2 Reduced music levels where appropriate.
  - 5.12.3 Politely reminding customers the Premises is about to close.
  - 5.12.4 Asking customers if they require a taxi and advising customers to wait inside the Premises.
- 5.13 All exits have notices informing customers to respect local residents by leaving the area quietly and efficiently.<sup>1</sup>
- 5.14 Where appropriate, customers will be directed to nearby transport links and requested to leave quietly.

## **TRANSPORT**

- 5.15 Customers historically arrive and depart by various modes of transport, including by foot and private car.
- 5.16 When arriving by private car and if required, customers and drivers are reminded not to leave engines running unnecessarily, to keep conversation to a minimum and avoid slamming car doors.
- 5.17 The Premises are serviced by various public transport links, as set out below. All staff shall be familiar with the transport links so they can advise customers when required.

## **TUBE**

- 5.18 The following tube stations are located within an easy walking distance of the Premises, with a late night 24 hour tube service, in normal times, available on a Friday and Saturday:
  - a) Oxford Circus: 0.2 mile / 5 minute walk / Victoria, Central and Bakerloo Line
  - b) Piccadilly Circus: 0.3 mile / 6 minute walk / Piccadilly and Bakerloo Line
  - c) Green Park: 0.6 mile / 12 minute walk / Jubilee, Piccadilly and Victoria Line
  - d) Tottenham Court Road: 0.6 mile / 12 minute walk / Central, Northern and Elizabeth Line



- 5.19 Where necessary customers will be given directions to the relevant station and reminded to reach the station as quietly and as quickly as possible when they leave.

#### **BUSES**

- 5.20 The Premises is well serviced by public buses. TFL bus services go to a variety of destinations throughout London from nearby bus stops.
- 5.21 Bus routes include: 12, 22, 88, 94, 139, 159, 453, N3, N15, N22, N109, N113, N136

#### **TAXI**

- 5.22 Black cabs are available right through the day and night in the area or can be called by staff on any app based service.
- 5.23 The nearest taxi rank is on New Burlington Street (Samantha's) with a capacity for 4 vehicles. Further taxi ranks are located on nearby Regent Street (Heddon Street) with a capacity for 8 vehicles and Conduit Street with a capacity for 2 vehicles.

#### **PRIVATE CAR SERVICE**

- 5.24 The Premises can recommend a private car booking service. In the event a customer wants to book a car home, the customer can wait inside the Premises until their car has arrived at nearby Regent Street (Kingly Street itself being pedestrianised) to ensure a quick and quiet exit.
- 5.25 Customers will be encouraged to quickly and quietly disperse towards their waiting vehicle to minimise any noise disruption.



## **6 Safeguarding and Estate Security**

- 6.1 The safeguarding of customers will be promoted by Shaftesbury in the following ways:
- 6.1.1 CSAS trained security guards in the Shaftesbury Estate;
  - 6.1.2 Active Estate Management, including 24/7 security;
  - 6.1.3 Membership of the Safer West End Business Crime Reduction Partnership;
  - 6.1.4 Radio links to police and estate security;
  - 6.1.5 Carnaby WhatsApp group membership to communicate issues and emergencies between tenants, managing agents, Safer West End and Estate Security;
  - 6.1.6 24/7 property management; and
  - 6.1.7 Promotion of safe place – supporting those within the vicinity who are vulnerable as a result of intoxication or other issues associated with the night time economy.
- 6.2 Shaftesbury has a 24/7 security team which works on the estate, with an office currently located on the second floor of Kingly Court. There are 14 CCTV cameras covering the public areas of the courtyard upper walkways and passageways.



## 7 Deliveries, Collections & Servicing

- 7.1 Deliveries and collections will be arranged carefully with an intention to be sympathetic to the local amenity. Wherever possible, multiple deliveries and/or collections will be combined to seek to avoid high numbers of vehicles servicing the Premises, with electronic vehicles preferable if available. Late night and early morning delivery and collection times are avoided wherever possible, to avoid disturbing local residents.
- 7.2 Servicing vehicles will be encouraged to load and unload goods quietly and quickly so as to ensure vehicle waiting time is limited. Drivers will be advised to turn engines off when delivering to reduce noise and pollution.
- 7.3 All servicing will be undertaken via Kingly Street during day time hours of 07:00 and 11:00 Monday to Saturday, with early morning deliveries (between 07:00 and 08:00) limited to essential deliveries only.
- 7.4 Refuse and waste will be stored at basement level pending collection, with access to the communal refuse area at Kingly Court should that be necessary.
- 7.5 The following conditions are offered as part of the application:
- 7.5.1 *“All waste shall be properly presented and placed out for collection no earlier than 30 minutes before the scheduled collection times.”*
- 7.5.2 *“No waste or recyclable materials, including bottles, shall be moved, removed from or placed in outside areas between (23.00) hours and (07.00) hours on the following day.”*
- 7.5.3 *“No collections of waste or recycling materials (including bottles) from the premises shall take place between (23.00) and (07.00) hours on the following day.”*



## **8 Closing Procedure**

- 8.1 Management controls will be implemented to ensure that the closing procedure has no adverse impact on local residents or businesses. The procedure shall promote a quick and quiet closure of the Premises.
- 8.2 Management controls shall include:
  - 8.2.1 Ensuring all customers will be off the Premises by the authorised closing times. There are no exceptions to this rule whatsoever.
  - 8.2.2 A prompt clean and clear up of the Premises as soon as possible after closure.
  - 8.2.3 Employees must leave the Premises quickly and quietly, at all times following the Dispersal Policy set out above.
  - 8.2.4 Employees are not permitted to loiter outside the Premises after closing.
  - 8.2.5 The pavement will be swept and cleaned every day.



## **9 Conclusion**

- 9.1 A culmination of all these controls and safeguards combine to ensure the Premises shall be operated successfully, safely and with minimal, if any, impact on the local amenity.





## **Observation Report**

**Mr Stuart Jenkins – Consultant**

**Leveche Associates Limited**

**9 – 11 Kingly Street  
London W1B 5PH**

### **Executive Summary**

1. Observations were carried out in relation to the application to obtain a new premises licence by Shaftsbury AV Limited and Little Door & Co Limited at 9 – 11 Kingly Street London W1B 5PH.
2. Covert observations were also carried out at a comparison premises, Little Scarlet Door 12 – 13 Greek Street London W1D 4DL which is run by the same applicant company and has a similar operational profile (but with later hours) to that proposed at 9-11 Kingly Street.
3. Between 20:00hrs on Friday 9<sup>th</sup> September and 04:00hrs on Saturday 10<sup>th</sup> September 2023 covert observations were conducted at 9 – 11 Kingly Street and Little Scarlet Door 12 – 13 Greek Street. This showed the Kingly Street premises closed awaiting development and Little Scarlet Door to be well run and operating correctly with no issues.
4. 9 – 11 Kingly Street premises is in the heart of the Carnaby area in the West End of London amongst retail outlets, restaurants bars and clubs, some of which operate until the early hours of the morning. The comparison premises are on the other side of Soho.
5. From the observations it is clear that the Little Door & Co Limited operating in 9 – 11 Kingly Street until 01:30hrs at the latest, will not increase anti-social behaviour or any other crime and disorder that would have a negative impact on nearby residents, the environment, local infrastructure or wider local community. Customers seen leaving the Little Scarlet Door did so quietly in small groups, couples or alone without causing anti-social behaviour and obstruction of the roads.



## **Introduction**

6. Leveche Associates Ltd are instructed to carry out observations relating to the proposed Little Door & Co Limited premises at 9 – 11 Kingly Street London W1 5PH.
7. Shaftsbury AV Limited, the landlord and Little Door & Co Limited, the proposed tenant, have jointly applied for a new premises licence to replace the existing licence. The proposal is for:
  - i. Permitted hours to reduce from 03:00hrs to 01:00hrs Monday to Friday (with closing time reduced to 01:30hrs from 03:30hrs).
  - ii. Permitted hours will increase from 00:00hrs to 01:00hrs on Saturday (with closing time increased to 01:30hrs from 00:30hrs).
  - iii. The existing licence conditions 10 – 17 and 20 – 22 are to be removed.
  - iv. The new conditions will include:
    - An overall maximum capacity of 180 (increased from 150).
    - Minimum seating provision for 90 people at all times.
    - To have substantial food and non-intoxicating beverages to be available throughout.
    - To have a dispersal policy.
    - To have SIA security staff risk assessed.
    - To have a formal proof of age scheme.
    - To have an incident log.
    - For there to be no off sales of alcohol after 23:00hrs.
8. The premises come under the jurisdiction of the West End Ward for the Metropolitan Police and Westminster City Council.
9. Concerns have been raised that the new premises licence application if granted would increase crime and disorder (including customers becoming victims of crime), add to cumulative impact and not support the Licensing Objectives.

## **Personal Summary – Stuart Jenkins**

10. I am a Director of Leveche Associates Limited, an independent company dealing with Licensing and Security in the private sector. I have worked as an Independent Consultant in the Licensing and Security Industry for the last five years.
11. I am a former Police Officer having retired from the Metropolitan Police after completion of over 30 years exemplary service.
12. Throughout my police career the majority of my service was spent on specialist units engaged on proactive operations :- 1993–1997 Central Territorial Support Group (TSG) - Level 1 Public Order, firearms officer and dedicated surveillance officer; 1997–1998 CO14 Clubs & Vice Unit – test purchase officer and street offences investigations; 1998-2000 Charing Cross Division on promotion – overt



and covert licensing operations; 2000-2008 CO14 Clubs & Vice Unit – lead officer for the investigation of serious criminal offences within licensed premises across London, test purchase officer, Pan-London licensing tactical advisor, Licensing Policy Development and Implementation for the Metropolitan Police Service (MPS) and intelligence unit supervisor; 2008-2018 Marine Policing Unit (MPU) – licensing lead for the MPU; licensing tactical advisor Notting Hill Carnival, covert licensing operations and intelligence unit supervisor. Marine intelligence and accreditation lead for the Queens Diamond Jubilee River Pageant and intelligence lead for the London Olympics 2012.

13. I was a Home Office qualified Crime Prevention Design Advisor.
14. I have qualified as Close Protection Operative (Level 3 Certificate) with Security Industry Authority (SIA).
15. I hold a Personal Licence under the Licensing Act 2003.

### **Observations**

16. Observations were carried out at the premises, the locations already outlined and the relevant local area. The Little Scarlet Door comparison premises is run by the same applicant company and has a similar operational profile (but with later hours) to that proposed at 9 - 11 Kingly Street.
17. Between 20:00hrs on Friday 9<sup>th</sup> September and 04:00hrs on Saturday 10<sup>th</sup> September 2023 covert observations were conducted 9 – 11 Kingly Street and Little Scarlet Door 12 – 13 Greek Street. This showed the Kingly Street premises closed awaiting development and Little Scarlet Door to be well run and operating with no issues and without its customers contributing to any cumulative impact in the surrounding area.
18. Observations concentrated on signs of criminality, begging, anti-social behaviour, vulnerable persons, other persons at risk, noise, the general environment, levels of intoxication and dispersal from comparison premises.
19. 9 – 11 Kingly Street is situated between the junctions of Beak Street and Ganton Street and opposite Tenison Court on the western edge of Soho in London's West End amongst shops, licensed premises, restaurants, cafes and other retail outlets which service the transient and residential population alike.
20. Where the Kingly Street premises is located the street generally runs north to south. Kingly Street runs parallel to Carnaby Street to the east and Regent Street to the west. 9 – 11 Kingly Street is located in a pedestrianised section of the street. The roads around Kingly Street have various access restrictions and directions of travel for vehicular traffic. Pedestrian access to these roads is unrestricted.



21. During the observations vehicular and pedestrian traffic was varied. The surrounding area is well served by buses, trains, taxis and bicycles for hire to take late night licensed premises patrons' home.
22. The shops, restaurants and other licensed premises in the Kingly Street area appeared to be well run and there were no issues. There was no begging witnessed in the street, no street drinkers or drug dealing around the premises or vicinity.
23. At the comparison premises' customers were not observed adding to cumulative impact (by way of noise, disorder, drunkenness or otherwise).

## **Deployment**

24. Observations commenced at 20:00hrs on Friday 9<sup>th</sup> September 2023 monitoring 9 – 11 Kingly Street and later at comparison site, Little Scarlet Door 12 – 13 Greek Street and the immediate areas around them.
25. At 20:03hrs 9 – 11 Kingly Street was observed. The premises had a smart corporate and professional looking frontage that was well maintained and clean. The premises was not trading, and a 'Notice of Application for Premises Licence' clearly displayed on the entrance doors for all parties to see and read.
26. To the north and next to the premises is Kaleido Rolls 10 Kingly Street W1B 5PJ and next to that the entrance to Kingly Court. To the south and next to the premises is Island Poke Soho 8 Kingly Street W1B 5PQ. Opposite the premises is Kingly News 61 Kingly Street W1B 5QL on the junction with Tenison Court.
27. At this time there was a high-volume of pedestrian traffic in and around Kingly Street with many of the shops, bars and restaurants open. Restaurants, bars and pubs were busy with tables and chairs set outside on the street. Customers and pedestrians passing through the area were well behaved and good natured.
28. Between 20:09hrs and 20:14hrs Kingly Street, Ganton Street and the Carnaby area were busy with the public enjoying the shops, restaurants, bars and pubs.
29. Between 20:15hrs and 20:19hrs Great Marlborough Street and Regent Street were busy with pedestrian and vehicular traffic.
30. Between 20:20hrs and 21:58hrs Kingly Court, Kingly Street, Ganton Street and the surrounding area remained busy with the general public enjoying the restaurants, bars and clubs.
31. Beak Street which adjoins Kingly Street and is one-way westbound for vehicles was used as a main route by vehicles and pedestrians' alike.
32. At 21:59hrs some of the restaurants started to close but the remaining open clubs, bars and restaurants remained busy. Customers were able to leave the



area by the many arterial routes on foot or by private and public transport which was available nearby in abundance.

33. Many of the premises had SIA registered security staff controlling entry and exit to their venues.
34. Between 22:50hrs and 23:05hrs I observed the Little Scarlet Door at 12 – 13 Greek Street. The premises had a smart corporate and professional looking frontage that was well maintained and clean. The main entrance door on Greek Street had a roped barrier either side of this door. The roped area to the left of the door was used as a smoking area for patrons and the roped area to the right was used for potential customers to queue. There were two door supervisors controlling outside front of house, one female and one male who were both wearing florescent tabards.
35. The front of the premises was well controlled. The management of the barriered area allowed other members of the public to pass the venue using the footway.
36. Greek Street generally runs north to south and is one-way with vehicular traffic travelling south. Pedestrians can pass the venue in either direction. The Little Scarlet Door is situated on the east footway opposite the junction with Bateman Street. Greek Street was busy with pedestrians and vehicles. Parked cars facing south added to the hustle and bustle of the area.
37. Between 23:17hrs and 01:38hrs I returned to Kingly Street, Kingly Court and the Carnaby area to carry out further observations.
38. At 23:38hrs I found that most of the restaurants in Kingly Court had closed or were closing. There were far less customers or pedestrians passing through the court.
39. Kingly Street and the surrounding area were quieter overall apart from the venues that were still open. Late night premises such as Cirque Le Soir in Ganton Street had now opened. The premises open after 23:00hrs included:
  - i. Cahoots 13 Kingly Court Carnaby London W1B 5PW advertised as open until 00:00hrs on Sunday; 01:00hrs on Monday and Tuesday; 02:00hrs on Wednesday, Thursday, Friday and Saturday.
  - ii. Cirque Le Soir 15 – 21 Ganton Street Carnaby London W1F 9BN advertised as opening at 23:00hrs and closing at 03:00hrs on Monday, Wednesday, Friday and Saturday; closed Sunday, Tuesday and Thursday.
  - iii. The Blue Posts 18 Kingly Street Carnaby London W1B 5PX advertised as open until 22:30hrs on Sunday; 23:00hrs on Monday and Wednesday; 23:30hrs on Thursday; 00:00hrs on Friday and Saturday.
  - iv. The Clachan 34 Kingly Street Carnaby London W1B 5QH advertised as open until 22:00hrs on Sunday; 23:00hrs on Monday, Tuesday, Wednesday and Thursday; 23:30hrs on Friday and Saturday.



- v. Shakespears Head Pub 29 Great Marlborough Street Carnaby London W1F 7HZ advertised as open until 00:00hrs Sunday to Saturday.
  - vi. Ganton Arms 18-20 Ganton Street Carnaby London W1F 7BU advertised as open until 23:00hrs on Sunday, Monday, Tuesday and Wednesday; 00:00hrs on Thursday, Friday and Saturday.
  - vii. Dishoom Restaurant / Bar 22 Kingly Street Carnaby London W1B 5QP advertised as open until 23:00hrs Sunday, Monday, Tuesday, Wednesday and Thursday; 00:00hrs on Friday and Saturday.
  - viii. Ain't Nothin But The Blues Bar 20 Kingly Street Carnaby London W1B 5PZ advertised as open until 23:30hrs on Sunday; 01:00hrs on Monday, Tuesday, Wednesday, Thursday; 02:00hrs on Friday and Saturday.
  - ix. Nightjar Carnaby Kingly Court 49 – 51 Carnaby Street London W1F 9PY advertised as open until 21:30hrs on Sunday; 00:30hrs on Monday, Tuesday and Wednesday; 01:00hrs on Thursday; 02:00hrs on Friday and Saturday.
  - x. Be at One Cocktail Bar 10 Beak Street London W1F 9RD advertised as open until 00:30hrs on Sunday; 01:00hrs on Monday; 03:00hrs on Tuesday, Wednesday, Thursday, Friday and Saturday.
40. With the closure of the restaurants in the previous hour, between 00.00hrs and 01:00hrs more bars and pubs closed. This left parts of Kingly Street and Carnaby area with fewer people including the area around 9 -11 Kingly Street apart from light pedestrian traffic leaving and arriving at the late licensed premises. Where bars and clubs were open, they continued to attract customers and were busy.
  41. Between 01:00hrs and 01:40hrs Ganton Street and the junction with Kingly Street remained busy with people coming to or leaving Cirque Le Soir and Ain't Nothin But The Blues Bar.
  42. Between 01:55hrs and 04:00hrs I carried out observations around Little Scarlet Door 12 – 13 Greek Street Soho, the comparison premises.
  43. At 01:55hrs pedestrian and vehicular traffic had increased from my earlier visit. The bars, clubs, fast-food outlets and mini supermarkets were very busy.
  44. The front of the premises was still controlled by male and female SIA registered door supervisors using the roped barriers. On occasions there was a third member of staff who assisted with the entry management to the venue. The smoking area was still to the left and the queue to the right-hand side of the entrance.
  45. Customers entered and left the premises by the main front door on Greek Street on a regular basis. The entrance door was never left open and only opened to allow customers to enter or leave. When the entrance door was opened I didn't hear any excessive noise emanating from the venue.



46. At 02:24hrs street cleaning vehicles were in operation in Greek Street. These vehicles added to the vehicle congestion whilst they temporarily stopped to collect the refuse.
47. At 02:43hrs customers started to leave the premises as closure approached. They left in ones and twos or small groups of no more than four people. The customers moving away from the premises predominantly left on foot or used private taxis.
48. Customers left in a controlled manner, quietly and with no signs of them being heavily intoxicated. I did not see any customers migrating to other premises and none of the customers appeared vulnerable to becoming victims of crime.
49. By 02:53hrs the smoking area and queue area were clear of customers apart from couples waiting for transport. Other members of the public were able to use the footpath and weren't obstructed. At this time there was no sign of anti-social behaviour or disturbance.
50. At 03:00hrs the premises closed, and the last remaining customers left the venue. The door team removed the barriers and took them inside the premises and shut the door behind them.
51. At 03:09hrs a handful of customers remained nearby the premises waiting for their transportation away from the area. There was no anti-social behaviour caused by these people whilst they waited.
52. By 03:10hrs the front of the premises was clear of customers.
53. From 03:11hrs south of and opposite the Little Scarlet Door remained busy with pedestrians and vehicular traffic.
54. By 03:30hrs the area around the venue was much quieter with most of the pedestrian and vehicular activity further south in Greek Street towards Brewer Street where later opening premises were still operating.
55. At 04:00hrs I completed my observations and left the area.

## **Summary**

56. One of the key concerns is the perception that this type of premises will attract anti-social behaviour and crime of various type, thereby increasing local reported crime figures. Well operated and managed venues with a professional security team and dispersal policy shouldn't generate more crime.
57. Shaftesbury AV Limited are well known and respected landlords. The proposed tenant, Little Door & Co Limited, currently successfully runs a similar venue in Soho open until 03:00hrs. The proposed latest terminal hour for 9 - 11 Kingly Street would be 01:30hrs. Kingly Street is within Shaftesbury AV Limited's



Carnaby Estate which they closely manage to promote high standards of security and safeguarding for all its tenants and their customers. They achieve this by:

- i. Having 24/7 estate security, comprising security patrols by CSAS qualified personnel and an extensive CCTV network.
  - ii. Membership of the Safer West End Business Crime Reduction Partnership.
  - iii. A dedicated estate management team, with close and regular contact with principals and on-site staff.
  - iv. Tenant radio links to the police and estate security, together with organised lines of communication for notification of emergencies and to share information between tenants, managing agents, the responsible authorities and estate security; and
  - v. The promotion of safe places, to support those who may be vulnerable because of intoxication or other issues associated with the night-time economy.
58. The observations in Kingly Street showed that the restaurants, bars and clubs in the area were well operated and run. There was no evidence of drug dealing, drunkenness, or any other anti-social behaviour. The staggered closing times of the different premises in the Kingly Street and the Carnaby area means that customers don't all leave at the same time thus preventing the streets from becoming congested and allowing them to secure transport away from the area quickly.
59. The premises are located close to Beak Street, Regent Street and Great Marlborough Street allowing customers easy access to public and private transport mediums to be able to leave the area promptly.
60. The observations I carried out on the comparison premises, Little Scarlet Door, showed the premises to be well run and that there are clearly defined systems in place to ensure the premises operate in support of the licensing objectives.
61. The premises were well maintained, and the entrance was well managed and policed by SIA registered door staff. Dispersal from the premises was managed by the door team. Customers left the premises either in couples or alone and moved away from the area promptly. There was no exodus of large groups of people. I did not see any customers from Little Scarlet Door migrating to other premises and none of the customers appeared vulnerable to becoming victims of crime. Customers appeared to have gone to the Little Scarlet Door for the night and not to go on to other venues before heading home.
62. I saw no evidence of any crime and disorder or anti-social behaviour linked to the premises. Customers left the premises quietly and weren't heavily intoxicated.
63. The dispersal of customers will not be an issue for the following reasons:
- i. The dispersal routes for the customers in the Kingly Street area tended to take them towards Regent Street, Great Marlborough Street and Beak Street where they had good access to the 24-hour transport network. The varied closure of



- premises in the area avoided an accumulation of people dispersing from each premises at the same time.
- ii. The comparison premises SIA door staff demonstrated that the arrival, departure, and dispersal of its customers was well managed and took place without incident. The new venue being operated by the same operator will ensure the arrival, departure, and dispersal of customers at 9 – 11 Kingly Street will be well managed at all times.
  - iii. The entrance / exit to 9 -11 Kingly Street lead on to wide pedestrianised areas with no vehicular through traffic. The new maximum capacity for the premises is 180 persons and this area would absorb that amount of people should the premises ever be operating at maximum capacity and all customers were to leave at the same time.
  - iv. Observations of the comparison premises showed that, as you would expect of a venue of this type, customers left either in couples or small groups of no more than four people and there was no exodus of large groups of people. There was no evidence of any disturbance or anti-social behaviour.
  - v. From the observations carried out it is correct to assume that the Little Scarlet Door premises are destination premises where people come for the night out, enjoy the entertainment, leave and make their way home.

## Conclusion

64. The Little Door & Co premises in Kingly Street will not add to the cumulative impact in the area. The proposal reduces the premises opening hours by two hours Monday to Friday for 03:00hrs/03:30hrs to 01:00hrs/01:30hrs, meaning customers will be able to drink for much fewer hours overall. The change in direction from the previous operation of the premises with the removal of old conditions and addition new conditions will reduce the chance of crime and disorder. These conditions include:
  - An overall max capacity of 180 (increased from 150).
  - Minimum seating provision for 90 people at all times.
  - To have substantial food and non-intoxicating beverages to be available throughout.
  - To have a dispersal policy.
  - To have SIA security staff risk assessed.
  - To have a formal proof of age scheme.
  - To have an incident log.
  - For there to be no off sales of alcohol after 23:00hrs.
65. From observations of the Little Scarlet Door customers from the Little Door & Co, Kingly Street are unlikely to add to the noise, nuisance, disorder or crime in the surrounding area.
66. Shaftesbury AV Limited's Carnaby Estate promote high standards of security and safeguarding for all its tenants and customers. The Little Door and Co currently operates successfully in Greek Street without the added security protection Shaftesbury AV Limited's Carnaby Estate will provide for the new venue.



67. Shaftsbury AV Limited and Little Door & Co Limited cannot be considered as a crime generator in any way. Covert observations found the premises in the Kingly Street and Carnaby area to be well run. There is no evidence to suggest that the proposed venue operated by Little Door & Co Limited will attract levels of crime and disorder that would be problematic and undermine the quality of community life.
68. The facts in this report are honest and true. The opinions expressed and any recommendations are made in good faith and with the best judgement. The fee for this report is not conditional on the outcome of any future case, application or finding.

**Stuart Jenkins**  
**Director**  
**Leveche Associates Limited**  
**22<sup>nd</sup> November 2023**





City of Westminster  
64 Victoria Street, London,  
SW1E 6QP

Schedule 12  
Part A

WARD: West End  
UPRN: 100023470412

Premises licence

Regulation 33, 34

Premises licence  
number:

22/09921/LIPT

Original Reference:

05/08618/LIPC

**Part 1 – Premises details**

**Postal address of premises:**

The Court  
9 Kingly Street  
London  
W1B 5PH

**Telephone Number:** None supplied

**Where the licence is time limited, the dates:**

Not applicable

**Licensable activities authorised by the licence:**

Performance of Dance  
Performance of Live Music  
Playing of Recorded Music  
Anything of a similar description to Live Music, Recorded Music or Performance of Dance  
Late Night Refreshment  
Private Entertainment consisting of dancing, music or other entertainment of a like kind for consideration and with a view to profit  
Sale by Retail of Alcohol

**The times the licence authorises the carrying out of licensable activities:**

**Performance of Dance**

Monday to Friday: 09:00 to 03:00

Saturday: 09:00 to 00:00

Seasonal Details: From the start on new Year's Eve to the end time on New Year's Day

**Performance of Live Music**

Monday to Friday: 09:00 to 03:00

Saturday: 09:00 to 00:00

Seasonal Details: From the start time on New Year's Eve to the end time on New Year's Day



**Playing of Recorded Music**

Unrestricted

**Anything of a similar description to Live Music, Recorded Music or Performance of Dance**

Monday to Friday: 09:00 to 03:00

Saturday: 09:00 to 00:00

Seasonal Details: From the start time on New Year's Eve to the end time on New Year's Day

**Late Night Refreshment**

Monday to Friday: 23:00 to 03:30

Saturday: 23:00 to 00:00

Seasonal Details: From the start time on New Year's Eve to the end time on New Year's Day.

**Private Entertainment consisting of dancing, music or other entertainment of a like kind for consideration and with a view to profit** Unrestricted**Sale by Retail of Alcohol**

Monday to Friday: 10:00 to 03:00

Saturday: 10:00 to 00:00

Sunday: 12:00 to 22:30

Seasonal Details: From the start time on New Year's Eve to the end time on New Year's Day.

**The opening hours of the premises:**

Monday to Friday: 09:00 to 03:30

Saturday: 09:00 to 00:30

Sunday: 12:00 to 23:00

Seasonal Details: From the start time on New Year's Eve to the end time on Ne New Year's Day

**Where the licence authorises supplies of alcohol, whether these are on and/or off supplies:**

Alcohol is supplied for consumption both on and off the Premises.

**Part 2****Name, (registered) address, telephone number and email (where relevant) of holder of premises licence:**

Shaftesbury Av Limited  
22 Ganton Street  
Carnaby  
London  
W1F 7FD

**Registered number of holder, for example company number, charity number (where applicable)**

09379734



**Name, address and telephone number of designated premises supervisor where the premises licence authorises the supply of alcohol:**

**Name:** Thomas Allerton

***Please note: It is the policy of the Licensing Authority not to display the address details of a designated premises supervisor.***

**Personal licence number and issuing authority of personal licence held by designated premises supervisor where the premises licence authorises for the supply of alcohol:**

**Licence Number:** PERS1320

**Licensing Authority:** London Borough of Lambeth

**Date:** 02 November 2022

**This licence has been authorised by Kevin Jackaman on behalf of the Director - Public Protection and Licensing.**



## Annex 1 – Mandatory conditions

1. No supply of alcohol may be made at a time when there is no designated premises supervisor in respect of this licence.
2. No supply of alcohol may be made at a time when the designated premises supervisor does not hold a personal licence or the personal licence is suspended.
3. Every supply of alcohol under this licence must be made or authorised by a person who holds a personal licence.
4.
  - (1) The responsible person must ensure that staff on relevant premises do not carry out, arrange or participate in any irresponsible promotions in relation to the premises.
  - (2) In this paragraph, an irresponsible promotion means any one or more of the following activities, or substantially similar activities, carried on for the purpose of encouraging the sale or supply of alcohol for consumption on the premises
    - (a) games or other activities which require or encourage, or are designed to require or encourage, individuals to;
      - (i) drink a quantity of alcohol within a time limit (other than to drink alcohol sold or supplied on the premises before the cessation of the period in which the responsible person is authorised to sell or supply alcohol), or
      - (ii) drink as much alcohol as possible (whether within a time limit or otherwise);
    - (b) provision of unlimited or unspecified quantities of alcohol free or for a fixed or discounted fee to the public or to a group defined by a particular characteristic in a manner which carries a significant risk of undermining a licensing objective;
    - (c) provision of free or discounted alcohol or any other thing as a prize to encourage or reward the purchase and consumption of alcohol over a period of 24 hours or less in a manner which carries a significant risk of undermining a licensing objective;
    - (d) selling or supplying alcohol in association with promotional posters or flyers on, or in the vicinity of, the premises which can reasonably be considered to condone, encourage or glamorise anti-social behaviour or to refer to the effects of drunkenness in any favourable manner;
    - (e) dispensing alcohol directly by one person into the mouth of another (other than where that other person is unable to drink without assistance by reason of a disability).
5. The responsible person must ensure that free potable water is provided on request to customers where it is reasonably available.
6.
  - (1) The premises licence holder or club premises certificate holder must ensure that an age verification policy is adopted in respect of the premises in relation to the sale or supply of alcohol.



- (2) The designated premises supervisor in relation to the premises licence must ensure that the supply of alcohol at the premises is carried on in accordance with the age verification policy.
- (3) The policy must require individuals who appear to the responsible person to be under 18 years of age (or such older age as may be specified in the policy) to produce on request, before being served alcohol, identification bearing their photograph, date of birth and either -
  - (a) a holographic mark, or
  - (b) an ultraviolet feature.

7. The responsible person must ensure that –

- (a) where any of the following alcoholic drinks is sold or supplied for consumption on the premises (other than alcoholic drinks sold or supplied having been made up in advance ready for sale or supply in a securely closed container) it is available to customers in the following measures -
  - (i) beer or cider: ½ pint;
  - (ii) gin, rum, vodka or whisky: 25 ml or 35 ml; and
  - (iii) still wine in a glass: 125 ml;
- (b) these measures are displayed in a menu, price list or other printed material which is available to customers on the premises; and
- (c) where a customer does not in relation to a sale of alcohol specify the quantity of alcohol to be sold, the customer is made aware that these measures are available.

A responsible person in relation to a licensed premises means the holder of the premise licence in respect of the premises, the designated premises supervisor (if any) or any individual aged 18 or over who is authorised by either the licence holder or designated premises supervisor. For premises with a club premises certificate, any member or officer of the club present on the premises in a capacity that which enables him to prevent the supply of alcohol.

- 8 (i) A relevant person shall ensure that no alcohol is sold or supplied for consumption on or off the premises for a price which is less than the permitted price.
- (ii) For the purposes of the condition set out in paragraph 8(i) above -
  - (a) "duty" is to be construed in accordance with the Alcoholic Liquor Duties Act 1979;
  - (b) "permitted price" is the price found by applying the formula -
 
$$P = D + (D \times V)$$
 Where -
    - (i) P is the permitted price,
    - (ii) D is the amount of duty chargeable in relation to the alcohol as if the duty were charged on the date of the sale or supply of the alcohol, and



- (iii) V is the rate of value added tax chargeable in relation to the alcohol as if the value added tax were charged on the date of the sale or supply of the alcohol;
  - (c) "relevant person" means, in relation to premises in respect of which there is in force a premises licence -
    - (i) the holder of the premises licence,
    - (ii) the designated premises supervisor (if any) in respect of such a licence, or
    - (iii) the personal licence holder who makes or authorises a supply of alcohol under such a licence;
  - (d) "relevant person" means, in relation to premises in respect of which there is in force a club premises certificate, any member or officer of the club present on the premises in a capacity which enables the member or officer to prevent the supply in question; and
  - (e) "value added tax" means value added tax charged in accordance with the Value Added Tax Act 1994.
- (iii). Where the permitted price given by Paragraph 8(ii)(b) above would (apart from this paragraph) not be a whole number of pennies, the price given by that sub-paragraph shall be taken to be the price actually given by that sub-paragraph rounded up to the nearest penny.
- (iv). (1) Sub-paragraph 8(iv)(2) below applies where the permitted price given by Paragraph 8(ii)(b) above on a day ("the first day") would be different from the permitted price on the next day ("the second day") as a result of a change to the rate of duty or value added tax.
- (2) The permitted price which would apply on the first day applies to sales or supplies of alcohol which take place before the expiry of the period of 14 days beginning on the second day.
9. All persons guarding premises against unauthorised access or occupation or against outbreaks of disorder or against damage (door supervisors) must be licensed by the Security Industry Authority.



## **Annex 2 – Conditions consistent with the operating Schedule**

None



### **Annex 3 – Conditions attached after a hearing by the licensing authority**

10. This licence is subject to all the former Rules of Management for Places of Public Entertainment licensed by Westminster City Council, in force from 4 September 1998 and incorporating amendments agreed by the Council on 25 October 1999, 30 June 2000, 16 January 2001 and 1 October 2001.
11. On New Year's Eve the premises can remain open for the purpose of providing regulated entertainment from the time when the provision of regulated entertainment must otherwise cease on New Year's Eve to the time when regulated entertainment can commence on New Year's Day (or until midnight on New Year's Eve where no regulated entertainment takes place on New Year's Day).
12. Notwithstanding the provisions of Rule of Management No.6 the premises may remain open for the purposes of this licence from 23:00 on each of the days Monday to Friday to 03:00 on the day following.
13. An attendant shall be on duty in the cloakroom during the whole time it is in use.
14. The exitway to Beak Street via the open court and Kingly Court shall be maintained readily available and the collapsible gate at the inner end of the arch shall be locked back fully in the open position when the premises are in use.
15. The spring keys to the entrance doors of No. 10 Kingly Street be removed and retained in the possession of a responsible person during the whole time the public are on the premises.
16. The number of persons accommodated at any one time (excluding staff) shall not exceed the following: Ground floor of Nos. 9 and 10 Kingly Street - 30. Basement of No. 9 Kingly Street and Nos. 12/15 Kingly Court - 120.
17. The sale of alcohol must be ancillary to the use of the premises for music and dancing and substantial refreshment.
18. The premises shall install and maintain a comprehensive CCTV system as per the minimum requirements of the Westminster Police Licensing Team. All entry and exit points will be covered enabling frontal identification of every person entering in any light condition. The CCTV system shall continually record whilst the premises is open for licensable activities and during all times when customers remain on the premises. All recordings shall be stored for a minimum period of 31 days with date and time stamping. Viewing of recordings shall be made available immediately upon the request of Police or authorised officer throughout the entire 31 day period.
19. A staff member from the premises who is conversant with the operation of the CCTV system shall be on the premises at all times when the premises is open. This staff member must be able to provide a Police or authorised council officer copies of recent CCTV images or data with the absolute minimum of delay when requested.
20. The supply of alcohol at the premises shall only be sold for consumption by members and their bona fide guests (not exceeding 4 guests per member). No person shall be admitted to membership of the private club or be entitled to take advantage of any of the privileges of membership without an interval of at least 48 hours between their nomination or application for membership and their admission.
21. A list of the names and addresses of members shall be kept on the premises at all times together with a book showing the names and dates of attendance of any guests



introduced by members. Both the list and the book shall be produced on demand for inspection by the police or an authorised officer of the Council.

22. After 23:00 hours, the supply of alcohol at the premises shall only be to a person seated at a table
23. No noise generated on the premises, or by its associated plant or equipment, shall emanate from the premises nor vibration be transmitted through the structure of the premises which gives rise to a nuisance.
24. All external doors shall be kept closed after 23:00 hours, or at any time when regulated entertainment takes place, except for the immediate access and egress of persons.
25. Notices shall be prominently displayed at all exits requesting patrons to respect the needs of local residents and businesses and leave the area quietly.
26. All waste shall be properly presented and placed out for collection no earlier than 30 minutes before the scheduled collection times.
27. Patrons permitted to temporarily leave and then re-enter the premises, e.g. to smoke, shall not be permitted to take drinks or glass containers with them.
28. During the hours of operation of the premises, the licence holder shall ensure sufficient measures are in place to remove and prevent litter or waste arising or accumulating from customers in the area immediately outside the premises, and that this area shall be swept and or washed, and litter and sweepings collected and stored in accordance with the approved refuse storage arrangements by close
29. The approved arrangements at the premises, including means of escape provisions, emergency warning equipment, the electrical installation and mechanical equipment, shall at all material times be maintained in good condition and full working order.
30. The means of escape provided for the premises shall be maintained unobstructed, free of trip hazards, be immediately available and clearly identified in accordance with the plans provided.
31. All emergency exit doors shall be available at all material times without the use of a key, code, card or similar means.
32. All emergency doors shall be maintained effectively self-closing and not held open other than by an approved device.
33. The edges of the treads of steps and stairways shall be maintained so as to be conspicuous.









City of Westminster  
64 Victoria Street, London,  
SW1E 6QP

Schedule 12  
Part B

Premises licence  
summary

WARD: West End  
UPRN: 100023470412

Regulation 33, 34

Premises licence  
number:

22/09921/LIPT

Part 1 – Premises details

Postal address of premises:

The Court  
9 Kingly Street  
London  
W1B 5PH

Telephone Number: None supplied

Where the licence is time limited, the dates:

Not applicable

Licensable activities authorised by the licence:

Performance of Dance  
Performance of Live Music  
Playing of Recorded Music  
Anything of a similar description to Live Music, Recorded Music or Performance of Dance  
Late Night Refreshment  
Private Entertainment consisting of dancing, music or other entertainment of a like kind for consideration and with a view to profit  
Sale by Retail of Alcohol

The times the licence authorises the carrying out of licensable activities:

**Performance of Dance**

Monday to Friday: 09:00 to 03:00

Saturday: 09:00 to 00:00

Seasonal Details: From the start on new Year's Eve to the end time on New Year's Day

**Performance of Live Music**

Monday to Friday: 09:00 to 03:00

Saturday: 09:00 to 00:00

Seasonal Details: From the start time on New Year's Eve to the end time on New Year's Day



**Playing of Recorded Music**

Unrestricted

**Anything of a similar description to Live Music, Recorded Music or Performance of Dance**

Monday to Friday: 09:00 to 03:00

Saturday: 09:00 to 00:00

**Late Night Refreshment**

Monday to Friday: 23:00 to 03:30

Saturday: 23:00 to 00:00

Seasonal Details: From the start time on New Year's Eve to the end time on New Year's Day.

**Private Entertainment consisting of dancing, music or other entertainment of a like kind for consideration and with a view to profit** Unrestricted**Sale by Retail of Alcohol**

Monday to Friday: 10:00 to 03:00

Saturday: 10:00 to 00:00

Sunday: 12:00 to 22:30

Seasonal Details: From the start time on New Year's Eve to the end time on New Year's Day.

**The opening hours of the premises:**

Monday to Friday: 09:00 to 03:30

Saturday: 09:00 to 00:30

Sunday: 12:00 to 23:00

**Where the licence authorises supplies of alcohol, whether these are on and/or off supplies:**

Alcohol is supplied for consumption both on and off the Premises.

**Name and (registered) address of holder of premises licence:**

Shaftesbury Av Limited

22 Ganton Street

Carnaby

London

W1F 7FD

**Registered number of holder, for example company number, charity number (where applicable)**

09379734

**Name of designated premises supervisor where the premises licence authorises for the supply of alcohol:**

Name: Thomas Allteron



**State whether access to the premises by children is restricted or prohibited:**

Restricted

**Date: 02 November 2022**

**This licence has been authorised by Ms Michelle Steward on behalf of the Director -  
Public Protection and Licensing.**



Licensing Act 2003 History

Application	Details of Application	Date Determined	Decision
05/08618/LIPC	<p>Conversion licence</p> <p><b>Performance of Live Music:</b> Monday to Friday 09:00 to 03:00 Saturday - 09:00 to 23:00</p> <p><b>Playing of Recorded Music:</b> Unrestricted</p> <p><b>Performance of Dance:</b> Monday to Friday 09:00 to 03:00 Saturday 09:00 to 23:00</p> <p><b>Anything of a similar description to Live Music, Recorded Music or Performance of Dance:</b> Monday to Friday 09:00 to 03:00 Saturday 09:00 to 23:00</p> <p><b>Provision of facilities for Making Music:</b> Monday to Friday 09:00 to 03:00 Saturday 09:00 to 23:00</p> <p><b>Provision of facilities for Dancing: Monday to Friday 09:00 to 03:00</b> Saturday - 09:00 to 23:00</p> <p><b>Provision of facilities for entertainment of a similar description to Making Music or Dancing:</b> Monday to Friday 09:00 to 03:00 Saturday 09:00 to 23:00</p>	18.09.2005	Granted under delegated authority



	<p><b>Private Entertainment consisting of dancing, music or other entertainment of a like kind for consideration and with a view to profit:</b> Unrestricted</p> <p><b>Late Night Refreshment:</b> Monday to Friday 23:00 to 03:30 Saturday 23:00 to 23:30</p> <p><b>Sale by Retail of Alcohol:</b> Monday to Friday 10:00 to 03:00 Saturday 10:00 to 23:00 Sunday 12:00 to 22:30</p>		
06/06887/WCCMAP	Master Licence	18.09.2005	Granted under delegated authority
12/06745/LIPDPS	Application to vary designated premises supervisor	29.08.2012	Granted under delegated authority
18/03731/LIPV	<p>Variation application: To permit a terminal hour on Saturday for all licensable activities of 03:00</p> <p>To reduce the terminal hour on Monday for all licensable activities 23:00</p> <p>To add two CCTV model conditions</p> <p>At least 2 SIA licensed door supervisors shall be on duty at the entrance of the premises at all times whilst it is open for business</p>	04.06.2018	Granted by Licensing Sub-Committee
18/12396/LIPT	Transfer application: West End Commercial Properties Limited to Fleur Hospitality Limited	06.12.2018	Granted under delegated authority



19/01344/LIPV	Variation application: To vary the layout of the premises	06.03.2019	Granted under delegated authority
19/03433/LIPDPS	Application to vary designated premises supervisor	11.06.2019	Granted under delegated authority
20/02060/LIPDPS	Application to vary designated premises supervisor	10.03.2020	Granted under delegated authority
22/09921/LIPT	Transfer application: Fleur Hospitality Limited to Shaftesbury Av Limited	02.11.2022	Granted under delegated authority
23/01201/LIPV	Variation application:  To remove conditions 10 - 17, 20 & 21 13 -17 and 22 and replace them with a suite of modern and appropriate model conditions.  To increase the capacity to 220  To increase the permitted hours on Saturdays to 01:00 and add licensable activities on Sundays until 23:00  To update the layout of the premises  To reduce the hours for licensable activities on a Monday to Friday to 01:00.		Refused by Licensing Sub-Committee



**CONDITIONS CONSISTENT WITH THE OPERATING SCHEDULE AND CONDITIONS PROPOSED BY A PARTY TO THE HEARING**

When determining an application for a new premises licence under the provisions of the Licensing Act 2003, the licensing authority must, unless it decides to reject the application, grant the licence subject to the conditions which are indicated as mandatory in this schedule.

At a hearing the licensing authority may, in addition, and having regard to any representations received, grant the licence subject to such conditions which are consistent with the operating schedule submitted by the applicant as part of their application, or alter or omit these conditions, or add any new condition to such extent as the licensing authority considers necessary for the promotion of the licensing objectives.

This schedule lists those conditions which are consistent with the operating schedule, or proposed as necessary for the promotion of the licensing objectives by a responsible authority or an interested party as indicated. These conditions have not been submitted by the licensing service but reflect the positions of the applicant, responsible authority or interested party and have not necessarily been agreed

**Mandatory Conditions**

1. No supply of alcohol may be made at a time when there is no designated premises supervisor in respect of this licence.
2. No supply of alcohol may be made at a time when the designated premises supervisor does not hold a personal licence or the personal licence is suspended.
3. Every supply of alcohol under this licence must be made or authorised by a person who holds a personal licence.
4.
  - (1) The responsible person must ensure that staff on relevant premises do not carry out, arrange or participate in any irresponsible promotions in relation to the premises.
  - (2) In this paragraph, an irresponsible promotion means any one or more of the following activities, or substantially similar activities, carried on for the purpose of encouraging the sale or supply of alcohol for consumption on the premises—
    - (a) games or other activities which require or encourage, or are designed to require or encourage, individuals to;
      - (i) drink a quantity of alcohol within a time limit (other than to drink alcohol sold or supplied on the premises before the cessation of the period in which the responsible person is authorised to sell or supply alcohol), or
      - (ii) drink as much alcohol as possible (whether within a time limit or otherwise);
    - (b) provision of unlimited or unspecified quantities of alcohol free or for a fixed or discounted fee to the public or to a group defined by a particular characteristic in a manner which carries a significant risk of undermining a licensing objective;
    - (c) provision of free or discounted alcohol or any other thing as a prize to encourage or reward the purchase and consumption of alcohol over a period of 24 hours or



less in a manner which carries a significant risk of undermining a licensing objective;

- (d) selling or supplying alcohol in association with promotional posters or flyers on, or in the vicinity of, the premises which can reasonably be considered to condone, encourage or glamorise anti-social behaviour or to refer to the effects of drunkenness in any favourable manner;
  - (e) dispensing alcohol directly by one person into the mouth of another (other than where that other person is unable to drink without assistance by reason of a disability).
5. The responsible person must ensure that free potable water is provided on request to customers where it is reasonably available.
6. (1) The premises licence holder or club premises certificate holder must ensure that an age verification policy is adopted in respect of the premises in relation to the sale or supply of alcohol.
- (2) The designated premises supervisor in relation to the premises licence must ensure that the supply of alcohol at the premises is carried on in accordance with the age verification policy.
- (3) The policy must require individuals who appear to the responsible person to be under 18 years of age (or such older age as may be specified in the policy) to produce on request, before being served alcohol, identification bearing their photograph, date of birth and either—
- (a) a holographic mark, or
  - (b) an ultraviolet feature.
7. The responsible person must ensure that—
- (a) where any of the following alcoholic drinks is sold or supplied for consumption on the premises (other than alcoholic drinks sold or supplied having been made up in advance ready for sale or supply in a securely closed container) it is available to customers in the following measures—
    - (i) beer or cider: ½ pint;
    - (ii) gin, rum, vodka or whisky: 25 ml or 35 ml; and
    - (iii) still wine in a glass: 125 ml;
  - (b) these measures are displayed in a menu, price list or other printed material which is available to customers on the premises; and
  - (c) where a customer does not in relation to a sale of alcohol specify the quantity of alcohol to be sold, the customer is made aware that these measures are available.

A responsible person in relation to a licensed premises means the holder of the premise licence in respect of the premises, the designated premises supervisor (if any) or any individual aged 18 or over who is authorised by either the licence holder or designated premises supervisor. For premises with a club premises certificate, any member or officer of the club present on the premises in a capacity that which enables him to prevent the supply of alcohol.



- 8(i) A relevant person shall ensure that no alcohol is sold or supplied for consumption on or off the premises for a price which is less than the permitted price.
- 8(ii) For the purposes of the condition set out in paragraph 8(i) above -
- (a) "duty" is to be construed in accordance with the Alcoholic Liquor Duties Act 1979;
- (b) "permitted price" is the price found by applying the formula -
- $$P = D + (D \times V)$$
- Where -
- (i) P is the permitted price,
- (ii) D is the amount of duty chargeable in relation to the alcohol as if the duty were charged on the date of the sale or supply of the alcohol, and
- (iii) V is the rate of value added tax chargeable in relation to the alcohol as if the value added tax were charged on the date of the sale or supply of the alcohol;
- (c) "relevant person" means, in relation to premises in respect of which there is in force a premises licence -
- (i) the holder of the premises licence,
- (ii) the designated premises supervisor (if any) in respect of such a licence, or
- (iii) the personal licence holder who makes or authorises a supply of alcohol under such a licence;
- (d) "relevant person" means, in relation to premises in respect of which there is in force a club premises certificate, any member or officer of the club present on the premises in a capacity which enables the member or officer to prevent the supply in question; and
- (e) "value added tax" means value added tax charged in accordance with the Value Added Tax Act 1994.
- 8(iii). Where the permitted price given by Paragraph 8(ii)(b) above would (apart from this paragraph) not be a whole number of pennies, the price given by that sub-paragraph shall be taken to be the price actually given by that sub-paragraph rounded up to the nearest penny.
- 8(iv). (1) Sub-paragraph 8(iv)(2) below applies where the permitted price given by Paragraph 8(ii)(b) above on a day ("the first day") would be different from the permitted price on the next day ("the second day") as a result of a change to the rate of duty or value added tax.
- (2) The permitted price which would apply on the first day applies to sales or supplies of alcohol which take place before the expiry of the period of 14 days beginning on the second day.
9. All persons guarding premises against unauthorised access or occupation or against outbreaks of disorder or against damage (door supervisors) must be licensed by the Security Industry Authority.



## Conditions consistent with the operating schedule

10. (a) The premises shall install and maintain a comprehensive CCTV system as per the minimum requirements of the Westminster Police Licensing Team.  
(b) All entry and exit points will be covered enabling frontal identification of every person entering in any light condition.  
(c) The CCTV system shall continually record whilst the premises is open for licensable activities and during all times when customers remain on the premises and will include the external area immediately outside the premises entrance.  
(d) All recordings shall be stored for a minimum period of 31 days with date and time stamping.  
(e) Viewing of recordings shall be made available immediately upon the request of Police or authorised officer throughout the entire 31-day period.
11. A staff member from the premises who is conversant with the operation of the CCTV system shall be on the premises at all times when the premises is open. This staff member must be able to provide a Police or authorised council officer copies of recent CCTV images or data with the absolute minimum of delay when requested.
12. No noise generated on the premises, or by its associated plant or equipment, shall emanate from the premises nor vibration be transmitted through the structure of the premises which gives rise to a nuisance.
13. All windows and external doors shall be kept closed after 23:00 hours, or at any time when regulated entertainment takes place, except for the immediate access and egress of persons.
14. Notices shall be prominently displayed at all exits requesting patrons to respect the needs of local residents and businesses and leave the area quietly.
15. All waste shall be properly presented and placed out for collection no earlier than 30 minutes before the scheduled collection times.
16. Patrons permitted to temporarily leave and then re-enter the premises, e.g. to smoke or make a phone call, shall not be permitted to take glass containers with them.
17. During the hours of operation of the premises, the licence holder shall ensure sufficient measures are in place to remove and prevent litter or waste arising or accumulating from customers in the area immediately outside the premises, and that this area shall be swept and or washed, and litter and sweepings collected and stored in accordance with the approved refuse storage arrangements by close of business.
18. The approved arrangements at the premises, including means of escape provisions, emergency warning equipment, the electrical installation and mechanical equipment, shall at all material times be maintained in good condition and full working order.
19. The means of escape provided for the premises shall be maintained unobstructed, free of trip hazards, be immediately available and clearly identified in accordance with the plans provided.
20. All emergency exit doors shall be available at all material times without the use of a key, code card or similar means.
21. All emergency doors shall be maintained effectively self-closing and not held open other than by an approved device.



22. The edges of the treads of steps and stairways shall be maintained so as to be conspicuous.
23. Curtains and hangings shall be arranged so as not to obstruct emergency safety signs or emergency equipment.
24. Loudspeakers shall not be located in the entrance and exit of the premises or outside the building.
25. There shall be no sales of alcohol for consumption off the premises after (23.00) hours.
26. All sales of alcohol for consumption off the premises shall be in sealed containers only, and shall not be consumed on the premises.
27. Notices shall be prominently displayed at any area used for smoking requesting patrons to respect the needs of local residents and use the area quietly.
28. No waste or recyclable materials, including bottles, shall be moved, removed from or placed in outside areas between (23.00) hours and (07.00) hours on the following day.
29. No collections of waste or recycling materials (including bottles) from the premises shall take place between (23.00) and (07.00) hours on the following day.
30. A Challenge 21 or Challenge 25 proof of age scheme shall be operated at the premises where the only acceptable forms of identification are recognised photographic identification cards, such as a driving licence, passport or proof of age card with the PASS Hologram.
31. A record shall be kept detailing all refused sales of alcohol. The record should include the date and time of the refused sale and the name of the member of staff who refused the sale. The record shall be available for inspection at the premises by the police or an authorised officer of the City Council at all times whilst the premises is open.
32. An incident log shall be kept at the premises, and made available on request to an authorised officer of the City Council or the Police. It must be completed within 24 hours of the incident and will record the following:
  - (a) all crimes reported to the venue
  - (b) all ejections of patrons
  - (c) any complaints received concerning crime and disorder
  - (d) any incidents of disorder
  - (e) all seizures of drugs or offensive weapons
  - (f) any faults in the CCTV system, searching equipment or scanning equipment
  - (g) any refusal of the sale of alcohol
  - (h) any visit by a relevant authority or emergency service.
33. No deliveries to the premises shall take place between (23.00) and (07.00) hours on the following day.
34. No deliveries from the premises, either by the licensee or a third party, shall take place between (23:00) and (07:00) hours on the following day.
35. The number of persons permitted in the premises at any one-time (excluding staff) shall not exceed (180) persons.



36. There shall be seating available in the premises for at least (90) patrons at all times.
37. Substantial food and non-intoxicating beverages, including drinking water, shall be available in all parts of the premises where alcohol is sold or supplied for consumption on the premises.
38. A copy of the premises' dispersal policy shall be made readily available at the premises for inspection by a police officer and/or an authorised officer of Westminster City Council.
39. The need for SIA licensed door supervisors must be risk assessed on an ongoing basis.
40. No licensable activities shall take place at the premises until the premises has been assessed as satisfactory by the Environmental Health Consultation Team at which time this condition shall be removed from the Licence by the licensing authority.
41. No licensable activities shall take place at the premises until premises licence 22/09921/LIPT (or such other number subsequently issued for the premises) has been surrendered.

#### **Conditions proposed by the Environmental Health Service**

42. A noise limiter must be fitted to the musical amplification system and maintained in accordance with the following criteria:
  - (a) the limiter must be set at a level determined by and to the satisfaction of an authorised Environmental Health Officer, so as to ensure that no noise nuisance is caused to local residents or businesses,
  - (b) The operational panel of the noise limiter shall then be secured by key or password to the satisfaction of the authorised Environmental Health Officer and access shall only be by persons authorised by the Premises Licence holder,
  - (c) The limiter shall not be altered without prior written agreement from the Environmental Health Consultation Team,
  - (d) No alteration or modification to any existing sound system(s) should be affected without prior knowledge of the Environmental Health Consultation Team, and
  - (e) No additional sound generating equipment shall be used on the premises without being routed through the sound limiter device.

#### **Conditions proposed by the Licensing Authority**

None

#### **Conditions proposed by the Metropolitan Police Service**

None



**9 Kingly Street London W1B 5PH**



23/11/2023, 16:51:18

- Property Mailing List
- Ward Boundaries
- Ward Labels

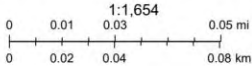

**Resident Count: 7**



<b>Licensed premises within 75 metres of 9 Kingly Street London W1B 5PH</b>				
<b>Licence Number</b>	<b>Trading Name</b>	<b>Address</b>	<b>Premises Type</b>	<b>Time Period</b>
22/09921/LIPT	The Court	9 Kingly Street London W1B 5PH	Club or institution	Saturday; 09:00 - 00:30   Sunday; 12:00 - 23:00   Monday to Friday; 09:00 - 03:30
22/05147/LIPN	Shadow Licence	9 Kingly Street London W1B 5PH	Premises Licence - Shadow Licence	Saturday; 09:00 - 00:30   Sunday; 12:00 - 23:00   Monday to Friday; 09:00 - 03:30
22/06910/LIPDPS	Pizza Pilgrims	11 Kingly Street London W1B 5PL	Shop	Monday to Sunday; 08:00 - 00:30
15/00525/LIPN	Pizza Pilgrims Kiosk	11 Kingly Street London W1B 5PL	Shop	Saturday; 10:00 - 23:00   Sunday; 10:00 - 22:30   Monday to Saturday; 08:00 - 23:00
23/01272/LIPVM	Imad's Syrian Restaurant	Second Floor Unit 14 Kingly Court Kingly Court London W1B 5PW	Restaurant	Sunday; 09:00 - 22:30   Monday to Thursday; 09:00 - 23:30   Friday to Saturday; 09:00 - 00:00
23/05626/LIPT	Imads Syrian Kitchen Ltd	Second Floor Unit 14 Kingly Court Kingly Court London W1B 5PW	Restaurant	Sunday; 12:00 - 23:00   Monday to Thursday; 10:00 - 00:00   Friday to Saturday; 10:00 - 00:30
14/11127/LIPVM	Oka Restaurant Units 1.14 - 1.16	Kingly Court Kingly Street London W1B 5PW	Restaurant	Sunday; 12:00 - 23:00   Monday to Thursday; 10:00 - 00:00   Friday to Saturday; 10:00 - 00:30
21/10252/LIPDPS	Korean Dinner Party	Kingly Court Kingly	Restaurant	Sunday; 12:00 - 23:00



		Street London W1B 5PW		Monday to Thursday; 10:00 - 00:00   Friday to Saturday; 10:00 - 00:30
23/02760/LIPT	Units 1.7 And 1.8, First Floor	Kingly Court Kingly Street London W1B 5PW	Restaurant	Sunday; 12:00 - 23:00   Monday to Thursday; 10:00 - 00:00   Friday to Saturday; 10:00 - 00:30
15/11467/LIPDPS	Le Bab (Units 2.10 And 2.11)	Kingly Court Kingly Street London W1B 5PW	Restaurant	Sunday; 12:00 - 23:00   Monday to Thursday; 10:00 - 00:00   Friday to Saturday; 10:00 - 00:30
23/00218/LIPDPS	Marsha	Ground Floor Unit 2 And First Floor Units 4-6 Kingly Court Kingly Court London W1B 5PW	Restaurant	Sunday; 07:00 - 22:30   Monday to Thursday; 07:00 - 23:30   Friday to Saturday; 07:00 - 00:00
23/05097/LIPDPS	Unit 2.1-2.4 Kingly Court	Second Floor Units 1 And 2 Kingly Court Kingly Street London W1B 5PW	Restaurant	Sunday; 09:00 - 22:30   Monday to Thursday; 09:00 - 23:30   Friday to Saturday; 09:00 - 00:00
19/09764/LIPCH	Shoryu	Ground Floor Unit 3- 5 Kingly Court Kingly Court London W1B 5PW	Restaurant	Sunday; 12:00 - 23:00   Monday to Thursday; 10:00 - 00:00   Friday to Saturday; 10:00 - 00:30
18/08932/LIPDPS	Senor Ceviche	First Floor Units 1-3 Kingly Court Kingly Court London W1B 5PW	Restaurant	Sunday; 12:00 - 23:00   Monday to Thursday; 10:00 - 00:00   Friday to Saturday; 10:00 - 00:30



22/11342/LIPDPS	Wright Brothers Soho	12 - 13 Kingly Street London	Restaurant	Sunday; 08:00 - 23:00   Monday to Saturday; 08:00 - 00:00
14/06042/LIPDPS	Life Goddess	Former Unit 1.9 Kingly Court London	Restaurant	Sunday; 12:00 - 23:00   Monday to Thursday; 10:00 - 00:00   Friday to Saturday; 10:00 - 00:30
19/14857/LIPT	The Good Egg	Unit G9 Kingly Court London W1B 5PW	Restaurant	Sunday; 12:00 - 23:00   Monday to Thursday; 10:00 - 00:00   Friday to Saturday; 10:00 - 00:30   New Year's Day; 00:00 - 00:00
22/09532/LIPDPS	Cahoots Ticket Hall & Control Room	5 Kingly Street London W1B 5PF	Restaurant	Sunday; 09:00 - 01:00   Monday to Saturday; 09:00 - 01:10
22/03201/LIPDPS	Rum Kitchen, First Floor, Units 1.12 And 1.13	First Floor 12 Kingly Court London W1B 5PW	Restaurant	Sunday; 12:00 - 23:00   Monday to Thursday; 10:00 - 00:00   Friday to Saturday; 10:00 - 00:30
22/09539/LIPDPS	Cahoots	Unit G 13 Kingly Court London W1B 5PW	Night clubs and discos	Sunday; 09:00 - 00:00   Monday to Wednesday; 09:00 - 03:00   Thursday to Saturday; 09:00 - 03:30
22/00139/LIPT	Shampers Wine Bar	Ground Floor 4 Kingly Street London W1B 5PE	Wine bar	Sunday; 12:00 - 00:00   Monday to Saturday; 10:00 - 00:30
22/02115/LIPN	3 And 4 Kingly Street, London, W1B 5PD	4 Kingly Street London W1B 5PE	Not Recorded	Monday; 09:00 - 23:30   Tuesday; 09:00 - 23:30   Wednesday; 09:00 - 23:30



				Thursday; 09:00 - 23:30   Friday; 09:00 - 00:00   Saturday; 09:00 - 00:00   Sunday; 09:00 - 22:30
23/06398/LIPDPS	Red Lion Public House	14 Kingly Street London W1B 5PR	Public house or pub restaurant	Sunday; 12:00 - 23:00   Monday to Thursday; 10:00 - 23:30   Friday to Saturday; 10:00 - 00:00
23/05150/LIPT	Jinjuu	Basement And Ground Floor 15 - 16 Kingly Street London W1B 5PT	Restaurant	Monday; 10:00 - 01:30   Tuesday; 10:00 - 01:30   Wednesday; 10:00 - 01:30   Thursday; 10:00 - 01:30   Friday; 10:00 - 01:30   Saturday; 10:00 - 01:30   Sunday; 12:00 - 00:00
21/14225/LIPDPS	Two Floors	Ground Floor 3 Kingly Street London W1B 5PD	Shop	Sunday; 12:00 - 23:00   Monday to Thursday; 10:00 - 23:30   Friday to Saturday; 10:00 - 00:00   Sundays before Bank Holidays; 12:00 - 00:00
21/13442/LIPVM	Fifty Carnaby	49-51 Carnaby Street London W1F 9PY	Night clubs and discos	Sunday; 08:00 - 00:00   Monday to Wednesday; 08:00 - 02:00   Thursday to Saturday; 08:00 - 03:00
20/06816/LIPRW	Clun Mexicana	49-51 Carnaby Street London W1F 9PY	Restaurant	Sunday; 08:00 - 23:00   Monday to Thursday; 08:00 - 00:00   Friday to Saturday;



				08:00 - 00:30
11/07877/LIPDPS	Open Space	Kingly Court London	Park / Open Space	Monday to Sunday; 00:00 - 00:00
19/12271/LIPCH	Rosas	23A Ganton Street London W1F 9BW	Cafe	Sunday; 12:00 - 23:00   Monday to Thursday; 10:00 - 23:30   Friday to Saturday; 10:00 - 00:00   Christmas Eve; 10:00 - 00:00   Sundays before Bank Holidays; 12:00 - 00:00   Christmas Eve; 12:00 - 00:00
19/16795/LIPVM	Dehesa	17 Kingly Street London W1B 5PU	Restaurant	Monday; 10:00 - 00:00   Tuesday; 10:00 - 00:00   Wednesday; 10:00 - 00:00   Thursday; 10:00 - 00:00   Friday; 10:00 - 00:30   Saturday; 10:00 - 00:30   Sunday; 12:00 - 23:00   Monday to Thursday; 10:00 - 00:00   Friday to Saturday; 10:00 - 00:30
17/09470/LIPV	Pastaio	19 Ganton Street London W1F 9BN	Restaurant	Sunday; 12:00 - 23:00   Monday to Thursday; 10:00 - 00:00   Friday to Saturday; 10:00 - 00:30
18/07664/LIPDPS	Cirque Le Soir	Basement 15-21 Ganton Street London W1F 9BN	Night clubs and discos	Monday; 00:00 - 00:00   Wednesday to Saturday; 00:00 - 00:00
22/12065/LIPVM	Cirque Le Soir	Basement 15-21 Ganton	Night clubs and discos	Monday; 00:00 - 00:00   Wednesday;



		Street London W1F 9BN		00:00 - 00:00   Thursday; 00:00 - 00:00   Friday; 00:00 - 00:00   Saturday; 00:00 - 00:00   Wednesday to Saturday; 00:00 - 00:00
23/02309/LIPDPS	Disrepute	Basement And Ground Floor 4 Kingly Court London W1B 5PW	Night clubs and discos	Sunday; 09:00 - 01:00   Monday to Saturday; 09:00 - 03:30   Sundays before Bank Holidays; 09:00 - 01:30
23/04406/LIPDPS	El Pollote	13 Ganton Street London W1F 9BL	Cafe	Sunday; 12:00 - 22:30   Monday to Thursday; 10:00 - 23:30   Friday to Saturday; 10:00 - 00:00
06/06301/WCCMAP	Myung Ga Restaurant	15 Beak Street London W1F 9SX	Cafe	Sunday; 12:00 - 00:00   Monday to Saturday; 10:00 - 00:30
23/01912/LIPCH	Flat Iron	17 Beak Street London W1F 9RW	Restaurant	Sunday; 12:00 - 23:00   Monday to Thursday; 10:00 - 00:00   Friday to Saturday; 10:00 - 00:30
23/00964/LIPCHT	Kroketa	21 Beak Street London W1F 9RR	Cafe	Sunday; 09:00 - 23:00   Monday to Thursday; 09:00 - 00:00   Friday to Saturday; 09:00 - 00:30
23/05192/LIPDPS	Blue Posts Public House	18 Kingly Street London W1B 5PX	Public house or pub restaurant	Sunday; 08:00 - 23:00   Monday to Thursday; 08:00 - 23:30   Friday to Saturday; 08:00 - 00:00   Sundays



				before Bank Holidays; 08:00 - 00:00
22/11500/LIPDPS	Soho Grind	Basement And Ground Floor 19 Beak Street London W1F 9RP	Restaurant	Sunday; 12:00 - 22:30   Monday to Thursday; 10:00 - 23:30   Friday to Saturday; 10:00 - 00:00
14/03870/LIPT	Mother Mash	26 Ganton Street London W1F 7QZ	Public house or pub restaurant	Monday to Friday; 08:00 - 23:00   Saturday to Sunday; 10:00 - 23:00
23/02692/LIPDPS	Pix	Basement And Ground Floor 24 Ganton Street London W1F 7QY	Restaurant	Sunday; 12:00 - 22:30   Monday to Thursday; 12:00 - 23:30   Friday to Saturday; 12:00 - 00:00
22/01668/LIPDPS	The Ganton Arms	18 - 20 Ganton Street London W1F 7BX	Restaurant	Sunday; 12:00 - 00:00   Monday to Friday; 10:00 - 00:30
21/03716/LIPVM	Crispin	19 Kingly Street London W1B 5PY	Restaurant	Sunday; 10:00 - 22:30   Monday to Thursday; 08:00 - 23:30   Friday to Saturday; 08:00 - 00:00
14/11059/LIPVM	Zebrano	14-22 Ganton Street London W1F 7QU	Pub or pub restaurant with lodge	Sunday; 12:00 - 22:30   Sunday; 12:00 - 00:00   Monday to Wednesday; 09:00 - 00:00   Monday to Thursday; 10:00 - 23:30   Thursday to Saturday; 09:00 - 01:00   Friday to Saturday; 10:00 - 00:00   Sundays before Bank Holidays;



				12:00 - 00:00
21/02690/LIPDPS	Flare	14 - 22 Ganton Street London W1F 7BS	Public house or pub restaurant	Sunday; 12:00 - 22:30   Sunday; 12:00 - 23:30   Monday to Wednesday; 09:00 - 00:00   Monday to Thursday; 10:00 - 23:30   Thursday to Saturday; 09:00 - 01:00   Friday to Saturday; 10:00 - 00:00   Sundays before Bank Holidays; 12:00 - 00:00
20/07653/LIPDPS	Aint Nothin But	20 Kingly Street London W1B 5PZ	Wine bar	Sunday; 09:00 - 00:00   Monday to Thursday; 09:00 - 01:30   Friday to Saturday; 09:00 - 03:30   Sundays before Bank Holidays; 09:00 - 01:30
17/14852/LIPN	Sweaty Betty	1 - 2 Carnaby Street London W1F 9QG	Shop	Monday to Sunday; 08:00 - 20:00
21/03365/LIPDPS	Kolamba	21 Kingly Street London W1B 5QA	Restaurant	Sunday; 10:00 - 23:00   Monday to Thursday; 10:00 - 00:00   Friday to Saturday; 10:00 - 00:30   Sundays before Bank Holidays; 10:00 - 00:30
17/08811/LIPN	Smeg St James's	Regent Street London	Shop	Sunday; 12:00 - 18:00   Monday to Saturday; 10:00 - 19:00



19/11048/LIPDPS	Regent Street Area	Regent Street London	Park / Open Space	Monday to Sunday; 00:00 - 00:00
-----------------	--------------------	----------------------	-------------------	---------------------------------